

Topography Map

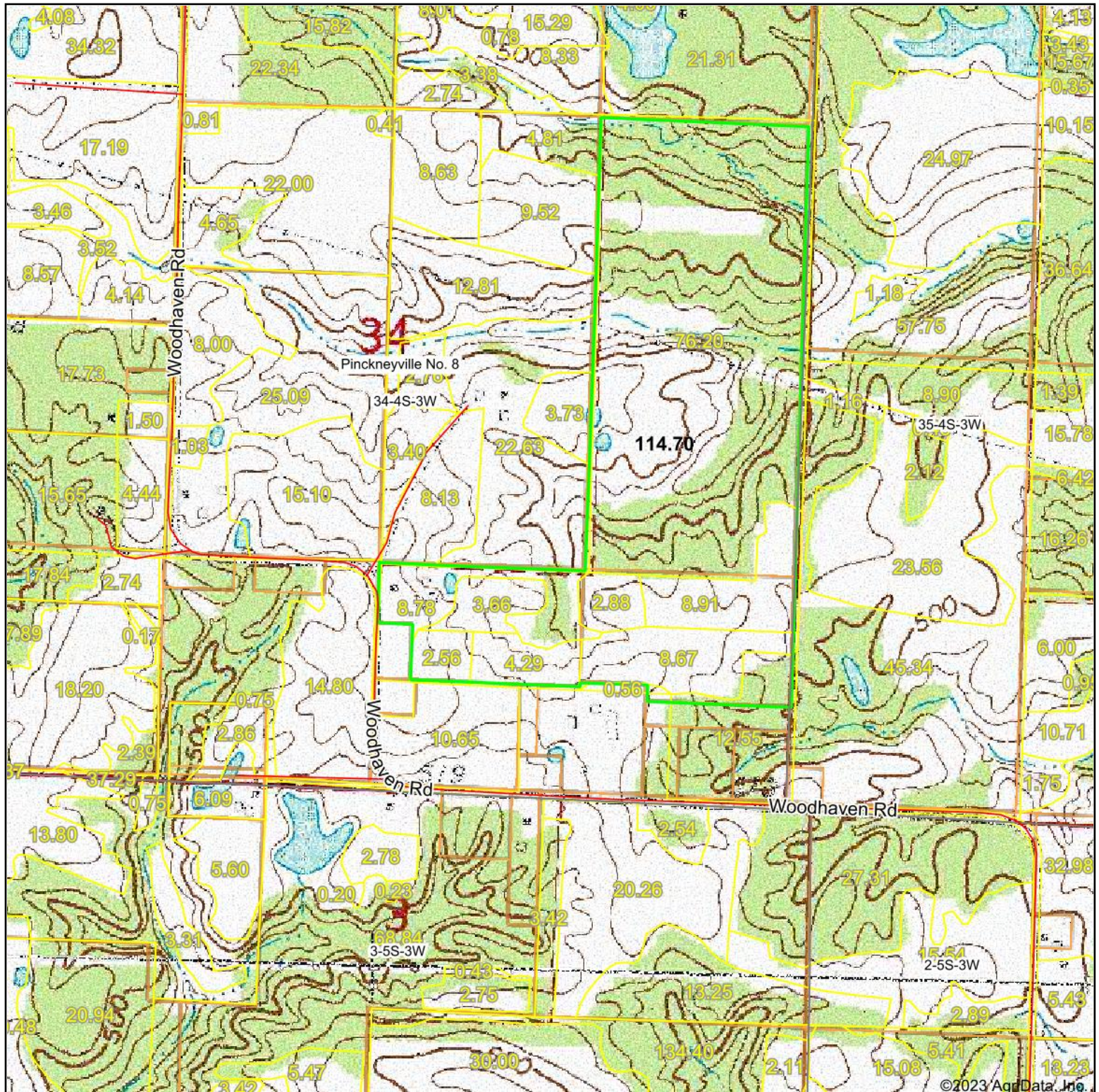

map center: 38° 7' 54.83, -89° 24' 47.86

0ft 921ft 1843ft



Maps Provided By:



© AgriData, Inc. 2023

www.AgrIDataInc.com

34-4S-3W
Perry County
Illinois



6/7/2023

Field borders provided by Farm Service Agency as of 5/21/2008.