

**J. DIMPKINS SURVEY
ABSTRACT NO. 162**

**SECTION NO. 19
T. & P. RR. CO. SURVEY
BLOCK 'A', E.D.B.
ABSTRACT NO. 704**

V. HENDERSON
N 1/2 OF 350 ACRES
V. 1267, P. 107

(177649 ACRES)

S 88°54'46" E 5546.79'

LINE	BEARING	DISTANCE
L1	S 01°37'48" W	368.74'
L2	S 02°20'42" W	153.44'
L3	S 28°30'02" W	66.52'
L4	S 47°14'14" W	215.24'
L5	S 40°06'11" W	231.72'
L6	S 33°40'20" W	367.28'
L7	S 23°52'00" W	192.08'

BLUELINE DATA CORP.
172272 ACRES
V. 1455, P. 365

172175 ACRES

J.P. WHARTON
REM. OF 14365 ACRES
OF 1129, P. 535

**A. WILLIAMS SURVEY
ABSTRACT NO. 886**

NOTE: EASEMENTS ADDRESSED ARE ONLY THOSE LISTED IN COMMITMENT NO. SEWELL9666-NM FROM FIRST NATIONAL TITLE INSURANCE COMPANY WITH AN ISSUED DATE OF NOVEMBER 9, 2015

SUBJECT TO:

THE TEXAS COMPANY
V. 70, P. 519 (AND DESC.)
CONSUMER GAS & FUEL CO.
V. 100, P. 120 (AND DESC.)

T.P. & L. CO.
V. 208, P. 538 (SHOWN)
V. 248, P. 47 (SHOWN)
LONE STAR GAS CO.
V. 292, P. 419 (SHOWN)
DIVERSE, INC.
V. 575, P. 234 (AND DESC.)
NATURAL GAS PIPELINE
COMPANY OF AMERICA
V. 590, P. 328 (AND DESC.)

PLAT OF SURVEY AND IMPROVEMENTS

OF A 172175 ACRES TRACT OF LAND OUT OF SECTION NO. 19, T. & P. RR. CO. SURVEY, BLOCK 'A', E.D.B., ABSTRACT NO. 704 AND THE A. WILLIAMS SURVEY, ABSTRACT NO. 885, BOTH IN PALO PINTO COUNTY, TEXAS

SURVEYED ON THE GROUND: NOVEMBER 11, 2015
UPDATED TO ADDRESS SCHEDULE B: NOVEMBER 25, 2015

PHILIP E. COLVIN, JR., R.P.L.S. NO. 6258
PRICE SURVEYING, L.P., FIRM #10034200
213 S DAK AVE., MINERAL WELLS, TX 76067
940-325-4841 JN15745 15745A.QWG FNS1127



BEARING BASIS:
TEXAS STATE PLANE COORDINATE SYSTEM, NAD83
NORTH CENTRAL TX ZONE, US SURVEY FOOT
NOTE: ALL DISTANCES ARE SURFACE DISTANCES
NOTE: THIS TRACT IS NOT IN A FLOOD ZONE
ACCORDING TO FIRM MAP NO. 483630A75E,
DATED AUGUST 2, 2012
NOTE: ALL CORNERS ALONG DOBBS VALLEY ROAD
ARE POINTS UNLESS OTHERWISE NOTED
NOTE: STOCK TANKS ARE DEPICTED FROM AERIAL IMAGES AND
ARE PROVIDED FOR INFORMATIONAL PURPOSES ONLY. SURVEYOR
MAKES NO CERTIFICATION AS TO EXACT SIZE AND LOCATION.

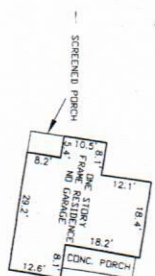

SCALE - 1" = 30 FEET

