

**Date: 01/09/2021**

**Crest Natural Resources, LLC. Tract Details**

**Tract Reference # 105-01**

**Acres: 1.5± Acres**

**Asking Price: \$27,691.00**

**Location: Proceed south from Pineville, La via Hwy 107 Right on LA Hwy. 454, 2.1 miles, Left on Newsome Rd., .5 miles tract on right.**

**Restrictions: Single family residence consisting of new construction or manufactured housing less than 5 years old.**

**Attributes: Electricity and water are both available on Newsome road. Approximately 700' of road frontage. (BUYER RESPONSIBLE FOR DETERMINATION OF FLOOD ZONE)**

**Minerals:**

**Seller reserves 100% interest in all of the oil, gas, casing head gas and other hydrocarbon minerals occurring naturally in liquid or gaseous state as may be owned by Seller at this time in, and under that may be produced from the property, it is the intention of Seller that this reservation cover and include fugacious minerals only and the Buyer is to receive all other minerals of every nature, description and kind, including but not limited to coal, lignite, sulphur, bauxite, sand gravel, etc.**

**Inspections: All inspections must be scheduled with Crest Natural Resources, LLC., prior to entry by a potential buyer. A Temporary Access Agreement must be signed and returned to Crest Natural Resources, LLC. prior to entry for inspection purposes. This Temporary Access Agreement must be with you during inspections.**

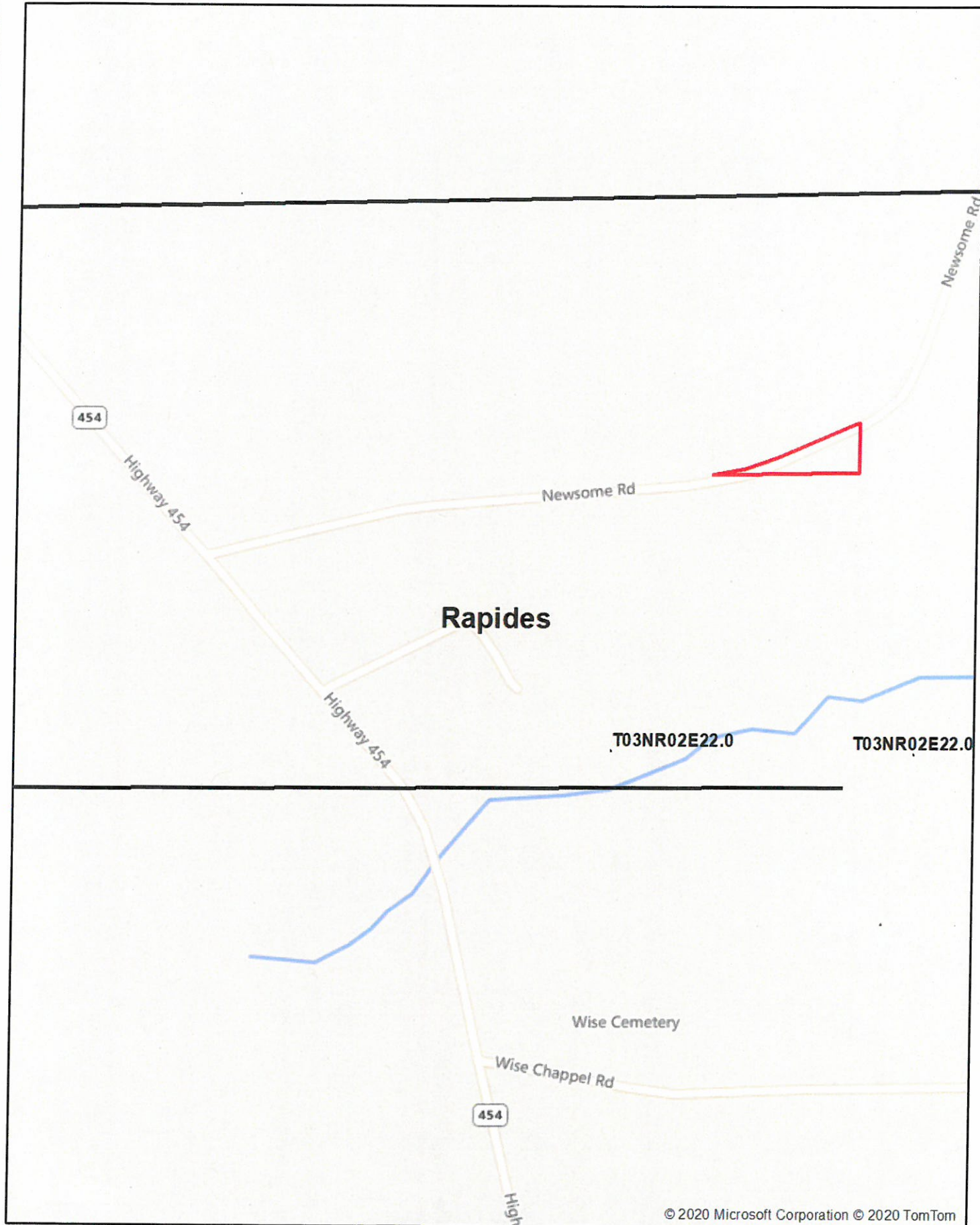

**Crest Natural Resources, LLC**

CNR Tract 105-01  
1.49± Acres  
Rapides Parish, LA

© 2020 Microsoft Corporation © 2020 TomTom

12/21/2020





**Crest Natural Resources, LLC**

CNR Tract 105-01  
1.49± Acres  
Rapides Parish, LA

12/21/2020



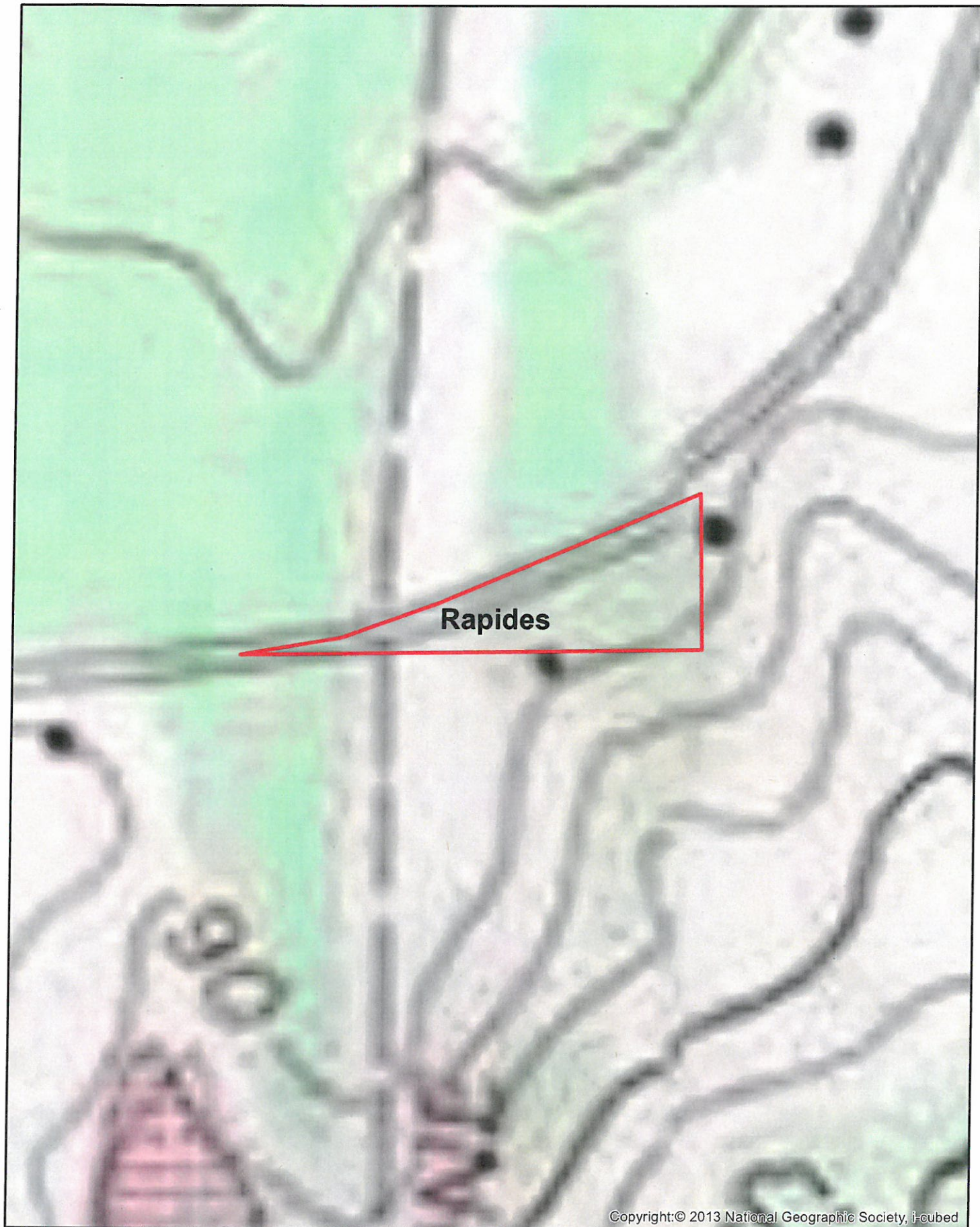

Copyright:© 2013 National Geographic Society, i-cubed

**Crest Natural Resources, LLC**



CNR Tract 105-01  
1.49± Acres  
Rapides Parish, LA

12/21/2020











