

Soils Map

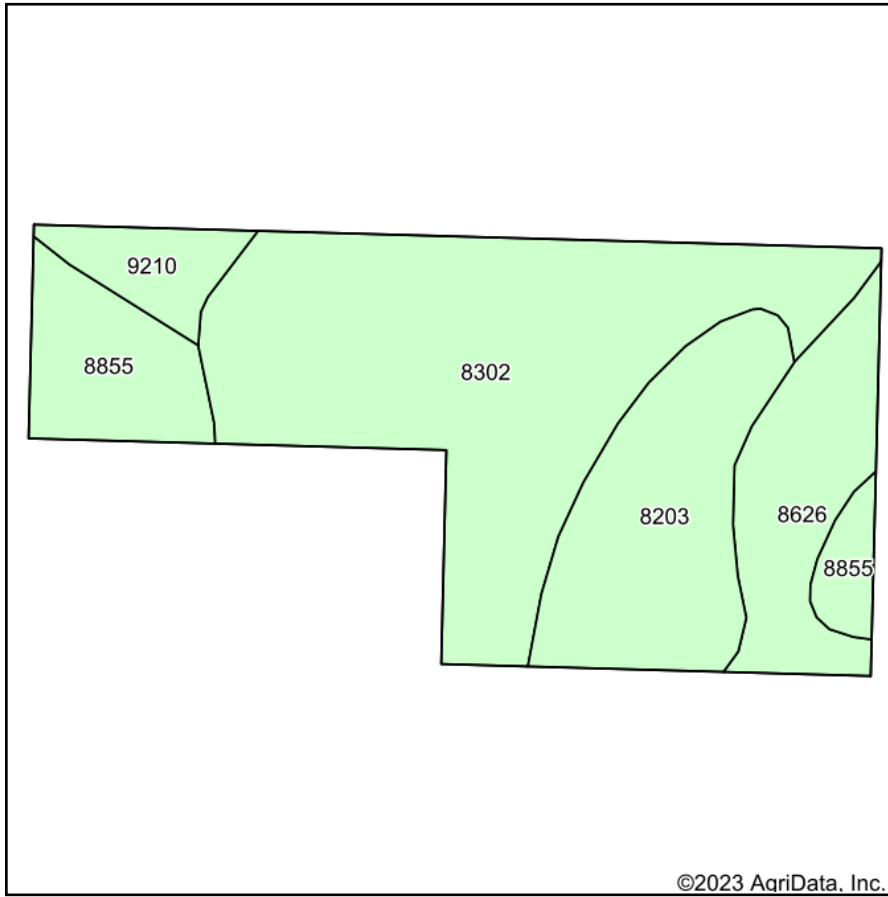

Soils data provided by USDA and NRCS.

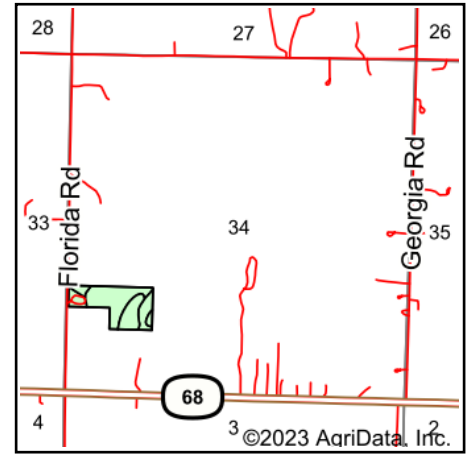

State: **Kansas**
 County: **Franklin**
 Location: **34-16S-18E**
 Township: **Centropolis**
 Acres: **14.86**
 Date: **8/2/2023**



Maps Provided By:



Area Symbol: KS059, Soil Area Version: 22

Code	Soil Description	Acres	Percent of field	Non-Irr Class *c	Range Production (lbs/acre/yr)	Common bermudagrass AUM	Corn Bu	Grain sorghum Bu	Grass legume hay Tons	Oats Bu	Soybeans Bu	Tall fescue AUM	Winter wheat Bu	*n NCCPI Soybeans
8302	Verdigris silt loam, 0 to 1 percent slopes, occasionally flooded	7.28	49.0%	IIw	7758									75
8203	Osage silty clay, 0 to 1 percent slopes, occasionally flooded	3.03	20.4%	IIIw	7199									43
8626	Bates-Collinsville complex, 3 to 7 percent slopes	2.02	13.6%	IVe	4257									36
8855	Olpe-Kenoma complex, 1 to 3 percent slopes	1.80	12.1%	IVe	4515									50
9210	Bolivar-Hector loams, 2 to 5 percent slopes	0.73	4.9%	IVe	3275	1	39	40	2	9	18	5	26	41
Weighted Average				2.82	6555.1	*	1.9	2	0.1	0.4	0.9	0.2	1.3	*n 58.5

*n: The aggregation method is "Weighted Average using all components"

*c: Using Capabilities Class Dominant Condition Aggregation Method

Soils data provided by USDA and NRCS.