

## **BUILDING SKETCH & AREA CALCULATIONS**

From an old appraisal not prepared by the Real Estate Brokerage and provided SOLELY as a subject to verification by user.

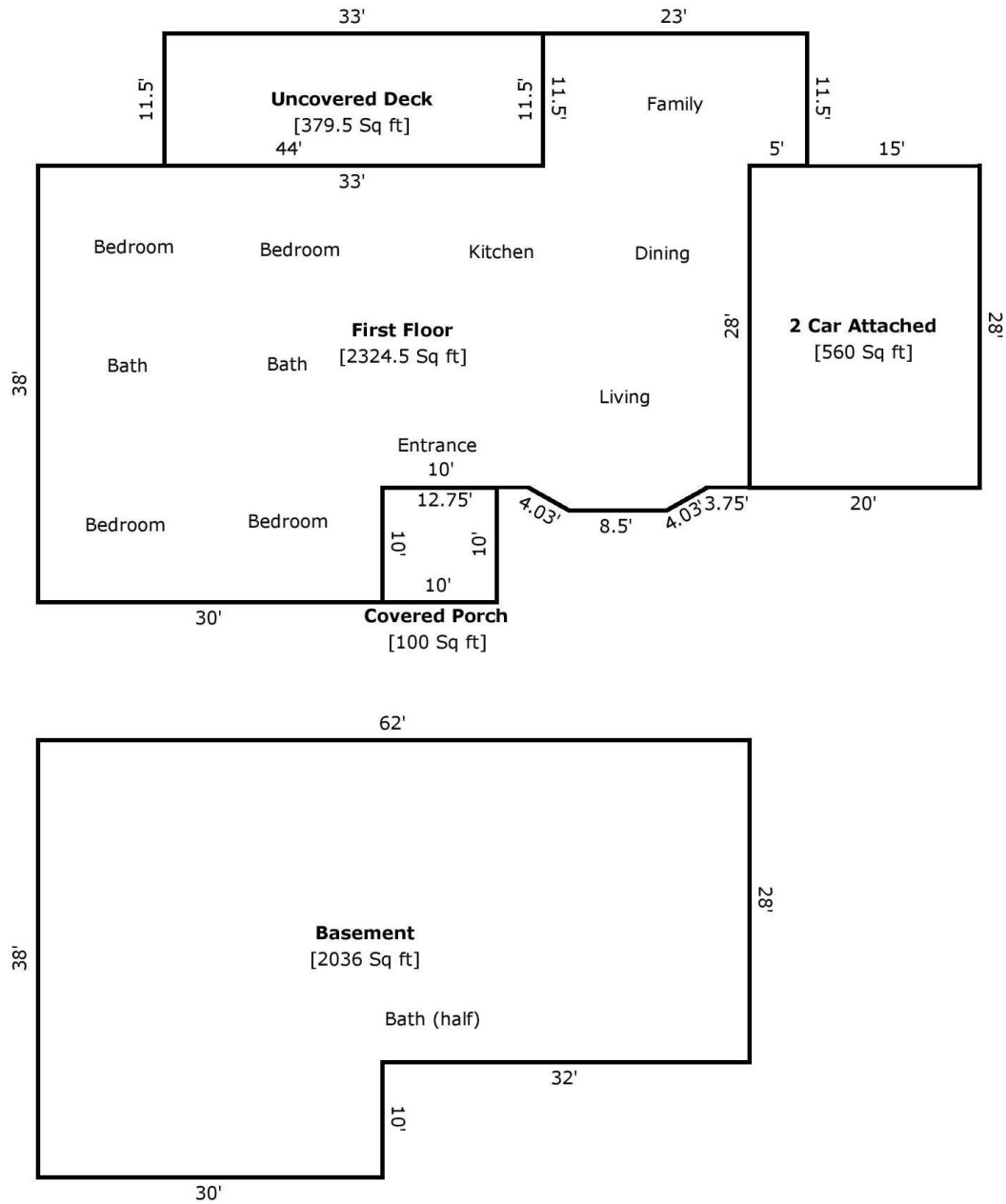

TOTAL Sketch by a la mode, Inc.

### Area Calculations Summary

Living Area		Calculation Details	
First Floor	2324.5 Sq ft	$23 \times 11.5 = 264.5$	
		$0.5 \times 3.5 \times 2 = 3.5$	
		$0.5 \times 2 \times 3.5 = 3.5$	
		$8.5 \times 2 = 17$	
		$28 \times 32 = 896$	
		$38 \times 30 = 1140$	
<b>Total Living Area (Rounded):</b>	<b>2325 Sq ft</b>		
Non-living Area			
2 Car Attached	560 Sq ft	$28 \times 20 = 560$	
Covered Porch	100 Sq ft	$10 \times 10 = 100$	
Uncovered Deck	379.5 Sq ft	$33 \times 11.5 = 379.5$	
Basement	2036 Sq ft	$28 \times 32 = 896$	
		$38 \times 30 = 1140$	