

PLSS Legal Description

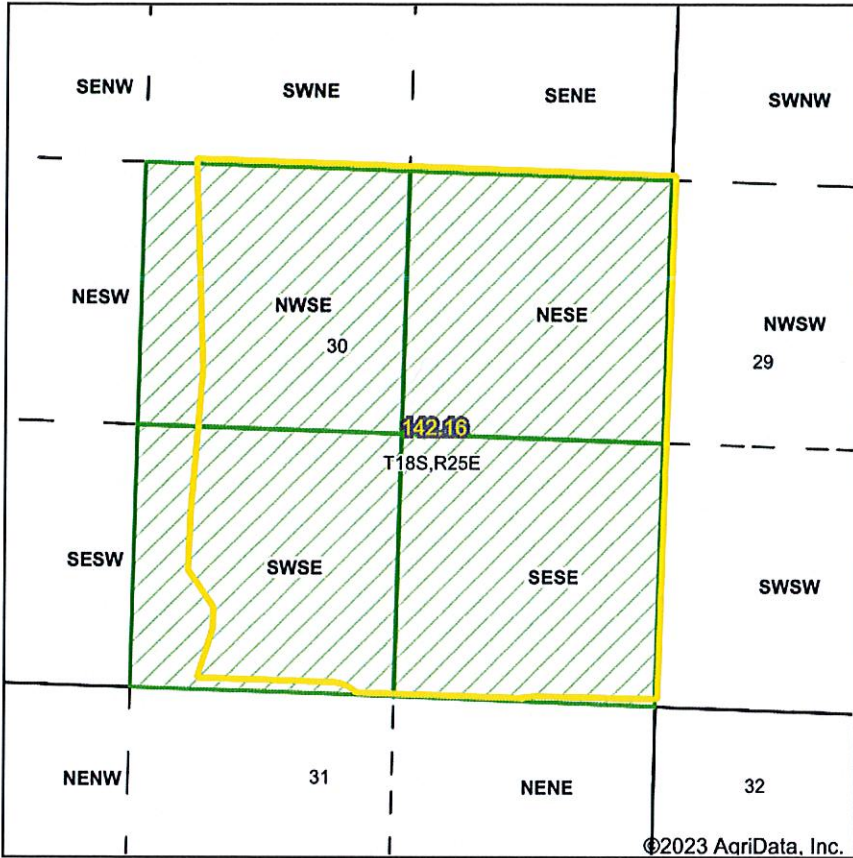

Map Center: 38° 27' 3.44, -94° 40' 52.9

0ft 2556ft 5112ft

©2023 AgriData, Inc.



Acres: 142.16
 Date: 8/16/2023
 Township: Sugar Creek
 County: Miami
 State: Kansas



Maps Provided By:
surety
 CUSTOMIZED ONLINE MAPPING
 © AgriData, Inc. 2023 www.AgriDataInc.com



PLSS Source: Various State Sources

PLSS Note: No Government Lots. Quarters created by equally splitting the sections

Short Legal:

PT NWSE; E2SE; PT SWSE 30-18S-25E

Long Legal:

PART OF THE NW1/4 SE1/4; E1/2 SE1/4; PART OF THE SW1/4 SE1/4 OF SECTION 30, TOWNSHIP 18 SOUTH, 25 EAST, MIAMI COUNTY, KANSAS