

Soils Map

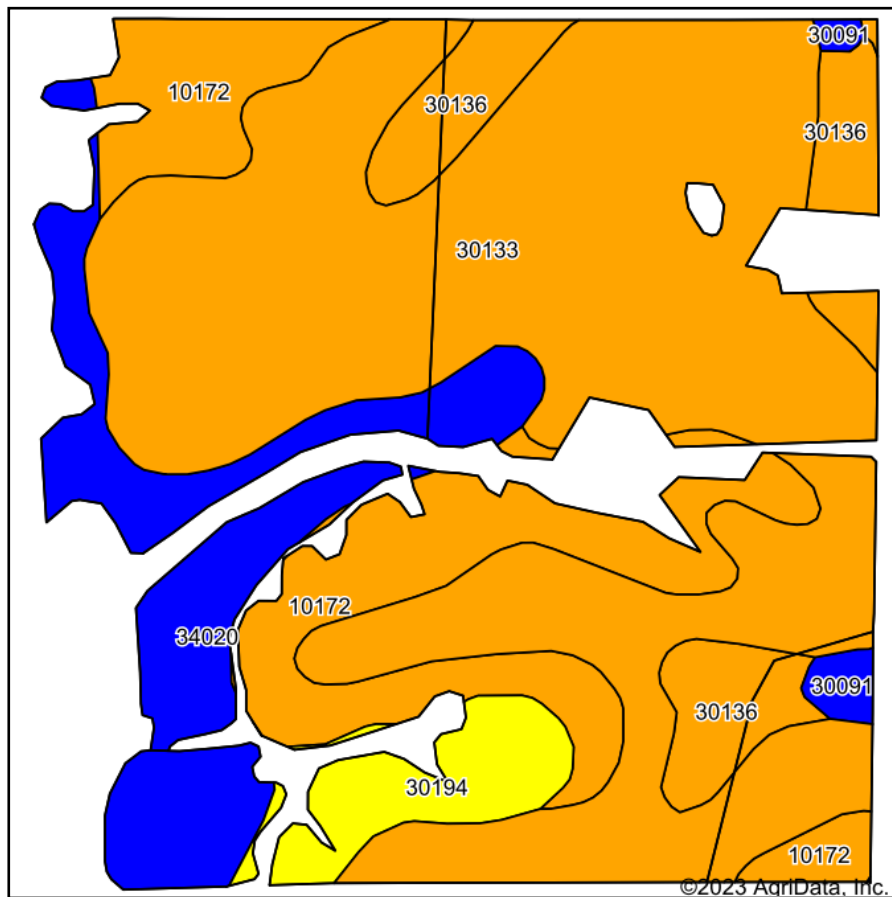

Soils data provided by USDA and NRCS.

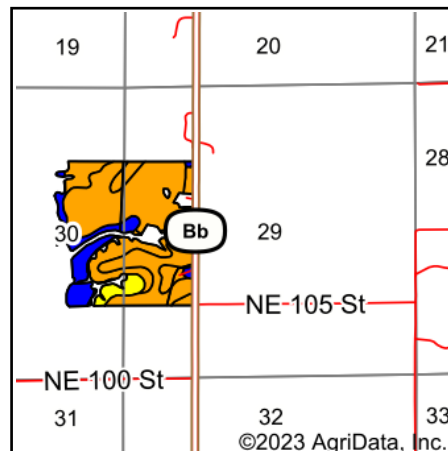

State: **Missouri**
 County: **Grundy**
 Location: **30-63N-22W**
 Township: **Myers**
 Acres: **130.42**
 Date: **9/14/2023**



Maps Provided By:



© AgriData, Inc. 2023

www.AgriDataInc.com



Area Symbol: MO079, Soil Area Version: 26

Code	Soil Description	Acres	Percent of field	Non-Irr Class Legend	Non-Irr Class *c	Alfalfa hay Tons	Caucasian bluestem Tons	Common bermudagrass Tons	Orchardgrass red clover Tons	Tall fescue Tons	Warm season grasses Tons	*n NCCPI Overall	*n NCCPI Corn	*n NCCPI Small Grains	*n NC Soybean
30133	Lamoni clay loam, 5 to 9 percent slopes, eroded	73.79	56.6%		IIIe							58	58	52	
10172	Shelby clay loam, 9 to 14 percent slopes, moderately eroded	21.93	16.8%		IIIe							68	68	55	
34020	Colo silty clay loam, drainageway, 2 to 5 percent slopes, frequently flooded	17.60	13.5%		IIlw							78	78	60	
30136	Lamoni loam, 5 to 9 percent slopes	9.96	7.6%		IIIe	5	8	7	8	7	8	62	56	61	
30194	Shelby clay loam, 14 to 18 percent slopes, moderately eroded	5.95	4.6%		IVe							64	64	52	
30091	Grundy silty clay loam, 2 to 5 percent slopes, moderately eroded	1.19	0.9%		Ile							73	73	62	
Weighted Average					2.90	0.4	0.6	0.5	0.6	0.5	0.6	*n 63.1	*n 62.6	*n 54.4	*

*n: The aggregation method is "Weighted Average using all components"

*c: Using Capabilities Class Dominant Condition Aggregation Method

Soils data provided by USDA and NRCS.