

Stand Map
Driftwood Beach 30
Parcel # 41041Hb1016
 Lincoln County, OR - approx. 29.0 acres +/-

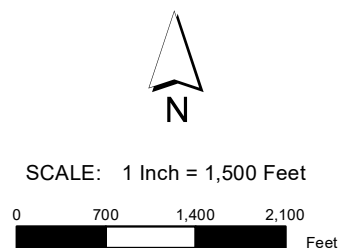
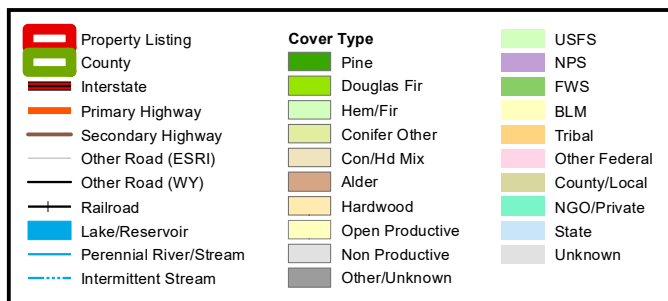

Stand #	Cover Type	Age	Acres
243	Conifer Other	40	28.6

Smaller stands have been excluded to fit in the allowable space

The property depicted on this map has not been surveyed. The acreage is an estimate based upon GIS data. The volume information in this report is based on current information in the seller's inventory system. The information is subject to change due to harvest activities and/or updates resulting from routine maintenance of the inventory system. Neither the owner nor its officers, directors, employees or agents represent or warrant the accuracy or completeness of the ownership acreage, the cover type acreage, timber inventory species, grade or volumes, legal or practical access to the property, or operability.

8/21/2023

Driftwood Beach Timber Stand Data													
StandNumber	Parcel Acres	Establish Date	Age		Cover Type	Origin	RMZ	TotalTPA	TotalBA	Total MBF/ac	MBF/ac- DF	MBF/ac- WW	MBF/ac- Cedar
243	28.57	1/1/1984	40		Western Hemlock	Planted		1419.02	248.5	10.6	4.3	4.8	1.5

Neither Seller nor Made Out West Land Company guarantee the accuracy of the data contained in this report. Buyer to do their own due diligence.