

Soils Map

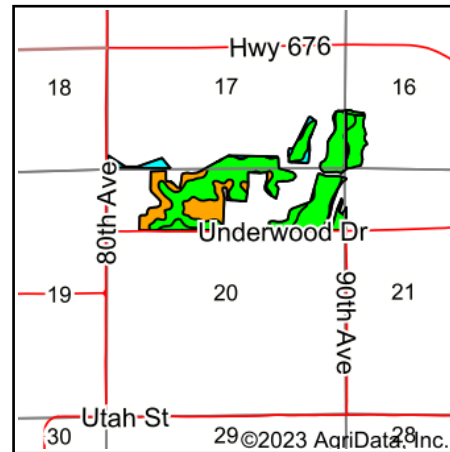

State: **Iowa**
 County: **Marion**
 Location: **20-74N-20W**
 Township: **Washington**
 Acres: **120.78**
 Date: **9/18/2023**

Hawkeye Farm Mgmt & Real Estate

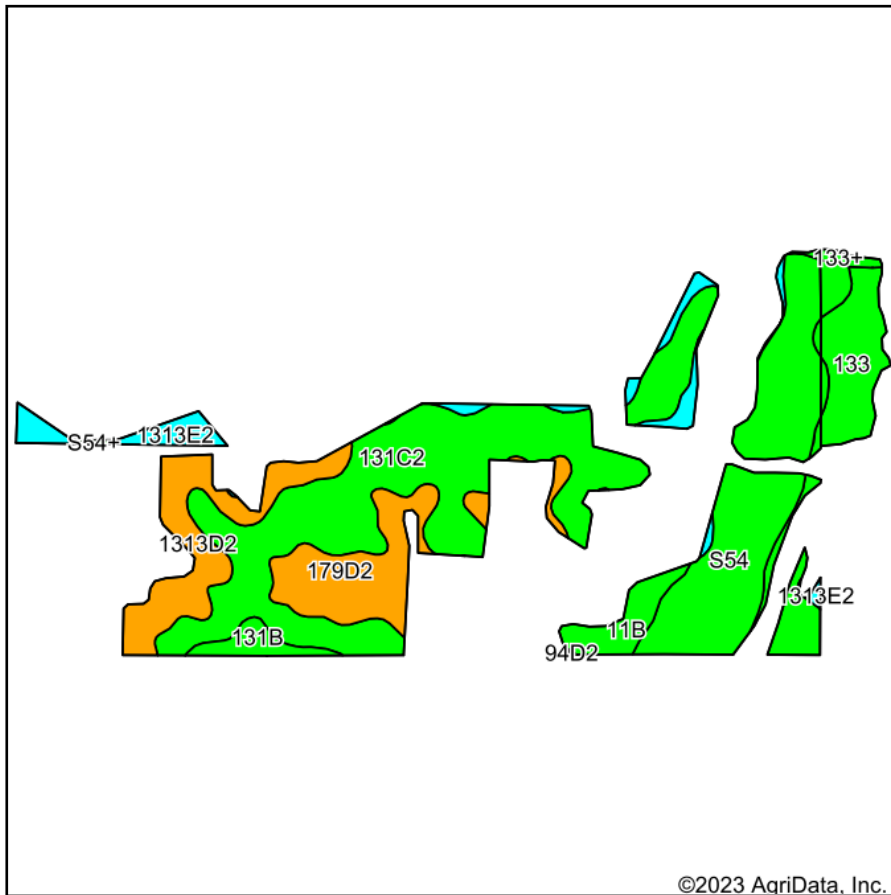

22 N Main, Albia IA Phone: 641-932-7796
 Email: hawkeye@uciowa.com
 On the web: www.uciowa.com
 www.iowawhitetailfarms.com

Maps Provided By:



© AgriData, Inc. 2023

www.AgriDataInc.com



Soils data provided by USDA and NRCS.

Area Symbol: IA125, Soil Area Version: 32

| Code | Soil Description | Acres | Percent of field | CSR2 Legend | Non-Irr Class *c | CSR2** | CSR | *n NCCPI Corn | *n NCCPI Soybeans | |
|-------------------------|---|-------|------------------|-------------|------------------|-------------|-------------|---------------|-------------------|----------------|
| 131C2 | Pershing silt loam, 5 to 9 percent slopes, moderately eroded | 44.90 | 37.2% | | IIIe | 62 | 49 | 68 | 51 | |
| S54 | Zook silty clay loam, heavy till, 0 to 2 percent slopes, occasionally flooded | 26.59 | 22.0% | | IIw | 68 | | 74 | 68 | |
| 179D2 | Gara loam, 9 to 14 percent slopes, moderately eroded | 12.30 | 10.2% | | IVe | 38 | 43 | 67 | 48 | |
| 133 | Colo silty clay loam, deep loess, 0 to 2 percent slopes, occasionally flooded | 11.96 | 9.9% | | IIw | 78 | 80 | 75 | 80 | |
| 1313D2 | Munterville silt loam, 9 to 14 percent slopes, moderately eroded | 11.52 | 9.5% | | VIe | 34 | 10 | 59 | 42 | |
| 1313E2 | Munterville silt loam, 14 to 18 percent slopes, moderately eroded | 6.53 | 5.4% | | VIe | 22 | 5 | 56 | 39 | |
| 11B | Colo-Ely silty clay loams, 2 to 5 percent slopes | 3.83 | 3.2% | | IIe | 81 | 65 | 84 | 79 | |
| 131B | Pershing silt loam, 2 to 5 percent slopes | 2.30 | 1.9% | | IIIe | 70 | 72 | 74 | 59 | |
| 133+ | Colo silt loam, deep loess, 0 to 2 percent slopes, overwash, occasionally flooded | 0.72 | 0.6% | | IIw | 78 | 80 | 81 | 85 | |
| S54+ | Zook silt loam, heavy till, 0 to 2 percent slopes, occasionally flooded, overwash | 0.13 | 0.1% | | IIw | 68 | | 66 | 73 | |
| Weighted Average | | | | | | 3.19 | 58.5 | *- | *n 69.1 | *n 57.1 |

**IA has updated the CSR values for each county to CSR2.

*- CSR weighted average cannot be calculated on the current soils data, use prior data version for csr values.

*n: The aggregation method is "Weighted Average using all components"

*c: Using Capabilities Class Dominant Condition Aggregation Method

Soils data provided by USDA and NRCS.