

# Soils Map

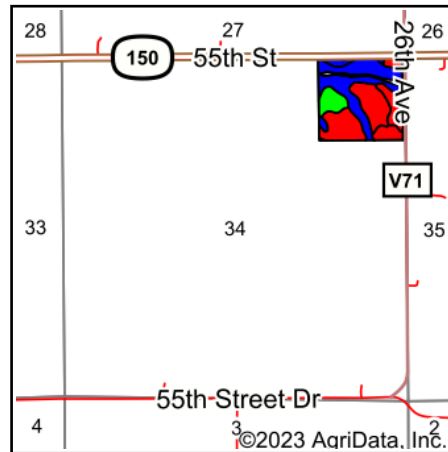

State: **Iowa**  
 County: **Benton**  
 Location: **34-86N-10W**  
 Township: **Harrison**  
 Acres: **36.46**  
 Date: **9/22/2023**

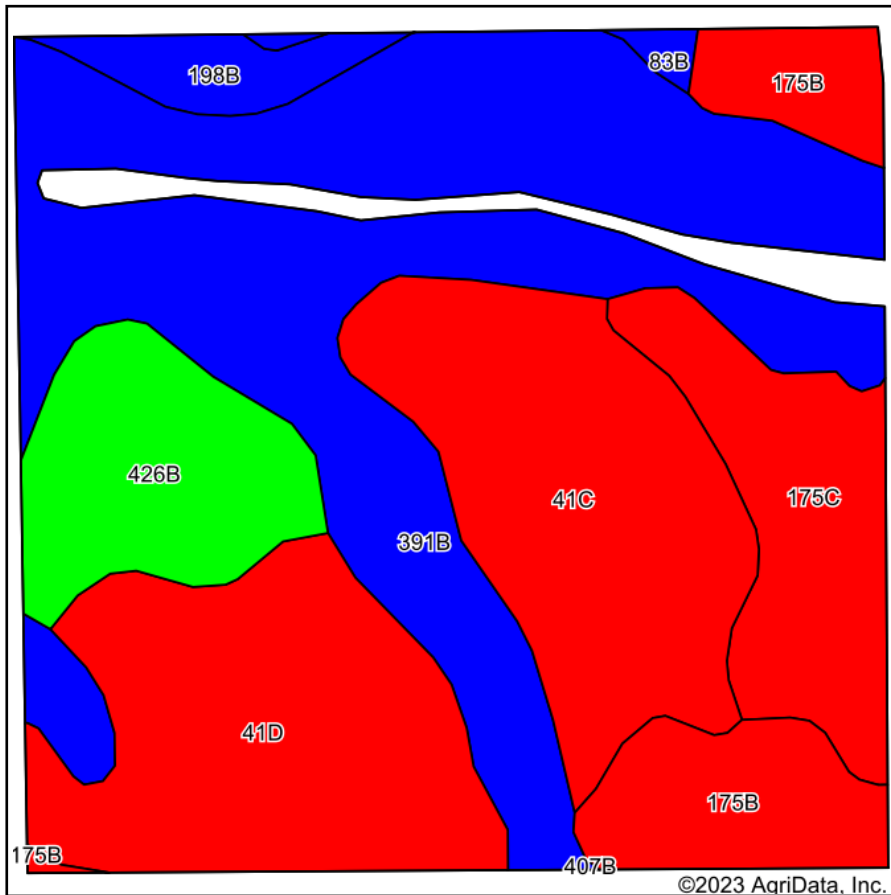







Maps Provided By:  
  
 CUSTOMIZED ONLINE MAPPING  
 © AgriData, Inc. 2023 [www.AgriDataInc.com](http://www.AgriDataInc.com)

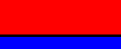

Soils data provided by USDA and NRCS.

Area Symbol: IA011, Soil Area Version: 25

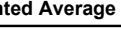
Code	Soil Description	Acres	Percent of field	CSR2 Legend	Non-Irr Class *c	Irr Class *c	*i Corn Bu	*i Soybeans Bu	CSR2**	CSR	*n NCCPI Soybeans		
391B	Clyde-Floyd complex, 1 to 4 percent slopes	13.50	37.0%		IIw		216.0	62.6	87	74	86		
41C	Sparta loamy fine sand, 5 to 9 percent slopes	6.13	16.8%		IVs	Ile	124.8	36.2	34	25	30		
41D	Sparta loamy fine sand, 9 to 14 percent slopes	6.04	16.6%		VIIs		105.6	30.6	8	15	28		
175C	Dickinson fine sandy loam, 5 to 9 percent slopes	3.39	9.3%		IIIe		80.0	23.2	45	40	36		
426B	Aredale loam, 2 to 5 percent slopes	3.17	8.7%			Ile	225.6	65.4	91	85	75		
175B	Dickinson fine sandy loam, 2 to 5 percent slopes	3.10	8.5%			IIIe	80.0	23.2	50	55	36		
198B	Floyd loam, 1 to 4 percent slopes	0.93	2.6%			IIw	222.4	64.5	89	77	88		
83B	Kenyon loam, 2 to 5 percent slopes	0.20	0.5%			Ile	225.6	65.4	90	87	71		
<b>Weighted Average</b>							<b>3.18</b>	<b>*-</b>	<b>159.2</b>	<b>46.2</b>	<b>58.4</b>	<b>52.3</b>	<b>*n 57.1</b>

\*\*IA has updated the CSR values for each county to CSR2.

\*i Yield data provided by the ISPAID Database version 8.1.1 developed by IA State University.

\*n: The aggregation method is "Weighted Average using all components"

\*c: Using Capabilities Class Dominant Condition Aggregation Method

\*- Irr Class weighted average cannot be calculated on the current soils data due to missing data.

Soils data provided by USDA and NRCS.