

Total Soils Map

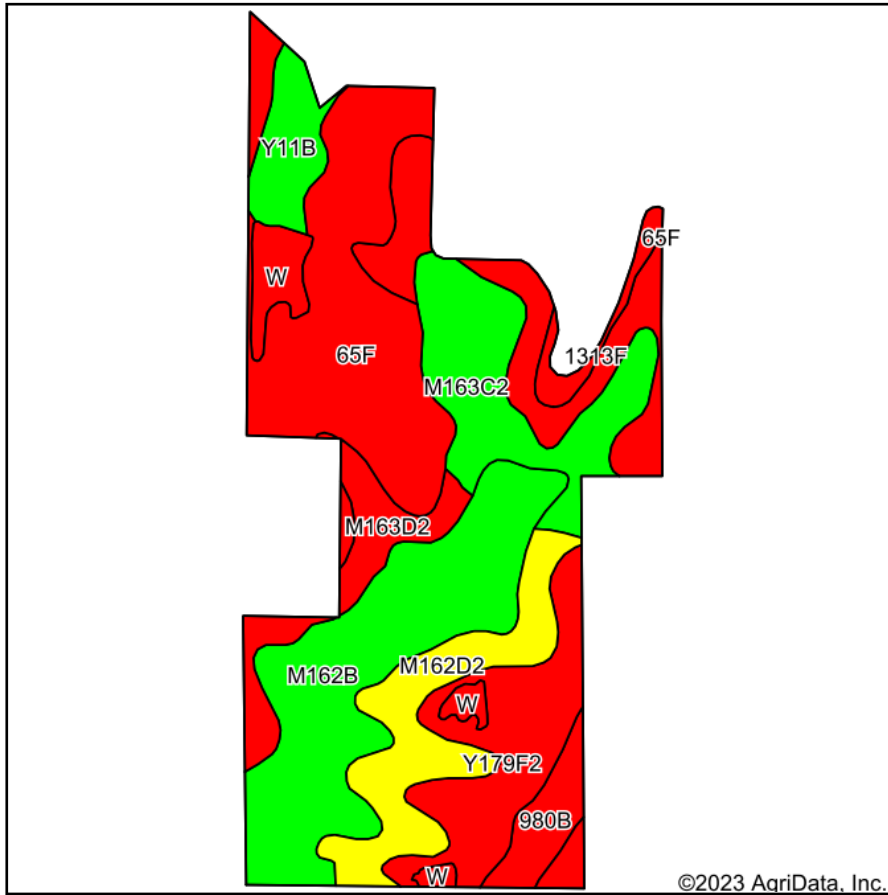

Soils data provided by USDA and NRCS.

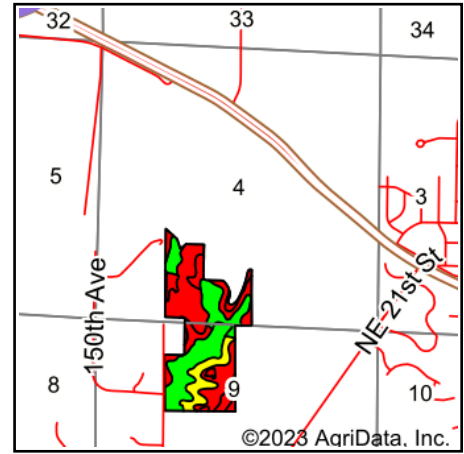

State: **Iowa**
 County: **Warren**
 Location: **4-77N-23W**
 Township: **Allen**
 Acres: **85.26**
 Date: **10/16/2023**

PC PEOPLES
 COMPANY
 INTEGRATED LAND SOLUTIONS

Maps Provided By:

surety
 CUSTOMIZED ONLINE MAPPING
 © AgriData, Inc. 2023 www.AgriDataInc.com



Area Symbol: IA181, Soil Area Version: 28

Code	Soil Description	Acres	Percent of field	CSR2 Legend	Non-Irr Class *c	CSR2**	CSR	Bromegrass alfalfa AUM	Corn Bu	Oats Bu	Soybeans Bu	*n NCCPI Overall	*n NCCPI Corn	*n NCCPI Small Grains	*n NCCPI Soybeans
65F	Lindley loam, 18 to 25 percent slopes	17.87	21.0%		Vlle	14	10					58	58	36	41
M162B	Downs silt loam, till plain, 2 to 5 percent slopes	17.42	20.4%		Ile	90						92	92	75	80
M163D2	Fayette silt loam, till plain, 9 to 14 percent slopes, eroded	12.23	14.3%		Ille	47						76	76	63	62
M163C2	Fayette silt loam, till plain, 5 to 9 percent slopes, eroded	9.67	11.3%		Ille	76		1	9	4	3	82	82	68	69
Y179F2	Gara loam, dissected till plain, 18 to 25 percent slopes, eroded	9.39	11.0%		Vlle	16						55	55	35	36
M162D2	Downs silt loam, till plain, 9 to 14 percent slopes, eroded	8.72	10.2%		IVe	57						81	81	64	64
Y11B	Colo, occasionally flooded-Ely silty clay loams, dissected till plain, 2 to 5 percent slopes	3.42	4.0%		Ilw	80						87	86	52	81

W	Water	2.63	3.1%			0	0								
980B	Gullied land-Ely-Colo, occasionally flooded, complex, 2 to 5 percent slopes	2.56	3.0%		Vlle	42	25					10	10	9	9
1313F	Munterville silt loam, 18 to 35 percent slopes	1.35	1.6%		Vlle	5	5					18	18	14	9
Weighted Average					*-	48.8	*-	0.1	1	0.5	0.3	*n 69.6	*n 69.5	*n 52.6	*n 55.8

**IA has updated the CSR values for each county to CSR2.

*- CSR weighted average cannot be calculated on the current soils data, use prior data version for csr values.

*n: The aggregation method is "Weighted Average using all components"

*c: Using Capabilities Class Dominant Condition Aggregation Method

*- Non Irr Class weighted average cannot be calculated on the current soils data due to missing data.

Soils data provided by USDA and NRCS.