

# Tillable Soils Map

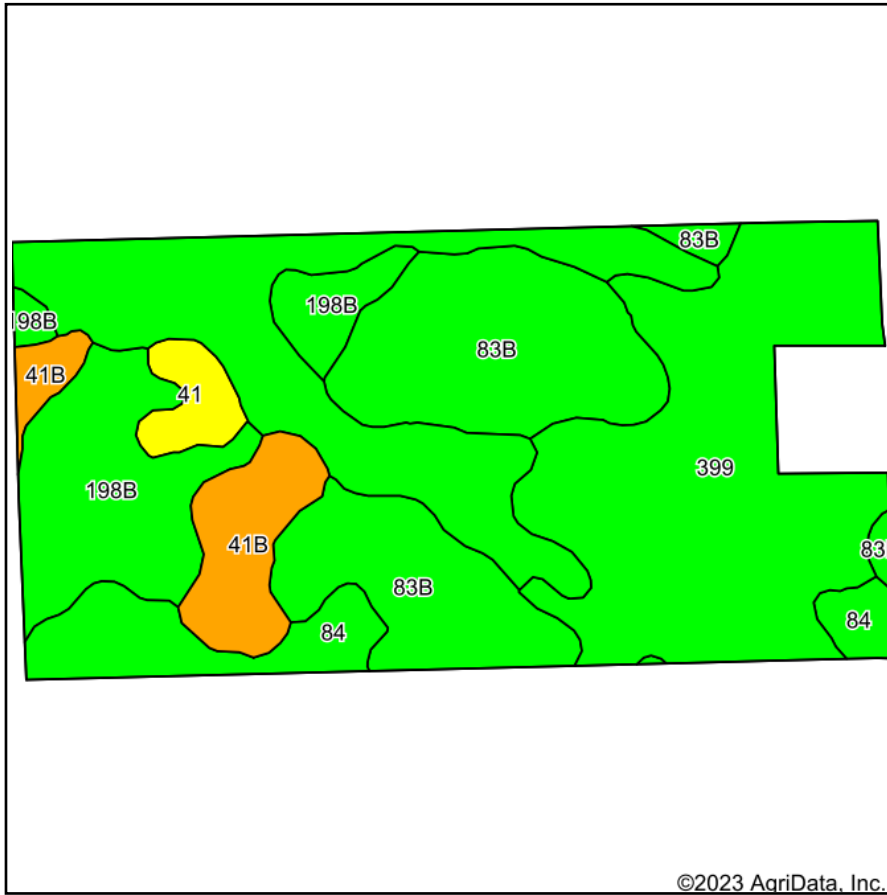

Soils data provided by USDA and NRCS.

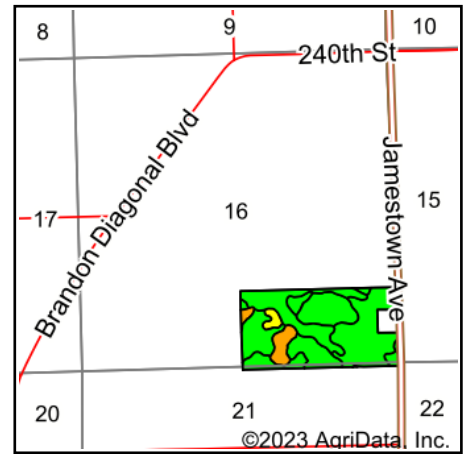

State: **Iowa**  
 County: **Buchanan**  
 Location: **16-88N-9W**  
 Township: **Sumner**  
 Acres: **77.23**  
 Date: **10/26/2023**



Maps Provided By:



© AgriData, Inc. 2023

www.AgriDataInc.com



Area Symbol: IA019, Soil Area Version: 29

| Code             | Soil Description                         | Acres | Percent of field | CSR2 Legend | Non-Irr Class *c | Irr Class *c | CSR2** |
|------------------|--|-------|------------------|-------------|------------------|--------------|--------|
| 399              | Readlyn silt loam, 1 to 3 percent slopes | 21.96 | 28.4%            |             | Iw               |              | 91     |
| 84               | Clyde clay loam, 0 to 3 percent slopes   | 20.07 | 26.0%            |             | IIw              |              | 88     |
| 83B              | Kenyon loam, 2 to 5 percent slopes       | 17.97 | 23.3%            |             | Ile              |              | 90     |
| 198B             | Floyd loam, 1 to 4 percent slopes        | 10.48 | 13.6%            |             | IIw              |              | 89     |
| 41B              | Sparta loamy sand, 2 to 5 percent slopes | 5.00  | 6.5%             |             | IVs              | Ile          | 42     |
| 41               | Sparta loamy sand, 0 to 2 percent slopes | 1.75  | 2.3%             |             | IVs              | Ile          | 48     |
| Weighted Average |  |       |                  |             | 1.89             | *-           | 85.6   |

\*\*IA has updated the CSR values for each county to CSR2.

\*c: Using Capabilities Class Dominant Condition Aggregation Method

\*- Irr Class weighted average cannot be calculated on the current soils data due to missing data.

Soils data provided by USDA and NRCS.