

## Soils Map

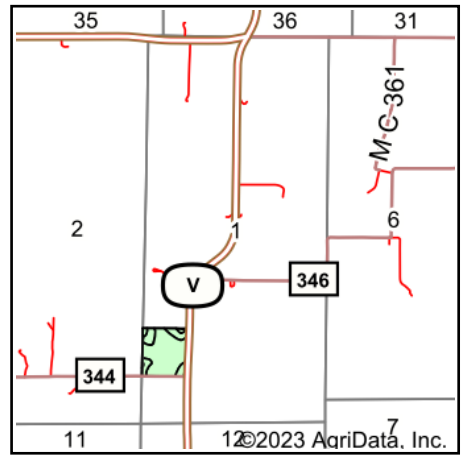

State: **Missouri**  
County: **Monroe**  
Location: **1-55N-9W**  
Township: **Washington**  
Acres: **39.04**  
Date: **8/15/2023**

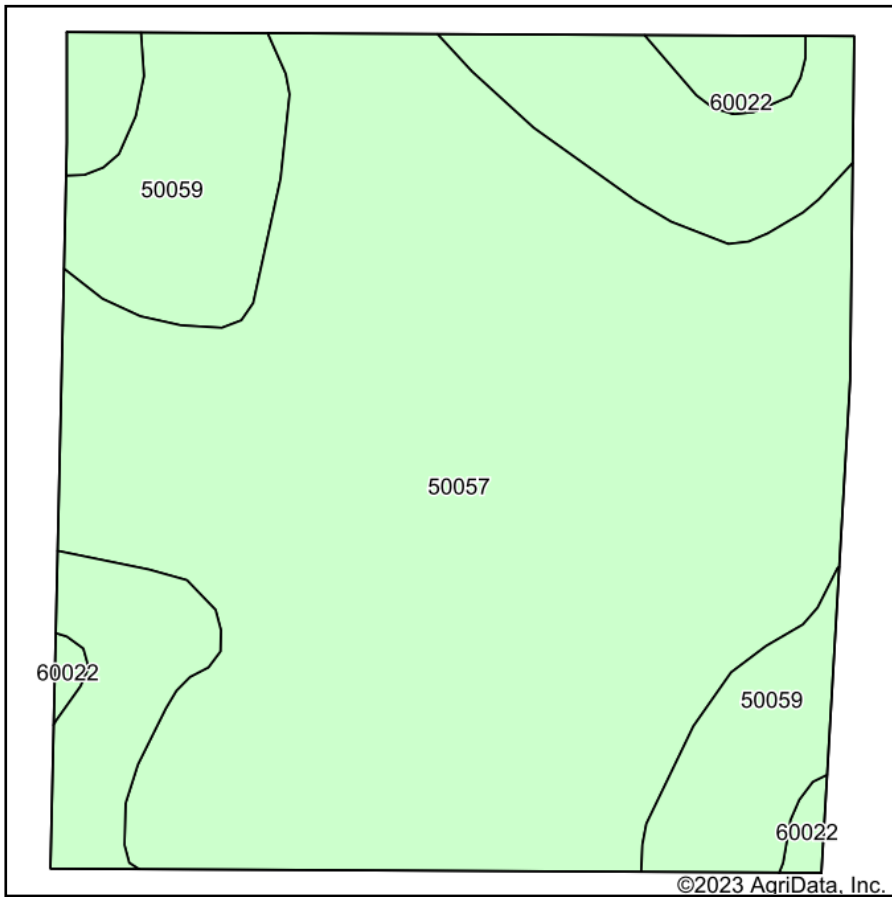

Maps Provided By:



Soils data provided by USDA and NRCS.

Area Symbol: MO137, Soil Area Version: 23

Code	Soil Description	Acres	Percent of field	Non-Irr Class *c	*n NCCPI Soybeans
50057	Putnam silt loam, 1 to 3 percent slopes	27.99	71.7%	IIIw	51
50059	Mexico silt loam, 1 to 4 percent slopes, eroded	9.67	24.8%	IIIe	53
60022	Leonard silt loam, 1 to 6 percent slopes, eroded	1.38	3.5%	IIIe	51
<b>Weighted Average</b>				<b>3.00</b>	<b>*n 51.5</b>

\*n: The aggregation method is "Weighted Average using all components"

\*c: Using Capabilities Class Dominant Condition Aggregation Method

Soils data provided by USDA and NRCS.