

LAND FOR SALE

80 ± ACRES | KINGMAN COUNTY, KANSAS

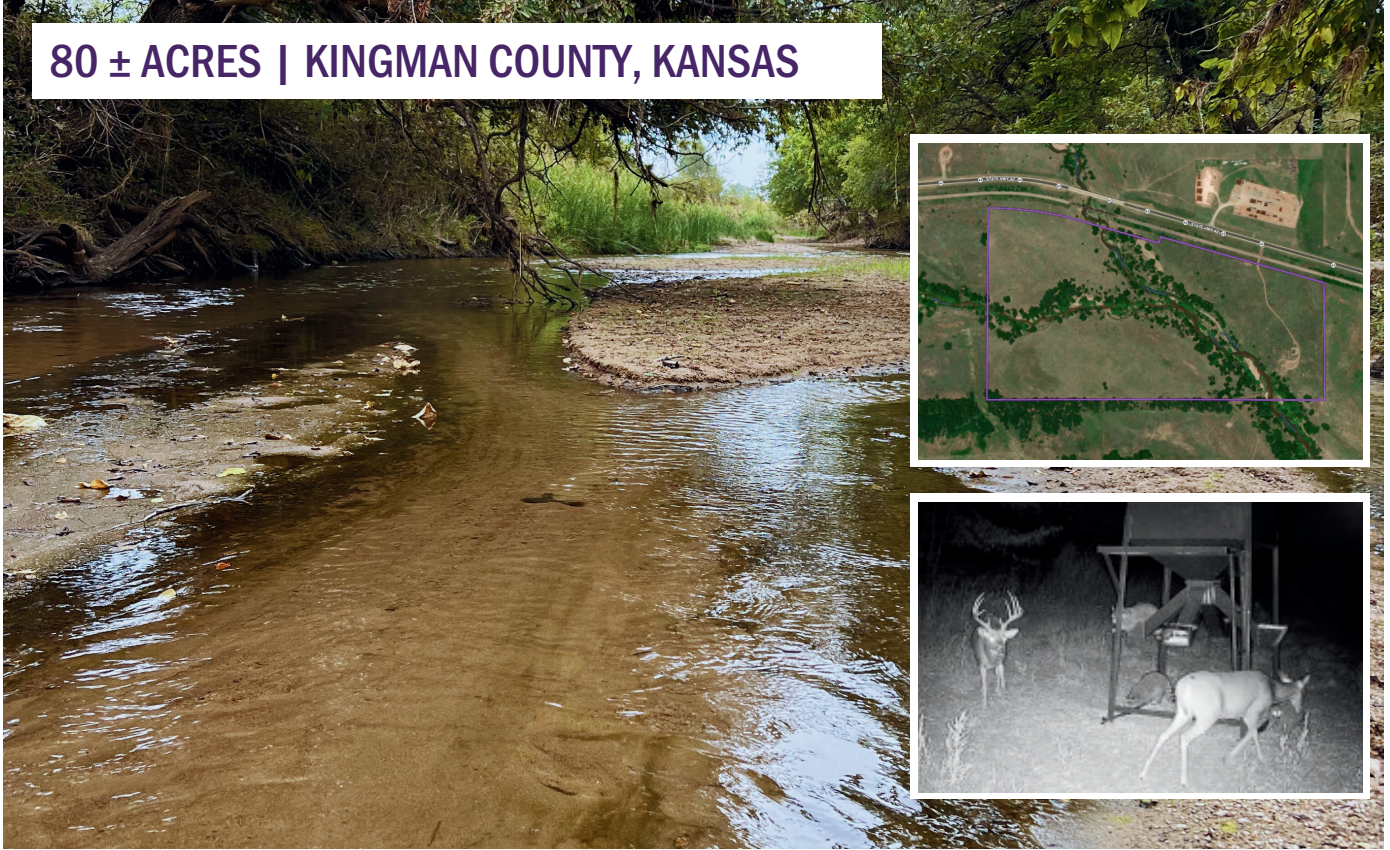

Address: 100 SW 130th Street, Spivey, KS 67142

Legal Description: Part of the S ½ of 9-30-8W of Kingman Co., KS

Location: From Spivey, KS, travel 2 miles west on K-42 Hwy.

Description: Don't miss this rare opportunity to own 80 +/- acres of recreational property located near Spivey, KS in Kingman County. Situated in Kansas Deer Management Unit 16, in the very heart of some of the best deer hunting in Kansas, and is well known for consistently producing trophy deer annually. The property has been painstakingly developed to attract and hold deer. The Chikaskia River and Sand Creek join together and run the entire length of the property. The land is located an hour west of Wichita and provides easy access from Hwy 42. There are several prime locations to park an RV or build a cabin with outstanding views of the Chikaskia River. There is electricity available on the north side of the property.

Minerals: Seller's mineral interest will pass to the Buyer.

Possession: Possession will be upon closing.

Taxes: 2022 - \$119.38 Taxes will be prorated to the date of closing.

Listing Price: \$348,525.00

Ralph Lilja · REALTOR®

12140 W. K-42 Hwy · Wichita, KS 67227

C: (620) 243-3244 · ralph@genefrancis.com