

# Soils Map

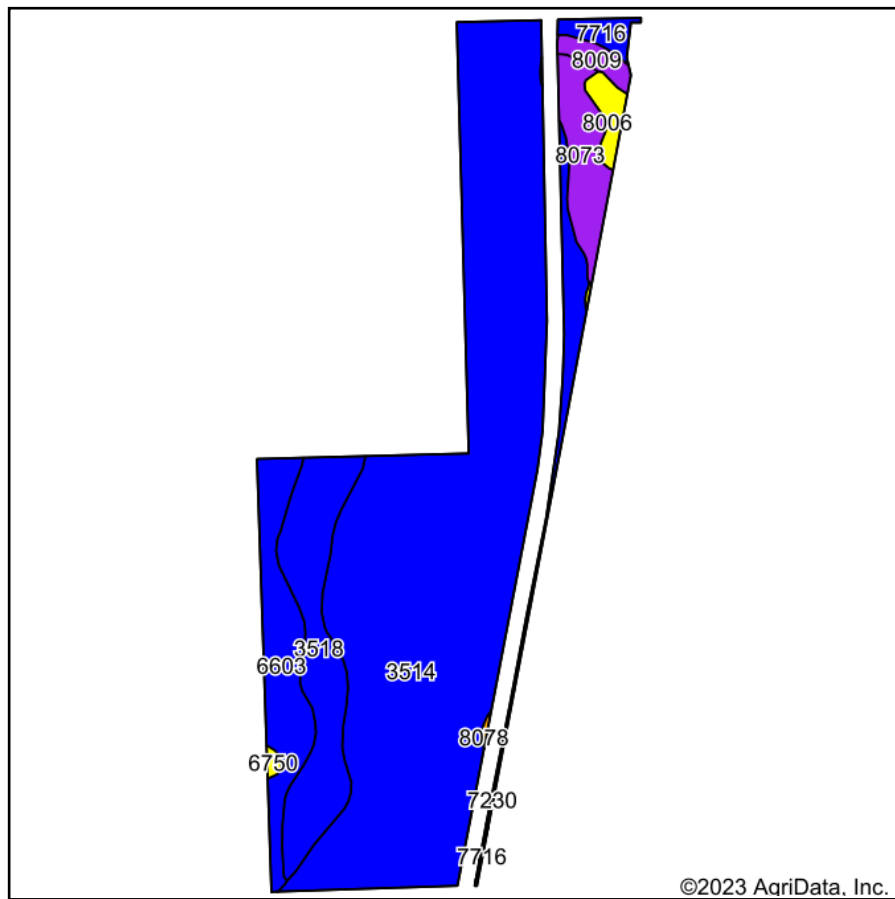

Soils data provided by USDA and NRCS.

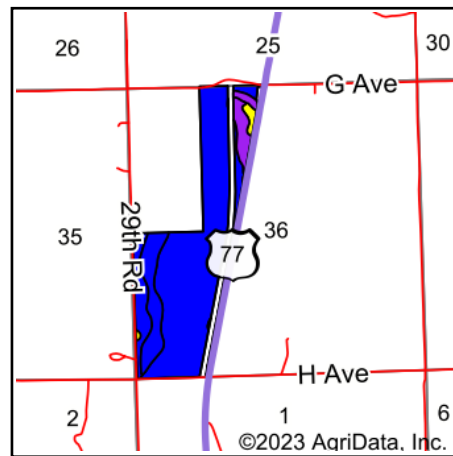

State: **Nebraska**  
 County: **Thurston**  
 Location: **36-26N-8E**  
 Township: **Omaha**  
 Acres: **133.97**  
 Date: **8/30/2023**



Maps Provided By:



Area Symbol: NE173, Soil Area Version: 20

Code	Soil Description	Acres	Percent of field	Non-Irr Class Legend	Non-Irr Class *c	Irr Class *c	*n NCCPI Overall
3514	Lamo silt loam, overwash, 0 to 2 percent slopes, occasionally flooded	95.90	71.6%		IIw	IIw	83
3518	Lamo silty clay loam, 0 to 2 percent slopes, occasionally flooded	15.21	11.4%		IIw	IIw	76
6603	Alcester silty clay loam, 2 to 6 percent slopes	10.98	8.2%		IIe	IIIe	75
8073	Monona silt loam, 17 to 30 percent slopes	6.05	4.5%		VIe		43
8006	Ida silt loam, 11 to 17 percent slopes, eroded	1.85	1.4%		IVe		64
7716	McPaul silt loam, occasionally flooded	1.75	1.3%		IIw	IIw	71
8009	Ida silt loam, 30 to 60 percent slopes	1.57	1.2%		VIIe		16
6750	Nora silt loam, 11 to 17 percent slopes, eroded	0.29	0.2%		IVe		63
8078	Monona silt loam, 6 to 11 percent slopes	0.26	0.2%		IIIe	IVe	88
7230	Alcester silty clay loam, 0 to 2 percent slopes	0.11	0.1%		I	I	76
Weighted Average					2.27	*-	*n 78.5

\*n: The aggregation method is "Weighted Average using all components"

\*c: Using Capabilities Class Dominant Condition Aggregation Method

\*- Irr Class weighted average cannot be calculated on the current soils data due to missing data.

Soils data provided by USDA and NRCS.