

Soils Map

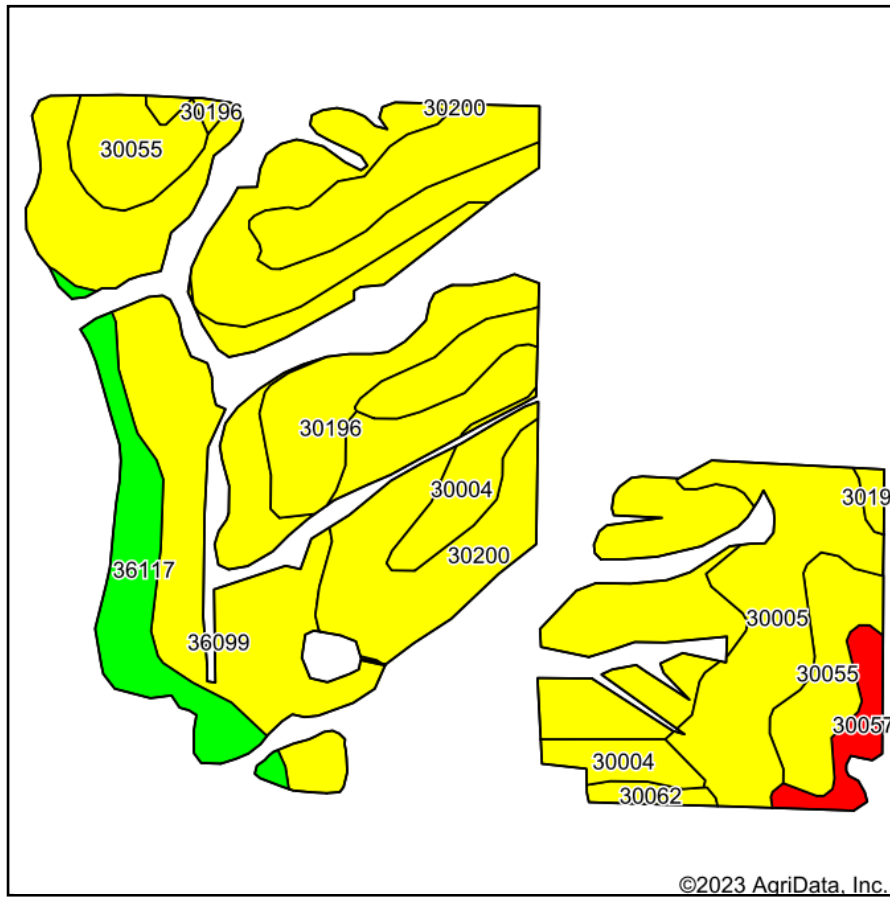

Soils data provided by USDA and NRCS.

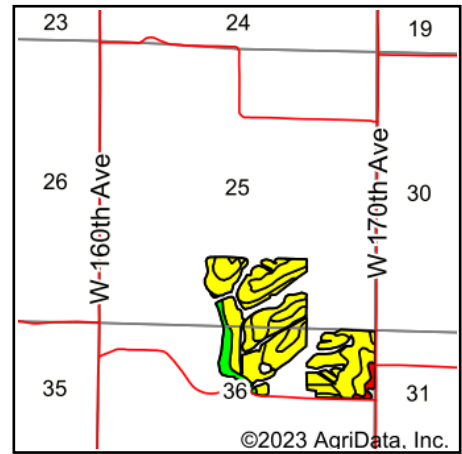

State: **Missouri**
 County: **Harrison**
 Location: **36-65N-29W**
 Township: **Washington**
 Acres: **104.1**
 Date: **11/15/2023**



Maps Provided By:



© AgriData, Inc. 2023

www.AgriDataInc.com



Area Symbol: MO081, Soil Area Version: 27

Code	Soil Description	Acres	Percent of field	Non-Irr Class Legend	Non-Irr Class *c	*n NCCPI Overall	*n NCCPI Corn	*n NCCPI Small Grains	*n NCCPI Soybeans
36099	Zook-Colo silty clay loams, 1 to 3 percent slopes, frequently flooded	24.37	23.4%		IIIw	67	67	58	57
30200	Shelby loam, 9 to 14 percent slopes	21.76	20.9%		IIIe	72	72	60	61
30005	Adair loam, 3 to 9 percent slopes	16.59	15.9%		IIIe	72	72	66	62
30196	Shelby clay loam, 9 to 14 percent slopes, severely eroded	15.80	15.2%		IVe	66	66	52	46
30055	Gara clay loam, 9 to 14 percent slopes, severely eroded	8.34	8.0%		IVe	64	64	49	41
30004	Adair clay loam, heavy till, 5 to 9 percent slopes, moderately eroded	7.27	7.0%		IIIe	66	66	55	46
36117	Nodaway silt loam, heavy till, 0 to 2 percent slopes, occasionally flooded	6.94	6.7%		IIw	80	80	74	78
30057	Gara loam, 14 to 18 percent slopes	2.21	2.1%		VIe	66	66	56	52
30062	Gara loam, 9 to 14 percent slopes	0.82	0.8%		IVe	71	71	60	59
Weighted Average					3.24	*n 69.3	*n 69.3	*n 58.9	*n 56.2

*n: The aggregation method is "Weighted Average using all components"

*c: Using Capabilities Class Dominant Condition Aggregation Method

Soils data provided by USDA and NRCS.