

Row Crop Soils Map

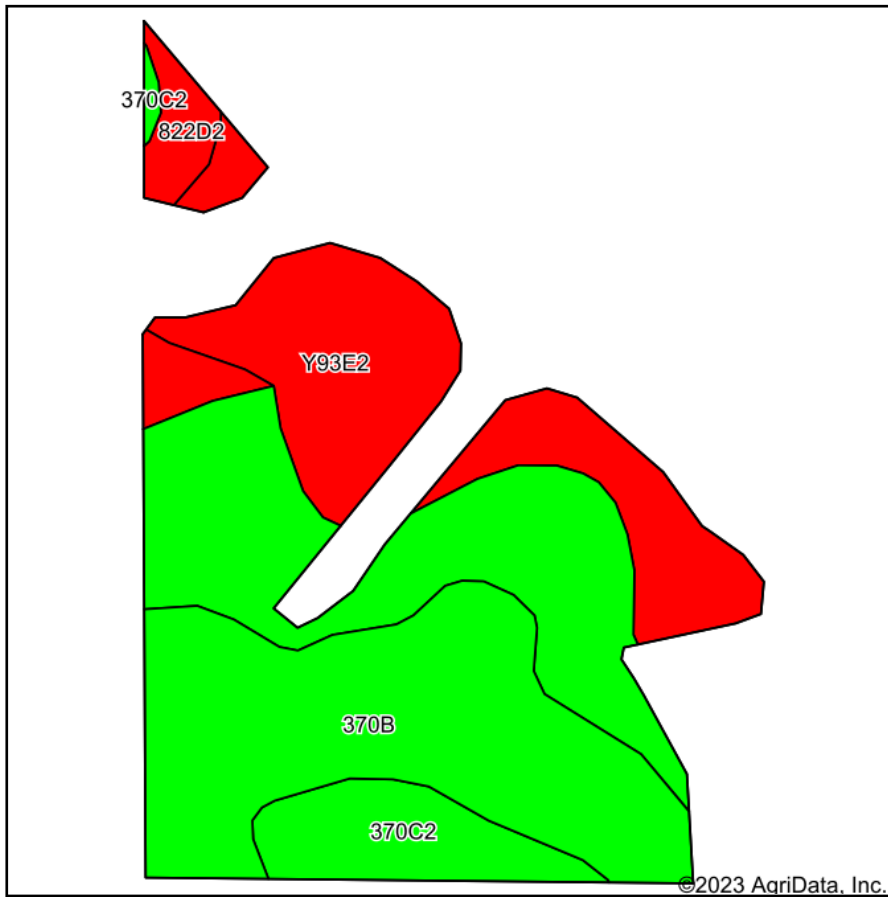

Soils data provided by USDA and NRCS.

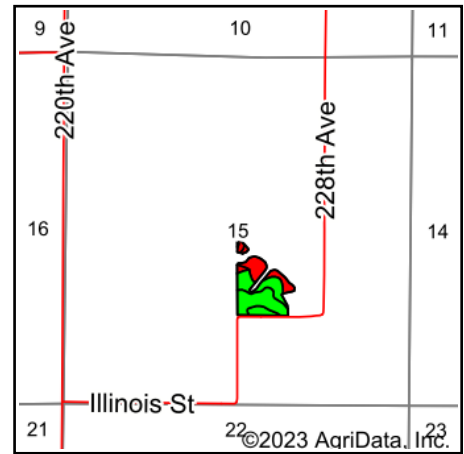

State: **Iowa**
 County: **Warren**
 Location: **15-76N-22W**
 Township: **Union**
 Acres: **13.31**
 Date: **12/5/2023**

PC PEOPLES
 COMPANY
 INTEGRATED LAND SOLUTIONS

Maps Provided By:

surety
 CUSTOMIZED ONLINE MAPPING
 © AgriData, Inc. 2023 www.AgriDataInc.com



Area Symbol: IA181, Soil Area Version: 29

| Code | Soil Description | Acres | Percent of field | CSR2 Legend | Non-Irr Class *c | CSR2** | CSR | *n NCCPI Overall | *n NCCPI Corn | *n NCCPI Small Grains | *n NCCPI Soybeans |
|-------------------------|--|-------|------------------|-------------|------------------|-------------|-------------|------------------|----------------|-----------------------|-------------------|
| 370C2 | Sharpsburg silty clay loam, 5 to 9 percent slopes, eroded | 4.72 | 35.5% | | IIIe | 80 | 67 | 82 | 82 | 68 | 66 |
| 370B | Sharpsburg silty clay loam, 2 to 5 percent slopes | 4.54 | 34.1% | | Ile | 91 | 87 | 92 | 92 | 77 | 79 |
| Y93E2 | Shelby-Adair clay loams, dissected till plain, 14 to 18 percent slopes, eroded | 3.40 | 25.5% | | IVe | 28 | | 61 | 61 | 48 | 43 |
| 822D2 | Lamoni silty clay loam, 9 to 14 percent slopes, eroded | 0.65 | 4.9% | | IVe | 10 | 15 | 59 | 59 | 54 | 42 |
| Weighted Average | | | | | | 2.96 | 67.1 | *n 78.9 | *n 78.9 | *n 65.3 | *n 63.4 |

**IA has updated the CSR values for each county to CSR2.

*- CSR weighted average cannot be calculated on the current soils data, use prior data version for csr values.

*n: The aggregation method is "Weighted Average using all components"

*c: Using Capabilities Class Dominant Condition Aggregation Method

Soils data provided by USDA and NRCS.