

Soils Map

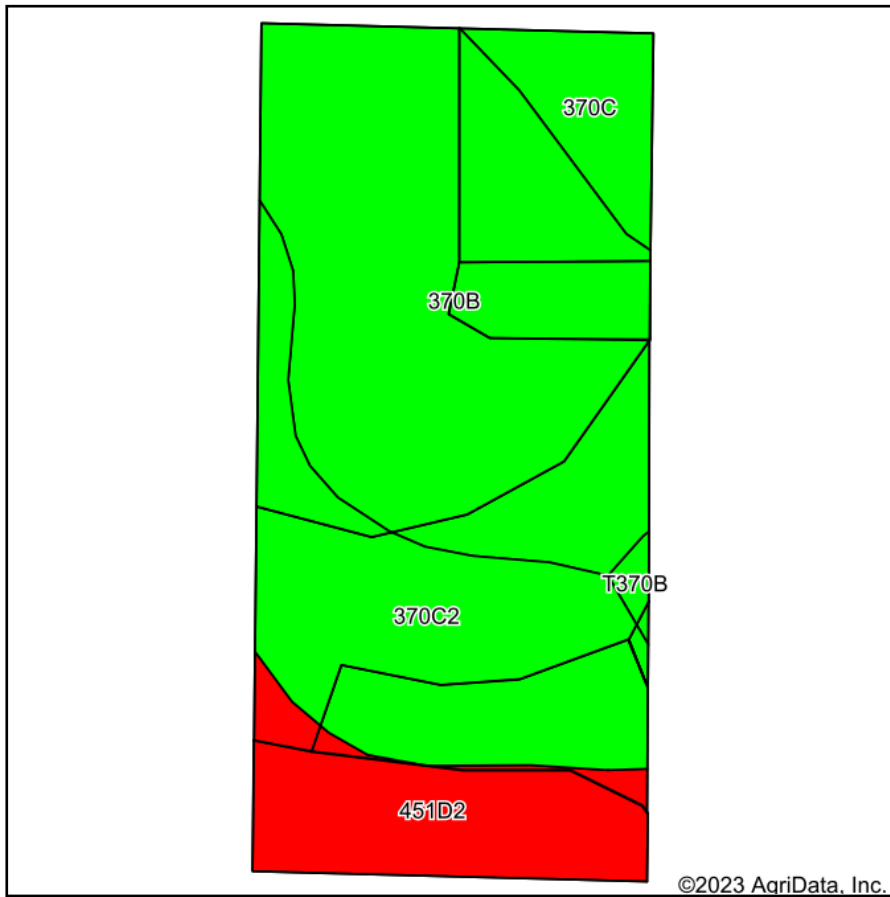

Soils data provided by USDA and NRCS.

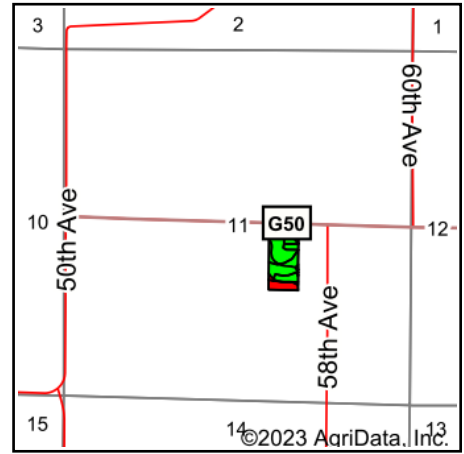

State: **Iowa**
County: **Warren**
Location: **11-75N-25W**
Township: **Jackson**
Acres: **10**
Date: **12/11/2023**



Maps Provided By:



Area Symbol: IA181, Soil Area Version: 29

Code	Soil Description	Acres	Percent of field	CSR2 Legend	Non-Irr Class *c	CSR2**	CSR	*n NCCPI Overall	*n NCCPI Corn	*n NCCPI Small Grains	*n NCCPI Soybeans
370B	Sharpsburg silty clay loam, 2 to 5 percent slopes	5.06	50.6%		Ile	91	87	92	92	77	79
370C2	Sharpsburg silty clay loam, 5 to 9 percent slopes, eroded	2.74	27.4%		IIle	80	67	82	82	68	66
451D2	Caleb loam, 9 to 14 percent slopes, moderately eroded	1.49	14.9%		IVe	47	38	77	77	56	59
370C	Sharpsburg silty clay loam, 5 to 9 percent slopes	0.64	6.4%		IIle	81	72	89	89	76	76
T370B	Sharpsburg silty clay loam, terrace, 2 to 5 percent slopes	0.07	0.7%		Ile	91	87	90	90	75	77
Weighted Average					2.64	80.8	73.3	*n 86.8	*n 86.8	*n 71.3	*n 72.3

**IA has updated the CSR values for each county to CSR2.

*n: The aggregation method is "Weighted Average using all components"

*c: Using Capabilities Class Dominant Condition Aggregation Method

Soils data provided by USDA and NRCS.