

CRP Soils Map

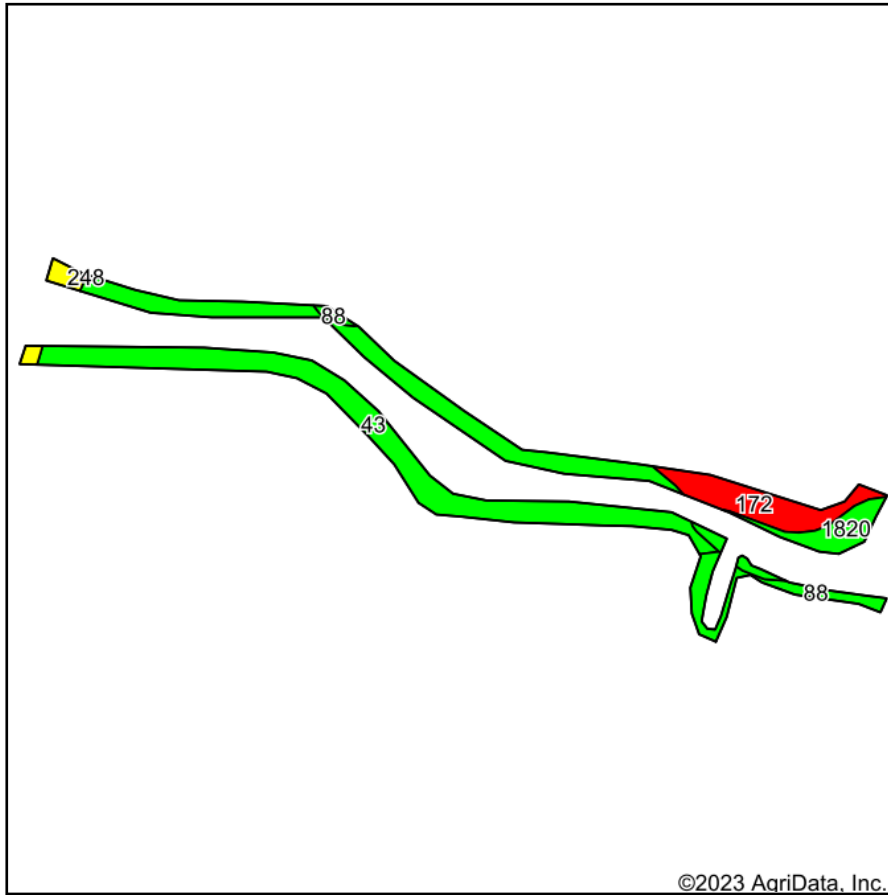

Soils data provided by USDA and NRCS.

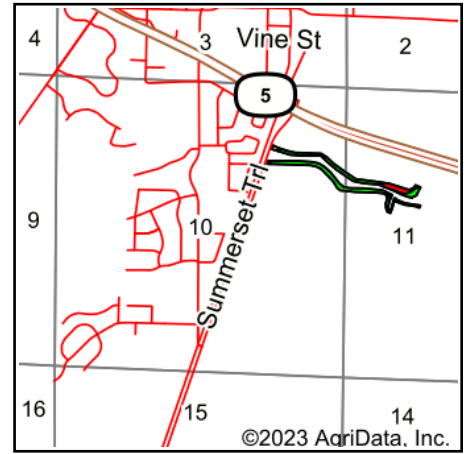

State: **Iowa**
 County: **Warren**
 Location: **10-77N-23W**
 Township: **Allen**
 Acres: **9.41**
 Date: **12/20/2023**

PC PEOPLES
 COMPANY
 INTEGRATED LAND SOLUTIONS

Maps Provided By:

surety
 CUSTOMIZED ONLINE MAPPING
 © AgriData, Inc. 2023 www.AgriDataInc.com



Area Symbol: IA181, Soil Area Version: 29

| Code | Soil Description | Acres | Percent of field | CSR2 Legend | Non-Irr Class *c | CSR2** | CSR | *n NCCPI Overall | *n NCCPI Corn | *n NCCPI Small Grains | *n NCCPI Soybeans |
|------------------|--|-------|------------------|-------------|------------------|--------|-----|------------------|---------------|-----------------------|-------------------|
| 43 | Bremer silty clay loam, 0 to 2 percent slopes, occasionally flooded | 6.25 | 66.4% | | IIw | 74 | 82 | 85 | 85 | 69 | 78 |
| 172 | Wabash silty clay, 0 to 2 percent slopes | 1.28 | 13.6% | | IIIw | 38 | 45 | 48 | 46 | 19 | 47 |
| 1820 | Dockery-Quiver silt loams, 0 to 2 percent slopes, occasionally flooded | 0.84 | 8.9% | | IIw | 87 | | 93 | 85 | 49 | 92 |
| 88 | Nevin silty clay loam, 0 to 2 percent slopes, rarely flooded | 0.79 | 8.4% | | Iw | 95 | 90 | 98 | 98 | 80 | 88 |
| 54 | Zook silty clay loam, 0 to 2 percent slopes, occasionally flooded | 0.25 | 2.7% | | IIw | 67 | 70 | 63 | 58 | 33 | 63 |
| Weighted Average | | | | | 2.05 | 71.8 | *- | *n 81.2 | *n 80.1 | *n 60.4 | *n 75.5 |

**IA has updated the CSR values for each county to CSR2.

*- CSR weighted average cannot be calculated on the current soils data, use prior data version for csr values.

*n: The aggregation method is "Weighted Average using all components"

*c: Using Capabilities Class Dominant Condition Aggregation Method

Soils data provided by USDA and NRCS.