

# Tillable Soils Map

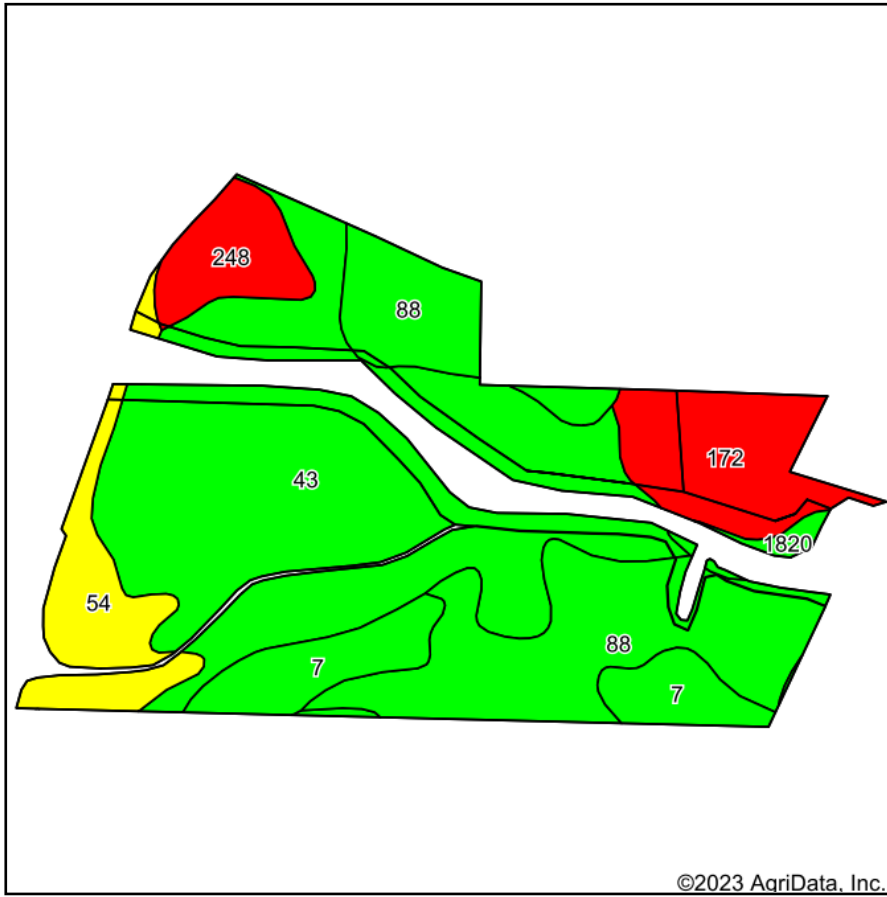

Soils data provided by USDA and NRCS.

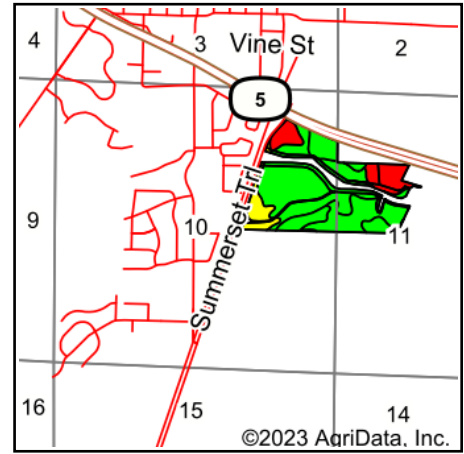

State: **Iowa**  
 County: **Warren**  
 Location: **10-77N-23W**  
 Township: **Allen**  
 Acres: **96.46**  
 Date: **12/20/2023**

**PC PEOPLES**  
 COMPANY  
 INTEGRATED LAND SOLUTIONS

Maps Provided By:

**surety**  
 CUSTOMIZED ONLINE MAPPING  
 © AgriData, Inc. 2023 www.AgriDataInc.com



Area Symbol: IA181, Soil Area Version: 29

Code	Soil Description	Acres	Percent of field	CSR2 Legend	Non-Irr Class *c	CSR2**	CSR	*n NCCPI Overall	*n NCCPI Corn	*n NCCPI Small Grains	*n NCCPI Soybeans	*n NCCPI Cotton
43	Bremer silty clay loam, 0 to 2 percent slopes, occasionally flooded	43.63	45.2%		Ilw	74	82	85	85	69	78	
88	Nevin silty clay loam, 0 to 2 percent slopes, rarely flooded	22.88	23.7%		Iw	95	90	98	98	80	88	
172	Wabash silty clay, 0 to 2 percent slopes	8.82	9.1%		Illw	38	45	48	46	19	47	
7	Wiota silt loam, 0 to 2 percent slopes	7.84	8.1%		Is	97	90	95	95	77	86	9
54	Zook silty clay loam, 0 to 2 percent slopes, occasionally flooded	7.58	7.9%		Ilw	67	70	63	58	33	63	
248	Wabash silty clay loam, 0 to 2 percent slopes	4.83	5.0%		Illw	38	60	50	47	20	50	
1820	Dockery-Quiver silt loams, 0 to 2 percent slopes, occasionally flooded	0.88	0.9%		Ilw	87		93	85	49	92	
<b>Weighted Average</b>						<b>1.82</b>	<b>75.3</b>	<b>*n 82.1</b>	<b>*n 81.3</b>	<b>*n 62.2</b>	<b>*n 75.7</b>	<b>*n 0.7</b>

\*\*IA has updated the CSR values for each county to CSR2.

\*. CSR weighted average cannot be calculated on the current soils data, use prior data version for csr values.

\*n: The aggregation method is "Weighted Average using all components"

\*c: Using Capabilities Class Dominant Condition Aggregation Method

Soils data provided by USDA and NRCS.