

# Est. Current Tillable Soils Map

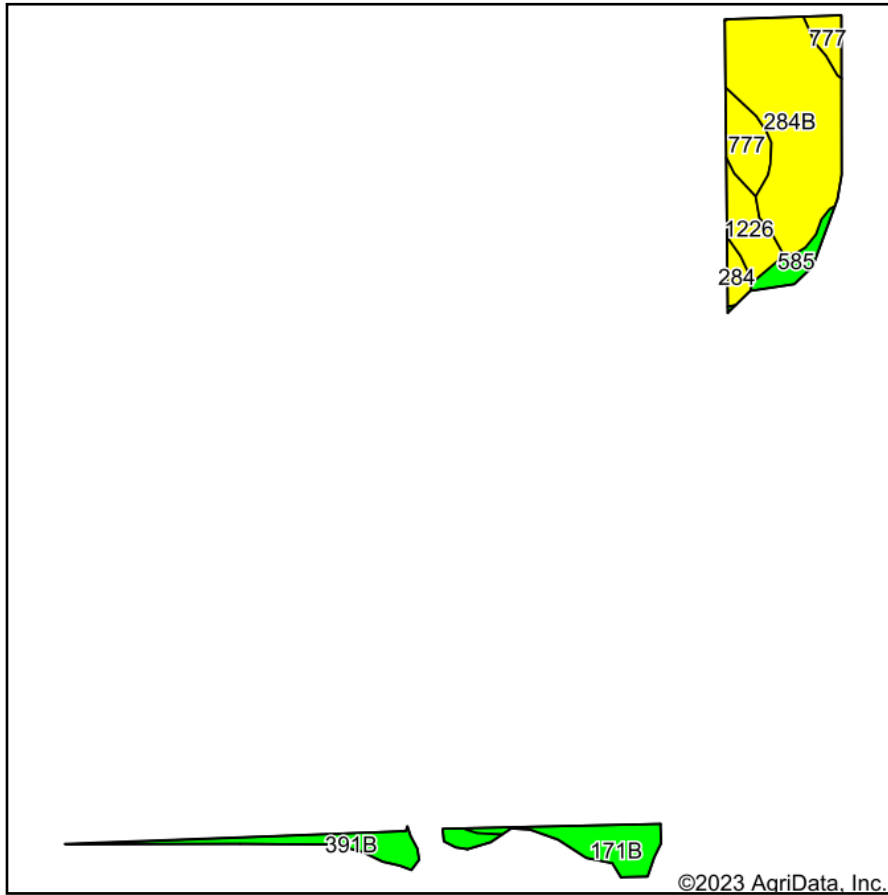

Soils data provided by USDA and NRCS.

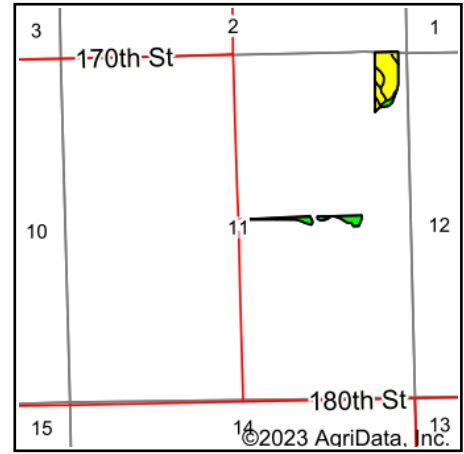

State: **Iowa**  
 County: **Buchanan**  
 Location: **11-89N-8W**  
 Township: **Byron**  
 Acres: **8.39**  
 Date: **12/20/2023**

**PC PEOPLES**  
 COMPANY  
 INTEGRATED LAND SOLUTIONS

Maps Provided By:

**surety**  
 CUSTOMIZED ONLINE MAPPING  
 © AgriData, Inc. 2023 www.AgriDataInc.com



Area Symbol: IA019, Soil Area Version: 29

Code	Soil Description	Acres	Percent of field	CSR2 Legend	Non-Irr Class *c	CSR2**
284B	Flagler sandy loam, 2 to 5 percent slopes	4.11	49.0%		IIIe	51
777	Wapsie loam, 0 to 2 percent slopes	1.00	11.9%		IIIs	51
171B	Bassett loam, 2 to 5 percent slopes	0.95	11.3%		IIe	85
391B	Clyde-Floyd complex, 1 to 4 percent slopes	0.94	11.2%		IIw	87
1226	Lawler loam, 0 to 2 percent slopes, rarely flooded	0.74	8.8%		IIIs	59
585	Coland-Spillville complex, 0 to 2 percent slopes, occasionally flooded	0.41	4.9%		IIw	70
284	Flagler sandy loam, 0 to 2 percent slopes	0.24	2.9%		IIIs	55
Weighted Average					2.52	60.6

\*\*IA has updated the CSR values for each county to CSR2.

\*c: Using Capabilities Class Dominant Condition Aggregation Method  
 Soils data provided by USDA and NRCS.