

# Total Soils Map

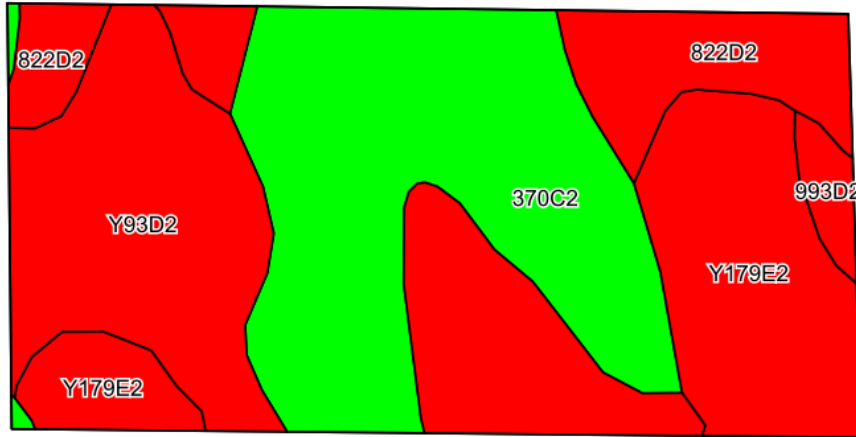

©2024 AgriData, Inc.

Soils data provided by USDA and NRCS.

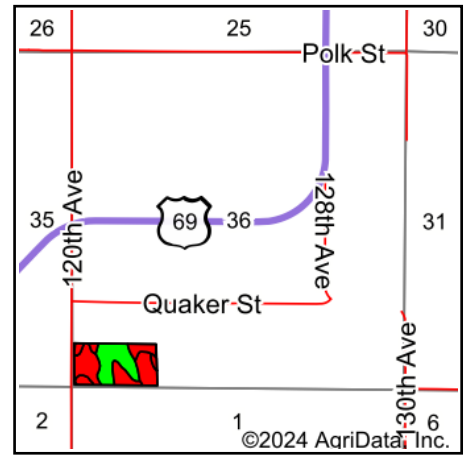

State: **Iowa**  
 County: **Warren**  
 Location: **36-75N-24W**  
 Township: **White Oak**  
 Acres: **19.88**  
 Date: **1/3/2024**



Maps Provided By:



© AgriData, Inc. 2023

www.AgriDataInc.com



Area Symbol: IA181, Soil Area Version: 29

Code	Soil Description	Acres	Percent of field	CSR2 Legend	Non-Irr Class *c	CSR2**	CSR	*n NCCPI Overall	*n NCCPI Corn	*n NCCPI Small Grains	*n NCCPI Soybeans
370C2	Sharpsburg silty clay loam, 5 to 9 percent slopes, eroded	6.91	34.8%		IIIe	80	67	82	82	68	66
Y93D2	Shelby-Adair clay loams, dissected till plain, 9 to 14 percent slopes, eroded	6.18	31.1%		IIIe	35		68	68	56	50
Y179E2	Gara loam, dissected till plain, 14 to 18 percent slopes, eroded	3.95	19.9%		VIe	32		70	70	53	49
822D2	Lamoni silty clay loam, 9 to 14 percent slopes, eroded	2.49	12.5%		IVe	10	15	59	59	54	42
993D2	Armstrong-Gara loams, 9 to 14 percent slopes, moderately eroded	0.35	1.8%		IVe	23	20	67	67	53	48
Weighted Average					3.74	46.7	*-	*n 72.1	*n 72.1	*n 59.3	*n 54.3

\*\*IA has updated the CSR values for each county to CSR2.

\*- CSR weighted average cannot be calculated on the current soils data, use prior data version for csr values.

\*n: The aggregation method is "Weighted Average using all components"

\*c: Using Capabilities Class Dominant Condition Aggregation Method

Soils data provided by USDA and NRCS.