

Soils Map

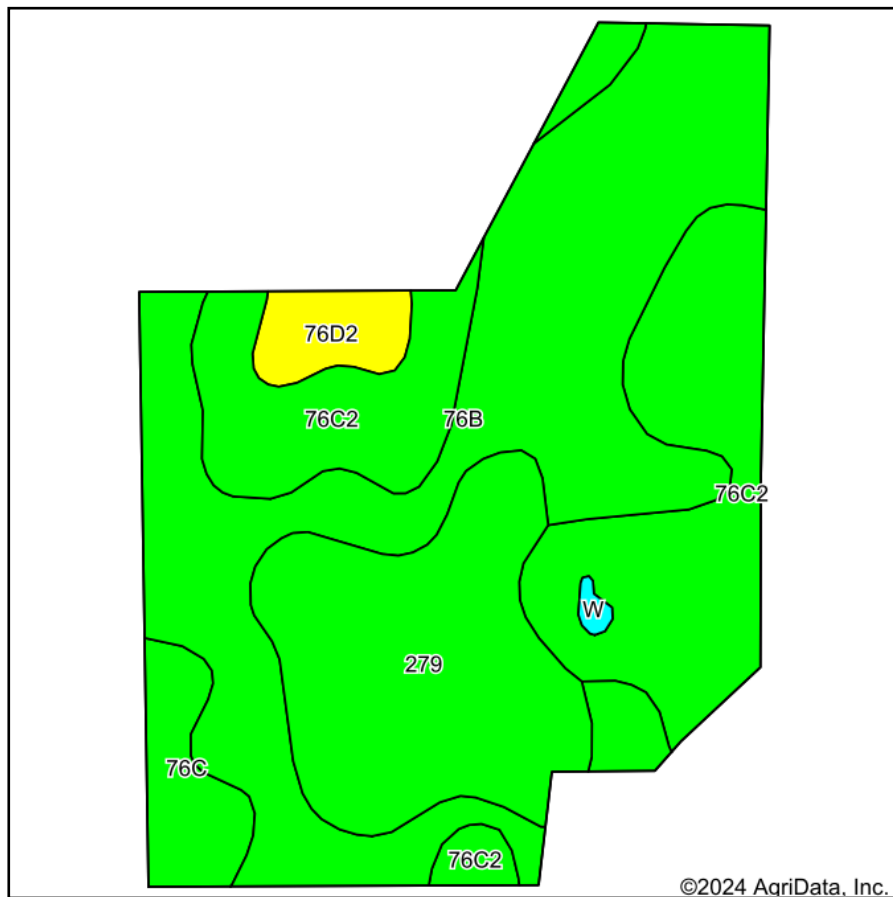

Soils data provided by USDA and NRCS.

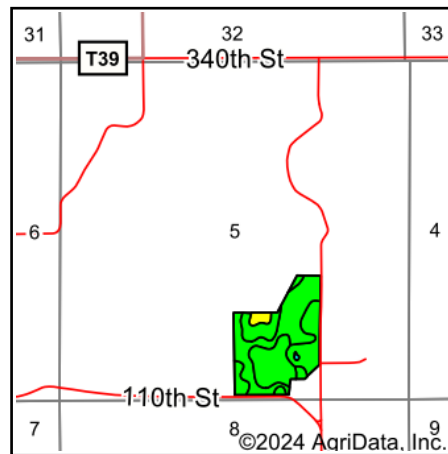

State: **Iowa**
 County: **Monroe**
 Location: **5-73N-16W**
 Township: **Pleasant**
 Acres: **40**
 Date: **1/29/2024**

Hawkeye Farm Mgmt & Real Estate

22 N Main, Albion IA Phone: 641-932-7796
 Email: hawkeye@uciowa.com
 On the web: www.uciowa.com
www.iowawhitetailfarms.com

Maps Provided By:

surety
 CUSTOMIZED ONLINE MAPPING
 © AgriData, Inc. 2023 www.AgriDataInc.com



Area Symbol: IA135, Soil Area Version: 31

Code	Soil Description	Acres	Percent of field	CSR2 Legend	Non-Irr Class *c	CSR2**	CSR	*n NCCPI Corn	*n NCCPI Soybeans
76B	Ladoga silt loam, 2 to 5 percent slopes	16.92	42.3%		Ile	86	85	91	77
76C2	Ladoga silt loam, 5 to 9 percent slopes, eroded	11.59	29.0%		IIle	75	65	85	67
279	Taintor silt loam, 0 to 2 percent slopes	8.32	20.8%		IIw	83	88	82	70
76C	Ladoga silt loam, 5 to 9 percent slopes	1.80	4.5%		IIle	79	70	91	77
76D2	Ladoga silt loam, 9 to 14 percent slopes, eroded	1.24	3.1%		IIle	49	55	81	62
W	Water	0.13	0.3%			0	0		
Weighted Average					*-	80.4	77.9	*n 86.8	*n 71.9

**IA has updated the CSR values for each county to CSR2.

*n: The aggregation method is "Weighted Average using all components"

**IA has updated the CSR values for each county to CSR2.*c: Using Capabilities Class Dominant Condition Aggregation Method

**IA has updated the CSR values for each county to CSR2.*c: Using Capabilities Class Dominant Condition Aggregation Method*- Non Irr Class weighted average cannot be calculated on the current soils data due to missing data.