

Total Soils Map

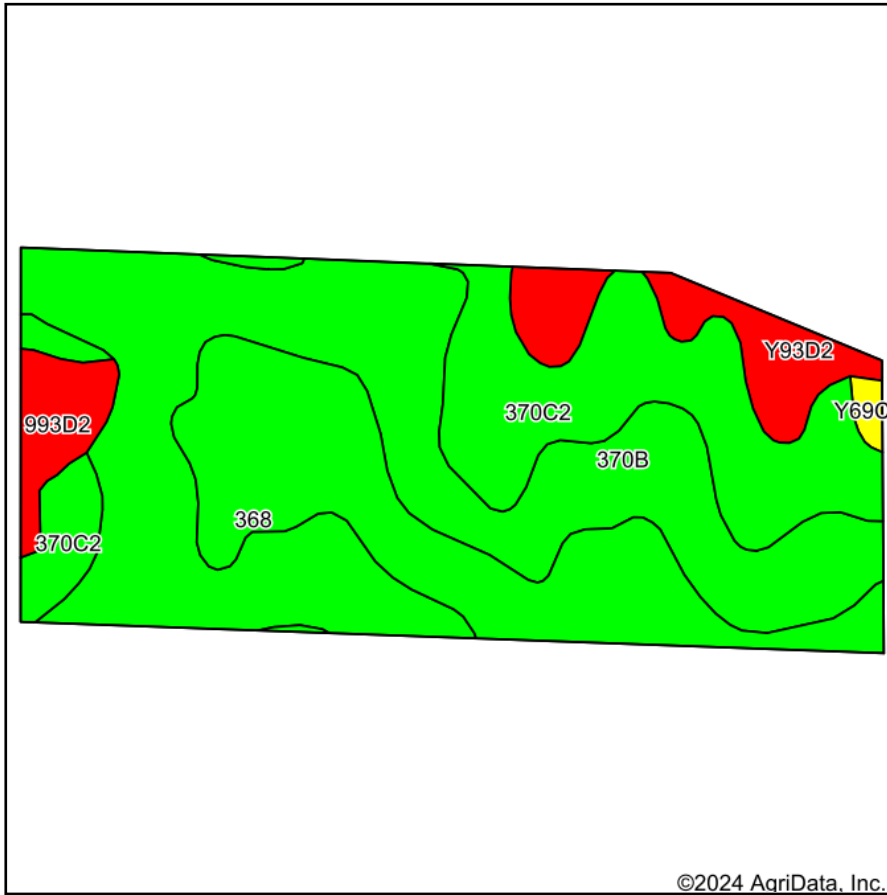

Soils data provided by USDA and NRCS.

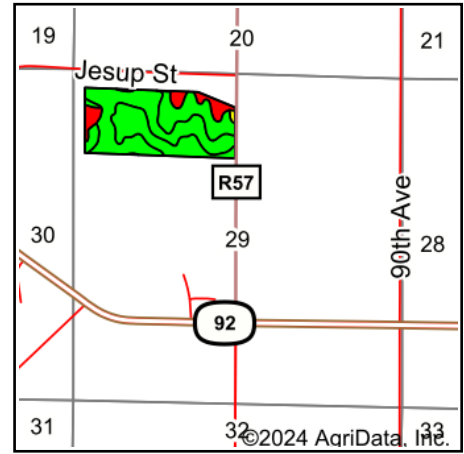

State: **Iowa**
 County: **Warren**
 Location: **29-76N-24W**
 Township: **Lincoln**
 Acres: **57.26**
 Date: **1/25/2024**



Area Symbol: IA181, Soil Area Version: 29

| Code | Soil Description | Acres | Percent of field | CSR2 Legend | Non-Irr Class *c | CSR2** | CSR | *n NCCPI Overall | *n NCCPI Corn | *n NCCPI Small Grains | *n NCCPI Soybeans |
|------------------|---|-------|------------------|-------------|------------------|--------|-----|------------------|---------------|-----------------------|-------------------|
| 370B | Sharpsburg silty clay loam, 2 to 5 percent slopes | 25.64 | 44.8% | | Ile | 91 | 87 | 92 | 92 | 77 | 79 |
| 370C2 | Sharpsburg silty clay loam, 5 to 9 percent slopes, eroded | 12.82 | 22.4% | | IIle | 80 | 67 | 82 | 82 | 68 | 66 |
| 368 | Macksburg silty clay loam, 0 to 2 percent slopes | 12.56 | 21.9% | | Iw | 93 | 95 | 87 | 87 | 79 | 79 |
| Y93D2 | Shelby-Adair clay loams, dissected till plain, 9 to 14 percent slopes, eroded | 3.87 | 6.8% | | IIle | 35 | | 68 | 68 | 56 | 50 |
| 993D2 | Armstrong-Gara loams, 9 to 14 percent slopes, moderately eroded | 2.03 | 3.5% | | IVe | 23 | 20 | 67 | 67 | 53 | 48 |
| Y69C2 | Clearfield silty clay loam, dissected till plain, 5 to 9 percent slopes, eroded | 0.34 | 0.6% | | IIlw | 56 | | 66 | 66 | 63 | 59 |
| Weighted Average | | | | | 2.15 | 82.6 | *- | *n 86 | *n 86 | *n 73.1 | *n 72.9 |

**IA has updated the CSR values for each county to CSR2.

**IA has updated the CSR values for each county to CSR2.*- CSR weighted average cannot be calculated on the current soils data, use prior data version for csr values.

*n: The aggregation method is "Weighted Average using all components"

**IA has updated the CSR values for each county to CSR2.*- CSR weighted average cannot be calculated on the current soils data, use prior data version for csr values.*c: Using Capabilities Class Dominant Condition Aggregation Method