

Tillable Soils Map

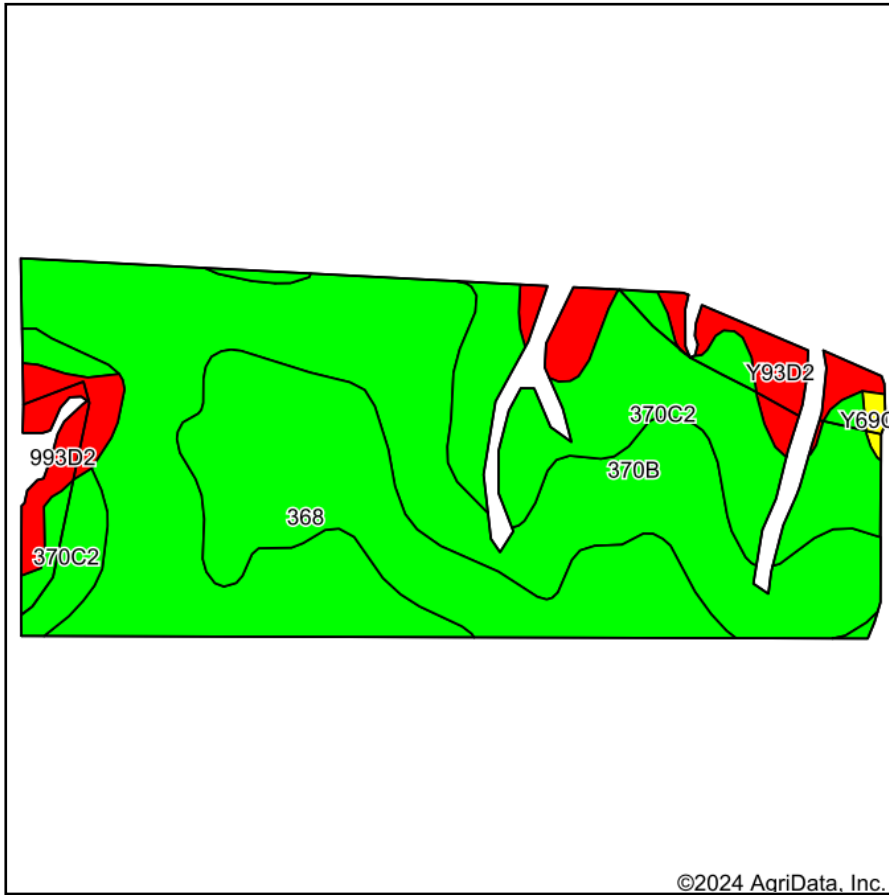

Soils data provided by USDA and NRCS.

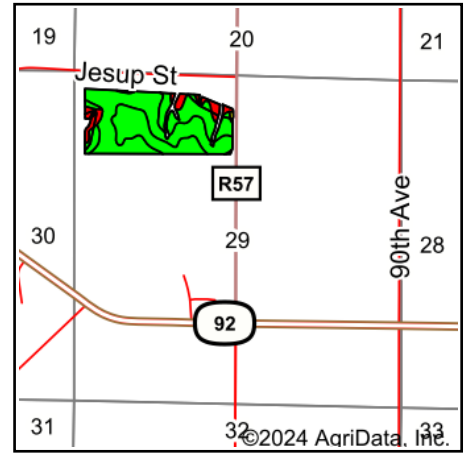

State: **Iowa**
 County: **Warren**
 Location: **29-76N-24W**
 Township: **Lincoln**
 Acres: **51.14**
 Date: **1/29/2024**



Maps Provided By:



Area Symbol: IA181, Soil Area Version: 29

Code	Soil Description	Acres	Percent of field	CSR2 Legend	Non-Irr Class *c	CSR2**	CSR	*n NCCPI Overall	*n NCCPI Corn	*n NCCPI Small Grains	*n NCCPI Soybeans
370B	Sharpsburg silty clay loam, 2 to 5 percent slopes	24.43	47.8%		Ile	91	87	92	92	77	79
370C2	Sharpsburg silty clay loam, 5 to 9 percent slopes, eroded	11.47	22.4%		IIle	80	67	82	82	68	66
368	Macksburg silty clay loam, 0 to 2 percent slopes	10.67	20.9%		Iw	93	95	87	87	79	79
Y93D2	Shelby-Adair clay loams, dissected till plain, 9 to 14 percent slopes, eroded	2.61	5.1%		IIle	35		68	68	56	50
993D2	Armstrong-Gara loams, 9 to 14 percent slopes, moderately eroded	1.77	3.5%		IVe	23	20	67	67	53	48
Y69C2	Clearfield silty clay loam, dissected till plain, 5 to 9 percent slopes, eroded	0.19	0.4%		IIlw	56		66	66	63	59
Weighted Average					2.14	83.6	*-	*n 86.5	*n 86.5	*n 73.4	*n 73.5

**IA has updated the CSR values for each county to CSR2.

**IA has updated the CSR values for each county to CSR2.*- CSR weighted average cannot be calculated on the current soils data, use prior data version for csr values.

*n: The aggregation method is "Weighted Average using all components"

**IA has updated the CSR values for each county to CSR2.*- CSR weighted average cannot be calculated on the current soils data, use prior data version for csr values.*c: Using Capabilities Class Dominant Condition Aggregation Method