

Row Crop Soils Map

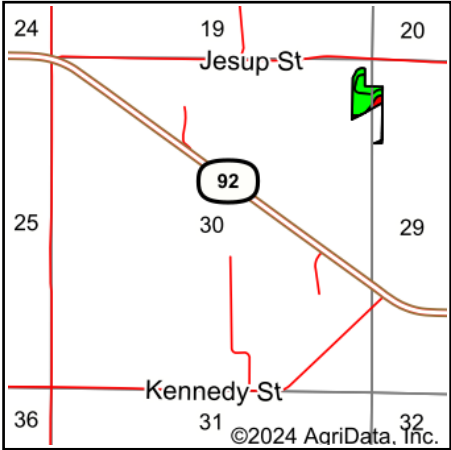

State: Iowa  
County: Warren  
Location: 30-76N-24W  
Township: Lincoln  
Acres: 5.69  
Date: 1/29/2024

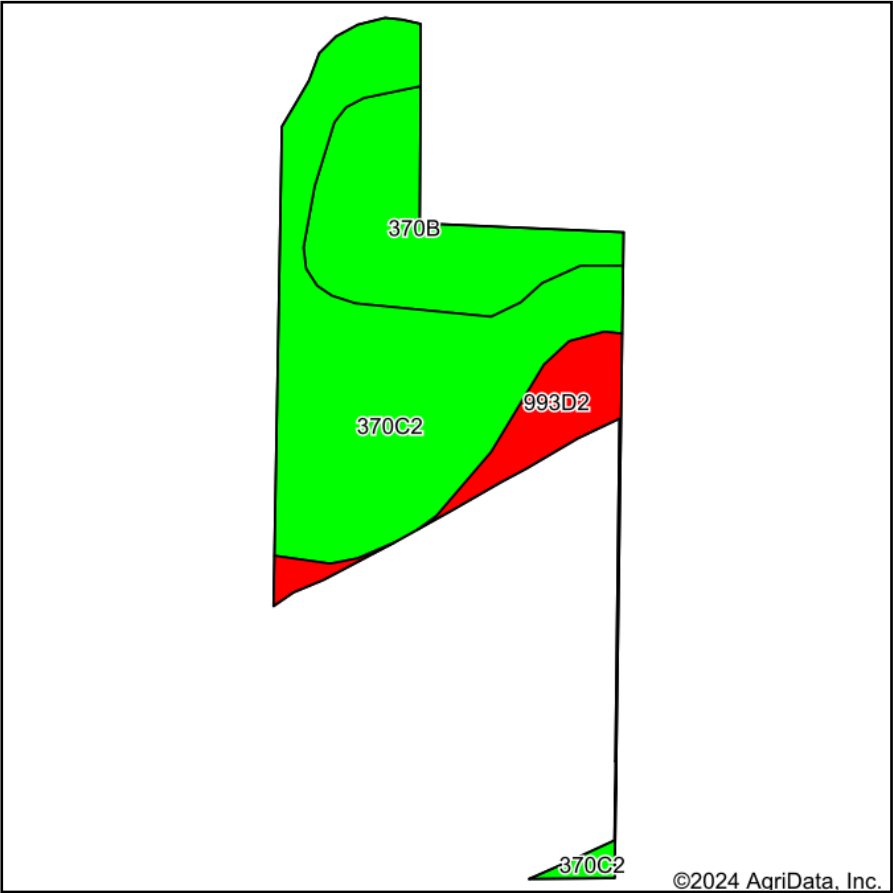

Soils data provided by USDA and NRCS.

Area Symbol: IA181, Soil Area Version: 29											
Code	Soil Description	Acres	Percent of field	CSR2 Legend	Non-Irr Class *c	CSR2**	CSR	*n NCCPI Overall	*n NCCPI Corn	*n NCCPI Small Grains	*n NCCPI Soybeans
370C2	Sharpsburg silty clay loam, 5 to 9 percent slopes, eroded	3.48	61.2%		IIIe	80	67	82	82	68	66
370B	Sharpsburg silty clay loam, 2 to 5 percent slopes	1.56	27.4%		Ile	91	87	92	92	77	79
993D2	Armstrong-Gara loams, 9 to 14 percent slopes, moderately eroded	0.65	11.4%		IVe	23	20	67	67	53	48
Weighted Average					2.84	76.5	67.1	*n 83	*n 83	*n 68.8	*n 67.5

\*\*IA has updated the CSR values for each county to CSR2.  
\*n: The aggregation method is "Weighted Average using all components"  
\*\*IA has updated the CSR values for each county to CSR2.\*c: Using Capabilities Class Dominant Condition Aggregation Method