

# Soils Map

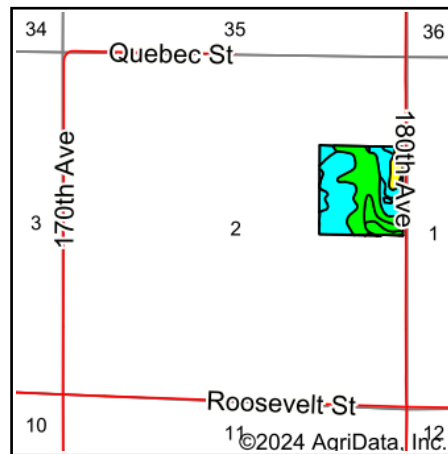
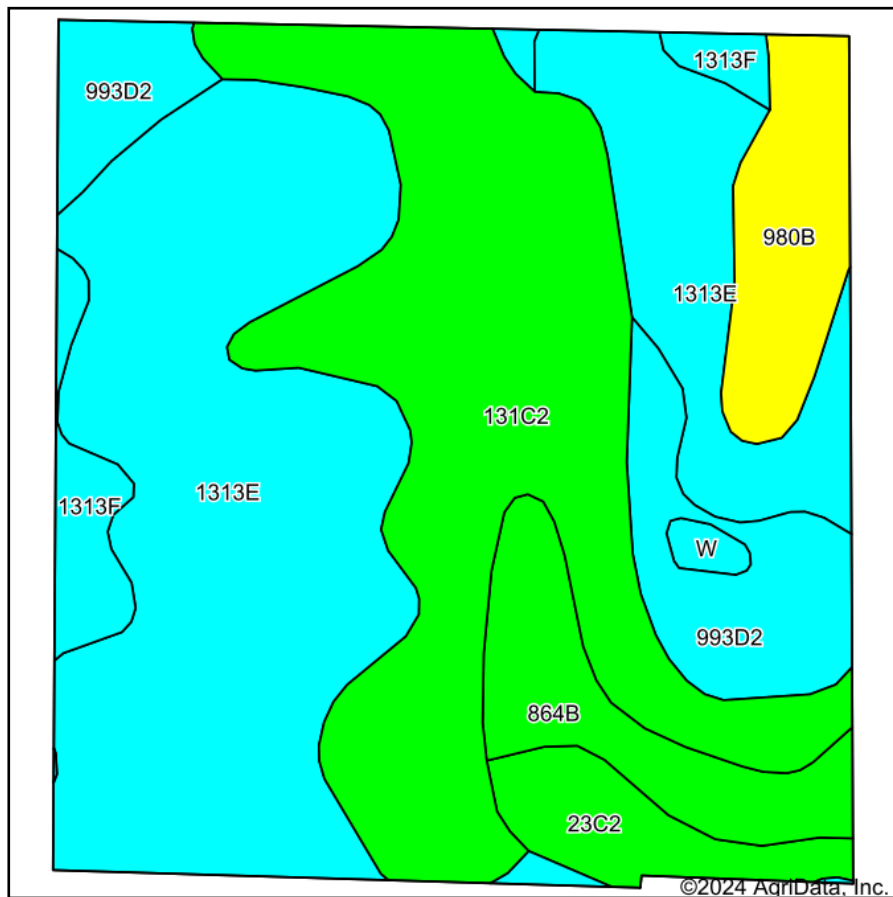

State: **Iowa**  
 County: **Warren**  
 Location: **2-74N-23W**  
 Township: **Liberty**  
 Acres: **41.26**  
 Date: **1/30/2024**

**Hawkeye Farm Mgmt & Real Estate**

**United Country Real Estate**  
 22 N Main, Albion IA Phone: 641-932-7796  
 Email: hawkeye@uciowa.com  
 On the web: www.uciowa.com  
 www.iowawhitetailfarms.com

Maps Provided By:  
**surety**  
 CUSTOMIZED ONLINE MAPPING  
 © AgriData, Inc. 2023 www.AgriDataInc.com



Area Symbol: IA181, Soil Area Version: 29

| Code             | Soil Description  | Acres | Percent of field | CSR2 Legend | Non-Irr Class *c | CSR2** | CSR  | *n NCCPI Corn | *n NCCPI Soybeans |
|------------------|---|-------|------------------|-------------|------------------|--------|------|---------------|-------------------|
| 1313E            | Munterville silt loam, 14 to 18 percent slopes                              | 17.25 | 41.8%            |             | Vlle             | 25     | 10   | 60            | 46                |
| 131C2            | Pershing silt loam, 5 to 9 percent slopes, moderately eroded                | 12.29 | 29.8%            |             | Ille             | 62     | 50   | 68            | 51                |
| 993D2            | Armstrong-Gara loams, 9 to 14 percent slopes, moderately eroded             | 3.73  | 9.0%             |             | IVe              | 23     | 20   | 67            | 48                |
| 864B             | Grundy silty clay loam, 2 to 5 percent slopes                               | 2.55  | 6.2%             |             | Ile              | 72     | 82   | 79            | 68                |
| 980B             | Gullied land-Ely-Colo, occasionally flooded, complex, 2 to 5 percent slopes | 2.38  | 5.8%             |             | Vlle             | 42     | 25   | 10            | 9                 |
| 23C2             | Arispe silty clay loam, 5 to 9 percent slopes, moderately eroded            | 1.56  | 3.8%             |             | Ille             | 62     | 62   | 73            | 68                |
| 1313F            | Munterville silt loam, 18 to 35 percent slopes                              | 1.29  | 3.1%             |             | Vlle             | 5      | 5    | 18            | 9                 |
| W                | Water   | 0.21  | 0.5%             |             |                  | 0      | 0    |               |                   |
| Weighted Average |   |       |                  |             | *-               | 40.4   | 29.9 | *n 60.2       | *n 46.3           |

\*\*IA has updated the CSR values for each county to CSR2.

\*n: The aggregation method is "Weighted Average using all components"

\*\*IA has updated the CSR values for each county to CSR2.\*c: Using Capabilities Class Dominant Condition Aggregation Method

\*\*IA has updated the CSR values for each county to CSR2.\*c: Using Capabilities Class Dominant Condition Aggregation Method\*- Non Irr Class weighted average cannot be calculated on the current soils data due to missing data.