

# Tillable Soils Map

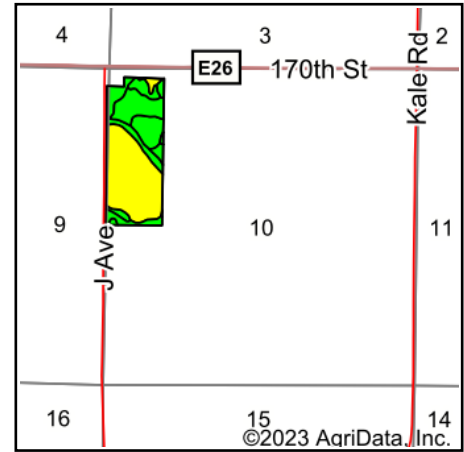

State: **Iowa**  
 County: **Boone**  
 Location: **10-84N-27W**  
 Township: **Yell**  
 Acres: **52.81**  
 Date: **11/12/2023**

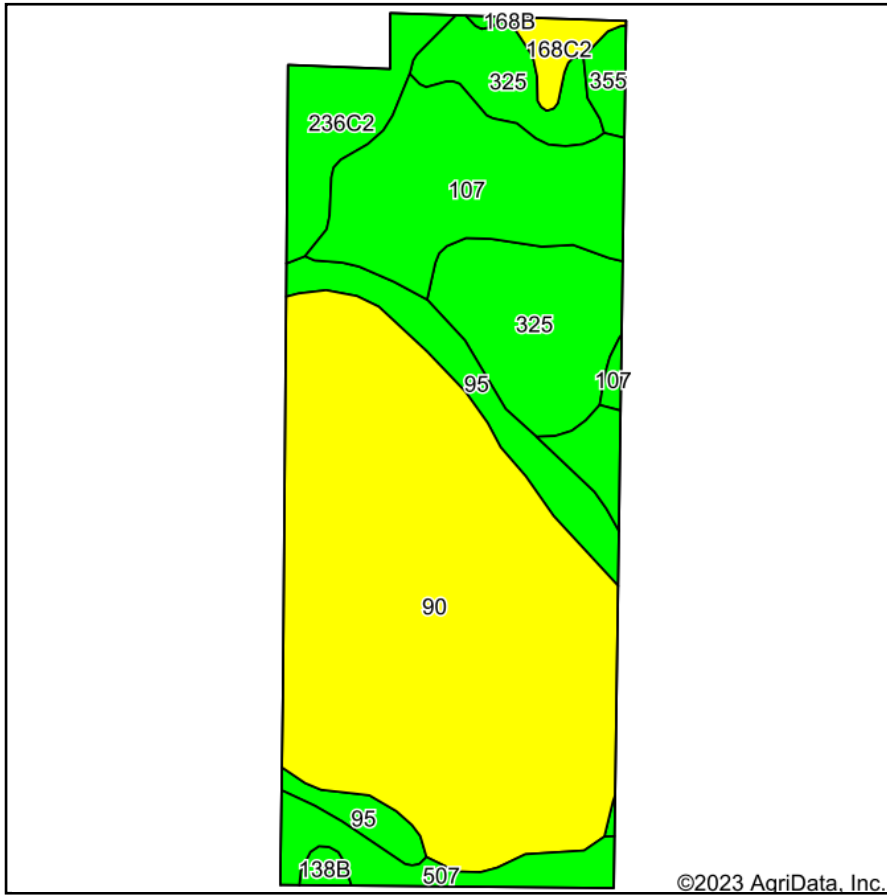

Maps Provided By:



Area Symbol: IA015, Soil Area Version: 31

Code	Soil Description	Acres	Percent of field	CSR2 Legend	Non-Irr Class *c	CSR2**	CSR	*n NCCPI Overall	*n NCCPI Corn	*n NCCPI Soybeans
90	Okoboji mucky silt loam, 0 to 1 percent slopes	26.51	50.2%		IIIw	56	61	72	68	72
107	Webster clay loam, 0 to 2 percent slopes	7.58	14.4%		IIw	86	87	83	78	82
325	Le Sueur loam, 1 to 3 percent slopes	7.31	13.8%		Iw	77	87	90	90	84
95	Harps clay loam, 0 to 2 percent slopes	3.75	7.1%		IIw	72	64	82	70	82
507	Canisteo clay loam, 0 to 2 percent slopes	3.08	5.8%		IIw	84	82	81	71	81
236C2	Lester loam, 6 to 10 percent slopes, moderately eroded	2.84	5.4%		IIIe	76	62	77	77	69
168C2	Hayden loam, 6 to 10 percent slopes, moderately eroded	0.82	1.6%		IIIe	70	56	81	81	70
355	Luther loam, 0 to 2 percent slopes	0.64	1.2%		Iw	84	82	85	85	73
138B	Clarion loam, 2 to 6 percent slopes	0.28	0.5%		Ile	89	84	83	78	83
Weighted Average					2.42	67.8	70.1	*n 77.9	*n 73.7	*n 76.2

\*\*IA has updated the CSR values for each county to CSR2.

\*n: The aggregation method is "Weighted Average using all components"

\*c: Using Capabilities Class Dominant Condition Aggregation Method

Soils data provided by USDA and NRCS.