

Current Tillable Soils Map

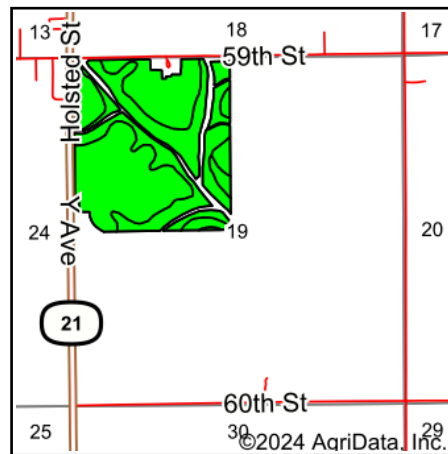

Soils data provided by USDA and NRCS.



State: **Iowa**
 County: **Benton**
 Location: **19-85N-12W**
 Township: **Monroe**
 Acres: **125.8**
 Date: **2/29/2024**



Maps Provided By:



© AgriData, Inc. 2023

www.AgriDataInc.com



Area Symbol: IA011, Soil Area Version: 26

Code	Soil Description	Acres	Percent of field	CSR2 Legend	Non-Irr Class *c	*i Corn Bu	*i Soybeans Bu	CSR2**	CSR	*n NCCPI Overall
120B	Tama silty clay loam, 2 to 5 percent slopes	75.69	60.2%		Ile	232.0	67.3	95	95	96
11B	Colo-Ely complex, 0 to 5 percent slopes	47.83	38.0%		Ilw	80.0	23.2	86	68	92
119B	Muscataine silty clay loam, 2 to 5 percent slopes	2.04	1.6%		Ile	232.0	67.3	95	95	95
377C	Dinsdale silty clay loam, 5 to 9 percent slopes	0.24	0.2%		IIle	216.0	62.6	90	75	86
Weighted Average					2.00	174.2	50.5	91.6	84.7	*n 94.4

**IA has updated the CSR values for each county to CSR2.

*i Yield data provided by the ISPAID Database version 8.1.1 developed by IA State University.

*n: The aggregation method is "Weighted Average using all components"

*c: Using Capabilities Class Dominant Condition Aggregation Method

Soils data provided by USDA and NRCS.