

# Soils Map

Boundary Lines Are Approximate

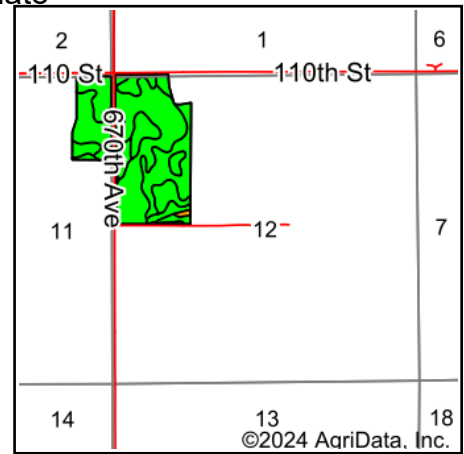
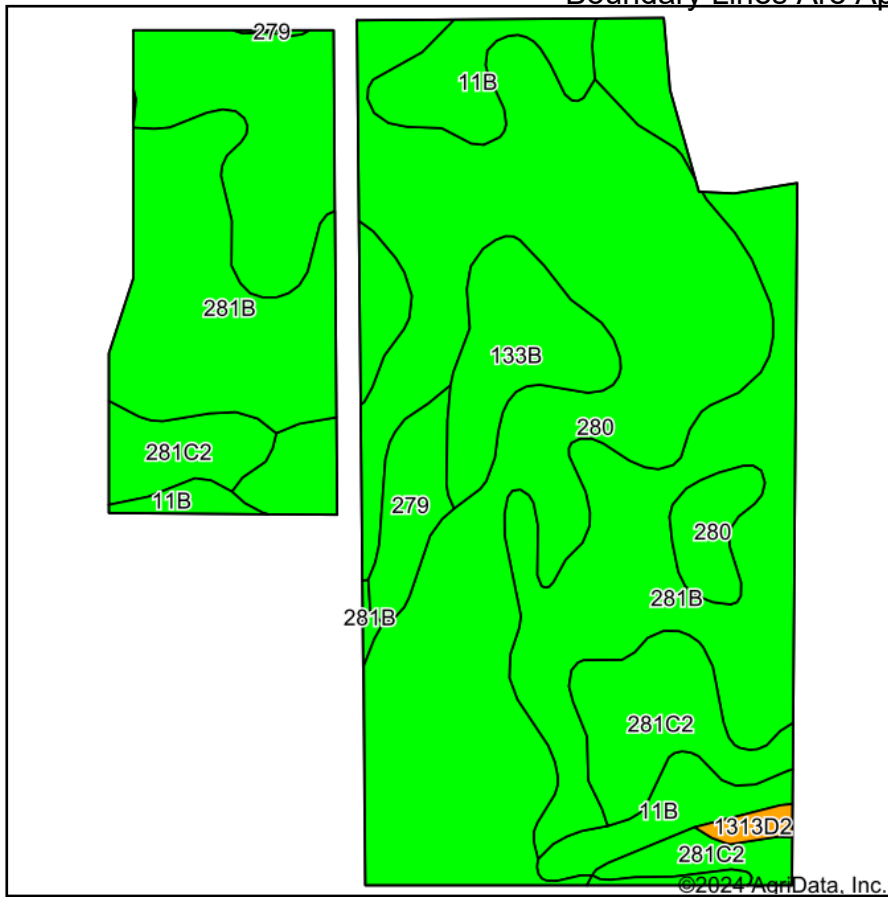

State: **Iowa**  
 County: **Monroe**  
 Location: **12-73N-17W**  
 Township: **Bluff Creek**  
 Acres: **93**  
 Date: **3/14/2024**

**Hawkeye Farm Mgmt & Real Estate**

**United Country Real Estate**  
 22 N Main, Albion IA Phone: 641-932-7796  
 Email: hawkeye@uciowa.com  
 On the web: www.uciowa.com  
 www.iowawhitehallfarms.com

Maps Provided By:  
**surety**  
 CUSTOMIZED ONLINE MAPPING  
 © AgriData, Inc. 2023 www.AgriDataInc.com



Soils data provided by USDA and NRCS.

Area Symbol: IA135, Soil Area Version: 31									
Code	Soil Description	Acres	Percent of field	CSR2 Legend	Non-Irr Class *c	CSR2**	CSR	*n NCCPI Corn	*n NCCPI Soybeans
280	Mahaska silty clay loam, 0 to 2 percent slopes	43.99	47.3%		Iw	94	95	87	78
281B	Otley silty clay loam, 2 to 5 percent slopes	27.37	29.4%		Ile	91	90	89	77
281C2	Otley silty clay loam, 5 to 9 percent slopes, eroded	8.18	8.8%		IIle	82	70	83	65
11B	Colo-Ely complex, 0 to 5 percent slopes	6.05	6.5%		IIw	86	63	92	76
133B	Colo silty clay loam, 2 to 5 percent slopes	4.61	5.0%		IIw	69	75	85	72
279	Taintor silt loam, 0 to 2 percent slopes	2.32	2.5%		IIw	83	88	82	70
1313D2	Munterville silt loam, 9 to 14 percent slopes, moderately eroded	0.48	0.5%		VIle	34	10	59	42
Weighted Average					1.64	89.7	87.6	*n 87.2	*n 75.7

\*\*IA has updated the CSR values for each county to CSR2.

\*n: The aggregation method is "Weighted Average using all components"

\*c: Using Capabilities Class Dominant Condition Aggregation Method

Soils data provided by USDA and NRCS.