

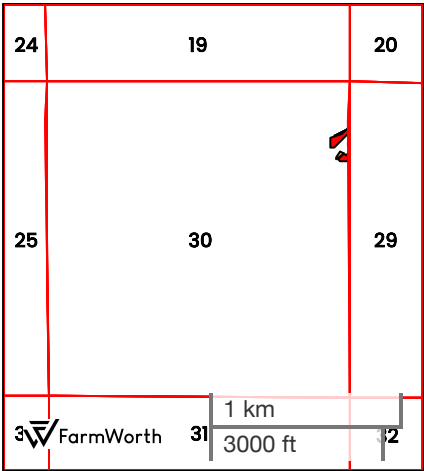

LUHRS 9.13 ACRE BUILDING SITE (9.13 AC TOTAL, 4.71 AC TILLABLE)

CRP SOILS

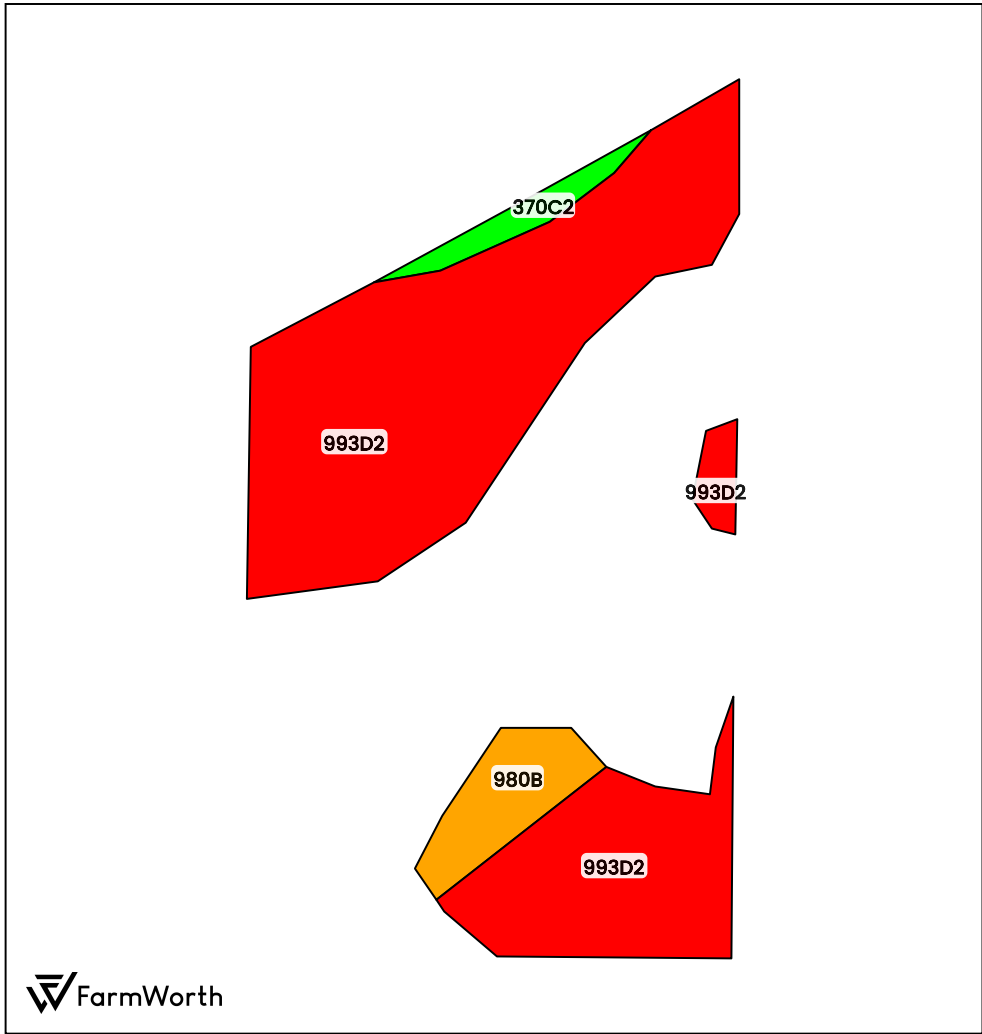

County: **Warren County, IA**
Location: **30-76N-24W**
Township: **Lincoln**
Acres: **1.61**
Date: **04/10/2024**



Field borders obtained from Farm Service Agency as of 2008

FarmWorth, LLC makes no representations or warranties, express or implied, as to the accuracy of any information, data, numerical values, boundaries, or any other information generated through the use of FarmWorth.com. User is solely responsible for independently investigating and determining all information provided through FarmWorth.com prior to use and waives any and all claims against FarmWorth, LLC for any inaccuracies or inconsistencies in the information and/or data.

Code	Description	Acres	% of field	IA CSR2	Overall NCCPI	Soil Class (Irr)	Soil Class (Non-Irr)	Drainage Class
993D2	Armstrong-Gara loams, 9 to 14 percent slopes, moderately eroded	1.41	87.58 %	23	70	-	4	Somewhat poorly drained
980B	Gullied land-Ely-Colo, occasionally flooded, complex, 2 to 5 percent slopes	0.14	8.70 %	42	4	-	7	Well drained
370C2	Sharpsburg silty clay loam, 5 to 9 percent slopes, eroded	0.06	3.73 %	80	82	-	3	Moderately well drained
Average:				26.8	64.7			

IA has updated the CSR values for each county to CSR2.
Soils data provided by USDA and NRCS.