

# Soils Map

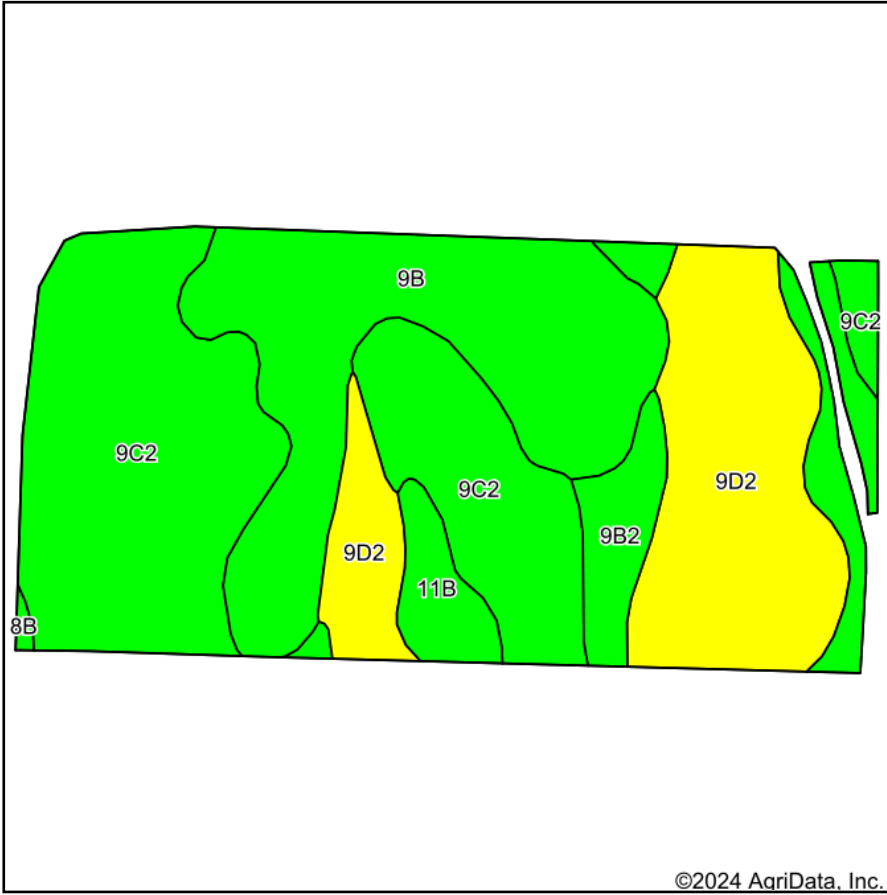

Soils data provided by USDA and NRCS.

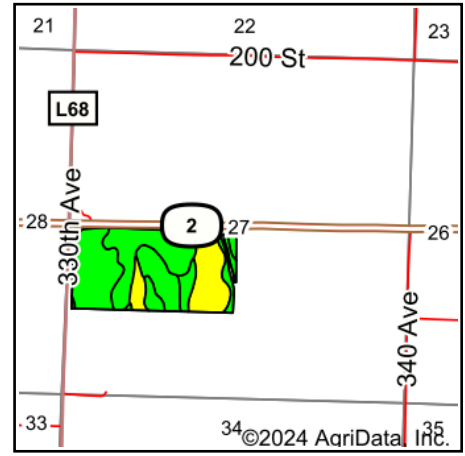

State: **Iowa**  
 County: **Fremont**  
 Location: **27-69N-41W**  
 Township: **Prairie**  
 Acres: **70.25**  
 Date: **2/21/2024**



Maps Provided By:



© AgriData, Inc. 2023

www.AgriDataInc.com



Area Symbol: IA071, Soil Area Version: 30

Code	Soil Description	Acres	Percent of field	CSR2 Legend	Non-Irr Class *c	CSR2**	CSR	*n NCCPI Overall	*n NCCPI Corn	*n NCCPI Small Grains	*n NCCPI Soybeans	
9C2	Marshall silty clay loam, 5 to 9 percent slopes, eroded	27.27	38.8%		IIIe	87	68	90	90	68	70	
9B	Marshall silty clay loam, 2 to 5 percent slopes	18.06	25.7%		Ile	95	85	89	89	74	77	
9D2	Marshall silty clay loam, 9 to 14 percent slopes, eroded	16.73	23.8%		IIIe	61	58	85	85	65	65	
11B	Colo-Judson silty clay loams, 0 to 5 percent slopes, occasionally flooded	5.23	7.4%		IIw	80	68	87	85	51	81	
9B2	Marshall silty clay loam, 2 to 5 percent slopes, eroded	2.80	4.0%		Ile	92	83	91	91	69	71	
8B	Judson silty clay loam, deep loess, 2 to 5 percent slopes	0.16	0.2%		Ile	92	84	95	95	75	80	
<b>Weighted Average</b>						<b>2.63</b>	<b>82.6</b>	<b>70.6</b>	<b>*n 88.4</b>	<b>*n 88.2</b>	<b>*n 67.6</b>	<b>*n 71.5</b>

\*\*IA has updated the CSR values for each county to CSR2.

\*n: The aggregation method is "Weighted Average using all components"

\*c: Using Capabilities Class Dominant Condition Aggregation Method

Soils data provided by USDA and NRCS.