

Total Soils Map

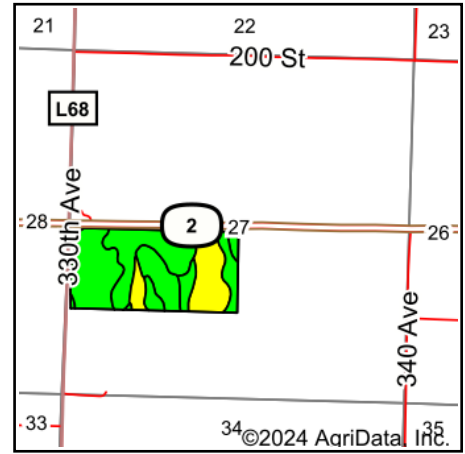

State: **Iowa**
 County: **Fremont**
 Location: **27-69N-41W**
 Township: **Prairie**
 Acres: **72.6**
 Date: **2/21/2024**

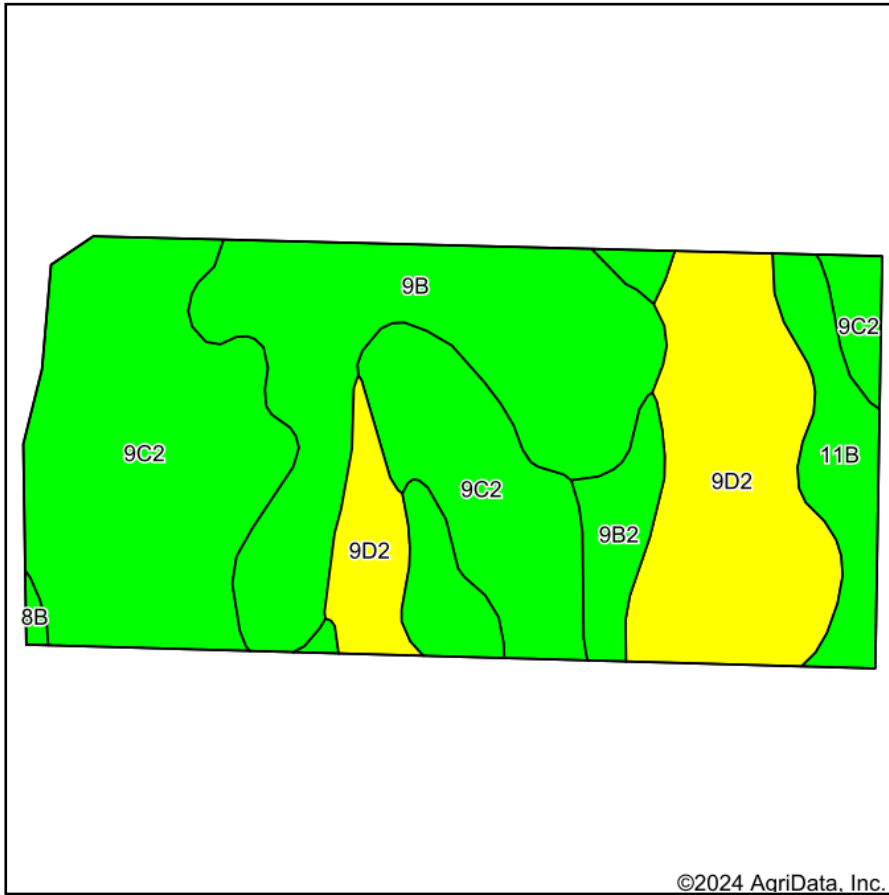

Maps Provided By:



Soils data provided by USDA and NRCS.

Area Symbol: IA071, Soil Area Version: 30

Code	Soil Description	Acres	Percent of field	CSR2 Legend	Non-Irr Class *c	CSR2**	CSR	*n NCCPI Overall	*n NCCPI Corn	*n NCCPI Small Grains	*n NCCPI Soybeans	
9C2	Marshall silty clay loam, 5 to 9 percent slopes, eroded	28.19	38.8%		IIIe	87	68	90	90	68	70	
9B	Marshall silty clay loam, 2 to 5 percent slopes	17.83	24.6%		Ile	95	85	89	89	74	77	
9D2	Marshall silty clay loam, 9 to 14 percent slopes, eroded	16.69	23.0%		IIIe	61	58	85	85	65	65	
11B	Colo-Judson silty clay loams, 0 to 5 percent slopes, occasionally flooded	6.86	9.4%		IIw	80	68	87	85	51	81	
9B2	Marshall silty clay loam, 2 to 5 percent slopes, eroded	2.80	3.9%		Ile	92	83	91	91	69	71	
8B	Judson silty clay loam, deep loess, 2 to 5 percent slopes	0.23	0.3%		Ile	92	84	95	95	75	80	
Weighted Average						2.62	82.5	70.5	*n 88.4	*n 88.2	*n 67.2	*n 71.7

**IA has updated the CSR values for each county to CSR2.

*n: The aggregation method is "Weighted Average using all components"

*c: Using Capabilities Class Dominant Condition Aggregation Method

Soils data provided by USDA and NRCS.