

# Total Soils Map

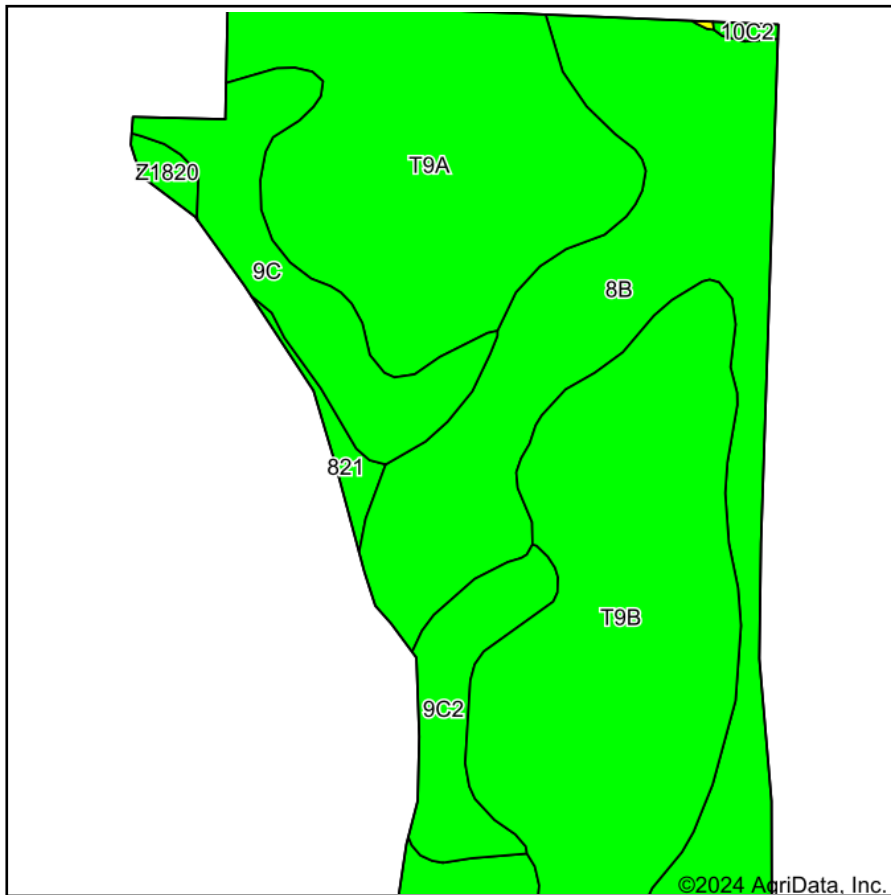

Soils data provided by USDA and NRCS.

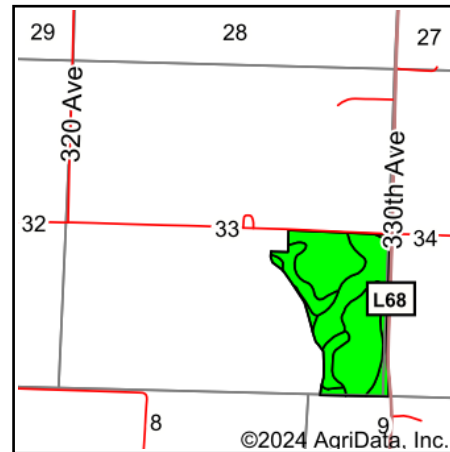

State: **Iowa**  
 County: **Fremont**  
 Location: **33-69N-41W**  
 Township: **Prairie**  
 Acres: **82.17**  
 Date: **2/21/2024**



Maps Provided By:



© AgriData, Inc. 2023

www.AgriDataInc.com



Area Symbol: IA071, Soil Area Version: 30

Code	Soil Description	Acres	Percent of field	CSR2 Legend	Non-Irr Class *c	CSR2**	CSR	*n NCCPI Overall	*n NCCPI Corn	*n NCCPI Small Grains	*n NCCPI Soybeans	
8B	Judson silty clay loam, deep loess, 2 to 5 percent slopes	24.90	30.3%		lle	92	84	95	95	75	80	
T9B	Marshall silty clay loam, terrace, 2 to 5 percent slopes	23.80	29.0%		lle	94	85	96	96	79	82	
T9A	Marshall silty clay loam, terrace, 0 to 2 percent slopes	20.20	24.6%		le	99	90	97	97	80	84	
9C	Marshall silty clay loam, 5 to 9 percent slopes	7.30	8.9%		llle	89	70	95	95	75	81	
9C2	Marshall silty clay loam, 5 to 9 percent slopes, eroded	4.31	5.2%		llle	87	68	90	90	68	70	
821	Dockery silty clay loam	0.86	1.0%		llw	87	80	83	81	47	77	
Z1820	Dockery-Quiver silt loams, deep loess, 0 to 2 percent slopes, occasionally flooded	0.60	0.7%		llw	87		93	84	49	92	
10C2	Monona silt loam, 5 to 9 percent slopes, eroded	0.20	0.2%		llle	86	63	81	81	72	76	
<b>Weighted Average</b>						<b>1.90</b>	<b>93.7</b>	<b>*-</b>	<b>*n 95.3</b>	<b>*n 95.3</b>	<b>*n 76.5</b>	<b>*n 81.2</b>

\*\*IA has updated the CSR values for each county to CSR2.

\*- CSR weighted average cannot be calculated on the current soils data, use prior data version for csr values.

\*n: The aggregation method is "Weighted Average using all components"

\*c: Using Capabilities Class Dominant Condition Aggregation Method

Soils data provided by USDA and NRCS.