

Soils Map

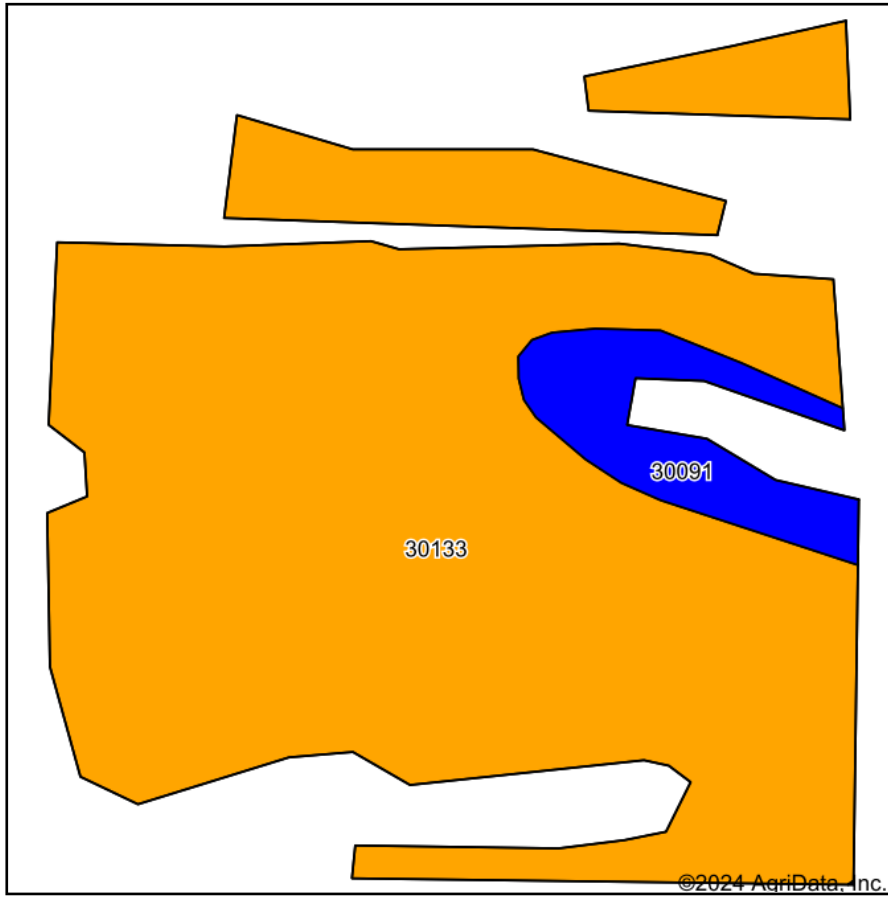

Soils data provided by USDA and NRCS.

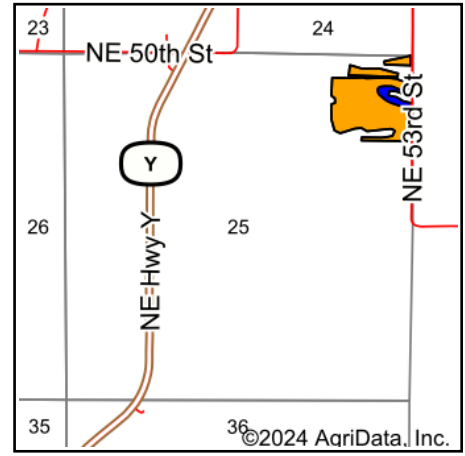

State: **Missouri**
 County: **Grundy**
 Location: **25-62N-24W**
 Township: **Lincoln**
 Acres: **25.59**
 Date: **6/11/2024**



Maps Provided By:



Area Symbol: MO079, Soil Area Version: 27

Code	Soil Description	Acres	Percent of field	Non-Irr Class Legend	Non-Irr Class *c	*n NCCPI Overall	*n NCCPI Corn	*n NCCPI Small Grains	*n NCCPI Soybeans
30133	Lamoni clay loam, 5 to 9 percent slopes, eroded	23.74	92.8%		IIIe	59	59	53	47
30091	Grundy silty clay loam, 2 to 5 percent slopes, moderately eroded	1.85	7.2%		Ile	74	74	61	65
Weighted Average					2.93	*n 60.1	*n 60.1	*n 53.6	*n 48.3

*n: The aggregation method is "Weighted Average using all components"

*c: Using Capabilities Class Dominant Condition Aggregation Method