

BOUNDARY SURVEY FOR SIMPSON TIMBER

LOCATED IN THE SW 1/4 OF SEC. 18 AND NW 1/4 OF SEC. 19, T11S, R10W, W.M.
LINCOLN COUNTY, OREGON (11-10-19 TL 402, 403, 404)
(11-10-18-C TL 700)

SHEET 1 OF 2

CS. # 14565
FILED 08 Sept. 1994
LINCOLN COUNTY SURVEYOR

JULY 10, 1994

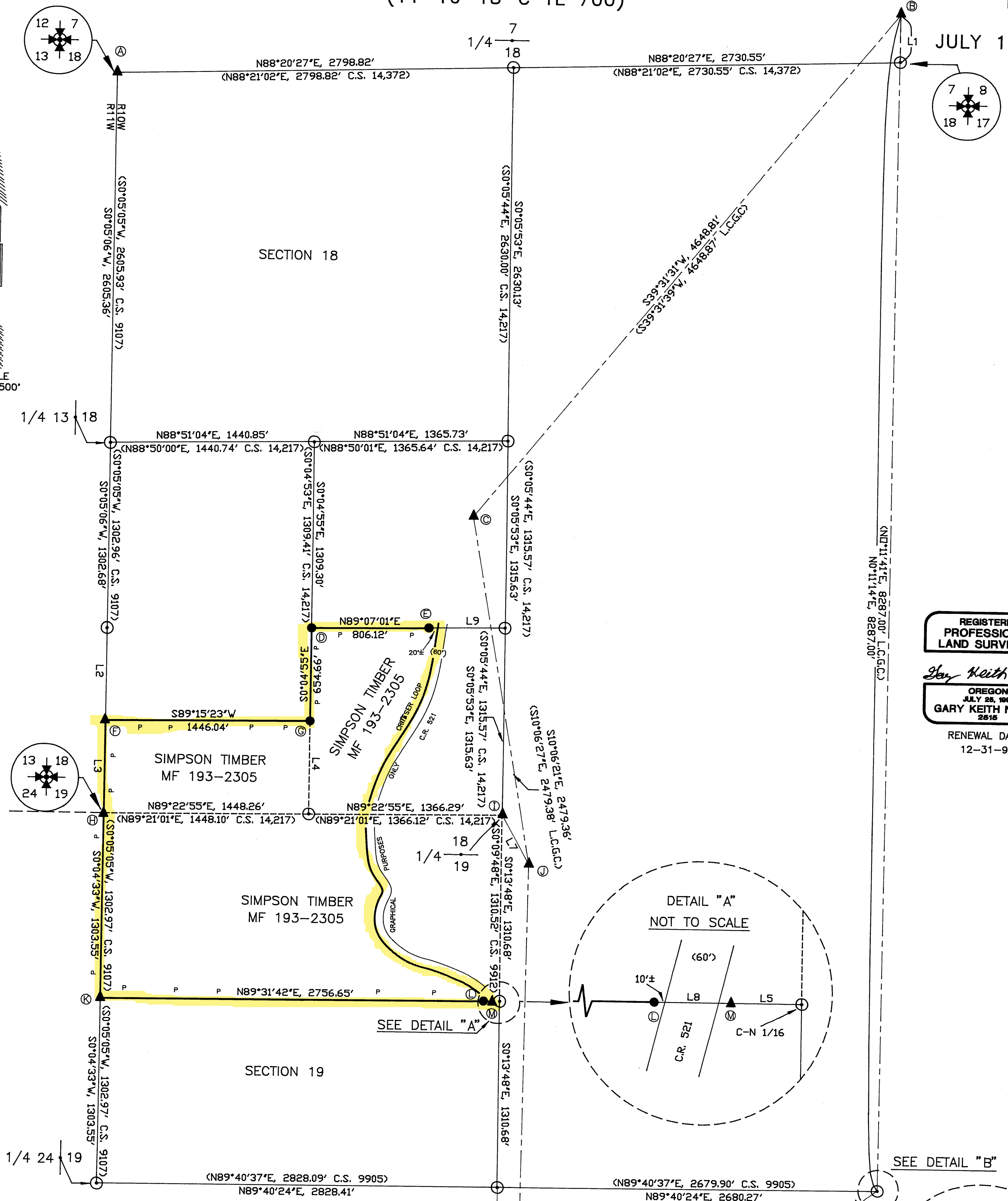
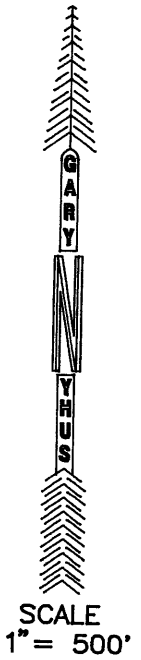

REGISTERED
PROFESSIONAL
LAND SURVEYOR

GARY KEITH NYHUS
JULY 25, 1991
RENEWAL DATE:
12-31-94

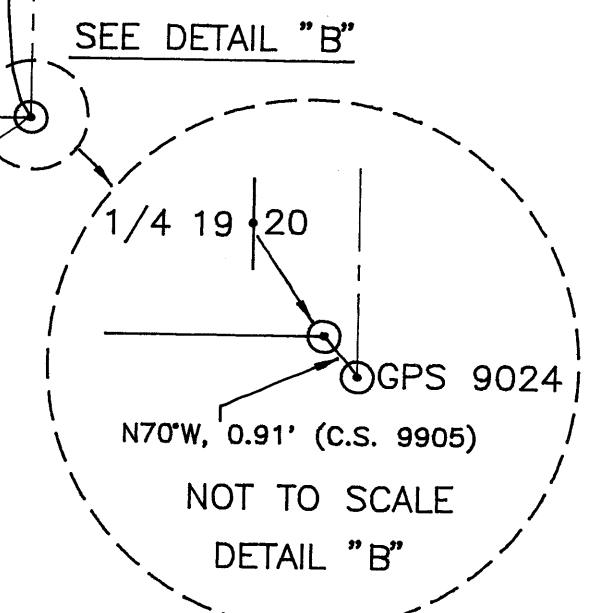
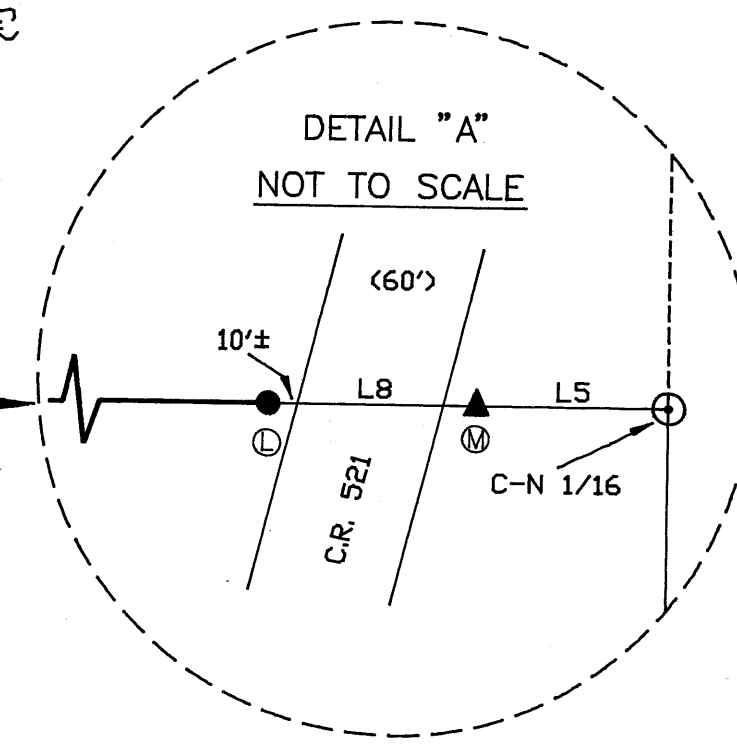

LINE TABLE

MEASURED	RECORD
L1 S0°17'26"E 340.16'	(S0°16'51"E 340.16' C.S. 14,372)
L2 S0°03'16"W 651.16'	(S0°05'05"W 651.48' C.S. 9107)
L3 S0°06'57"W 651.52'	(S0°05'05"W 651.48' C.S. 9107)
L4 N0°04'55"W 654.66'	
L5 N89°30'44"E 64.81'	(N89°36'20"E 65.0' C.S. 9912)
L6 S77°46'09"E 130.49'	(S77°46'22"E 130.48' L.C.G.C.)
L7 N29°24'50"W 397.33'	(N29°24'14"W 397.31' L.C.G.C.)
L8 N89°31'42"E 59.64'	
L9 N89°07'01"E 559.87'	

LEGEND

- ▲ MONUMENT FOUND HELD FOR CONTROL AS NOTED
- MONUMENT SET AS NOTED IN MONUMENT DESCRIPTIONS
- CALCULATED POSITION ONLY
- () DENOTES RECORD INFORMATION AS NOTED
- L.C.G.C. LINCOLN COUNTY GEODETIC CONTROL
- P P BOUNDARY LINES BLAZED AND MARKED WITH "SIMPSON" TAGS

NYHUS SURVEYING INC.
—GARY NYHUS—
740 E. THISSELL RD. TIDEWATER, ORE 97390
(503) 528-3234

CHECKED BY: GKN
DRAWN BY: GAM
DATE: 7/10/94
SCALE: 1"=500'
PROJECT: 94053

COMPUTER DRAFTING BY: GM MAPPING (503) 528-7062 TIDEWATER, ORE. 97390

BOUNDARY SURVEY FOR SIMPSON TIMBER
LOCATED IN THE SW 1/4 OF SEC. 18 AND NW 1/4 OF SEC. 19, T11S, R10W, W.M.
LINCOLN COUNTY, OREGON

SHEET 2 OF 2

JULY 10, 1994

(11-10-19 TL 402, 403, 404)
(11-10-18-C TL 700)

CS. # 14565
FILED 08 Sept. 1994
LINCOLN COUNTY SURVEYOR

NARRATIVE

THE PURPOSE OF THIS SURVEY IS TO LOCATE AND MARK THE BOUNDARIES OF THE SIMPSON TIMBER COMPANY PROPERTY LOCATED IN THE SOUTHWEST 1/4 OF SECTION 18 AND THE NORTHWEST 1/4 OF SECTION 19, T11S, R10W, WM AS DESCRIBED IN MICROFILM VOLUME 193, PAGE 2305 LINCOLN COUNTY MICROFILM RECORDS. I BEGAN THIS SURVEY BY RECOVERING AND VERIFYING CONTROL TRAVERSE POINTS ESTABLISHED BY THIS FIRM ALONG THE NORTH LINE OF SECTION 18 DURING C.S. 14,372. NEXT A RANDOM CONTROL TRAVERSE WAS RUN FROM THESE POINTS ALONG COUNTY ROADS 515 & 521 THRU LINCOLN COUNTY GEODETIC STATIONS 9025 AND 9020. I HELD THE RECORD GEODETIC BEARING BETWEEN SAID STATIONS FOR BASIS OF BEARING AS SHOWN ON THE ACCOMPANYING PLAT. I THEN RAN A CLOSED LOOP RANDOM TRAVERSE FROM THE AFORESAID CONTROL TRAVERSE ALONG THE SIMPSON BOUNDARY IN THE SW 1/4 SECTION 18 AND NW 1/4 SECTION 19. I FOUND AND HELD MONUMENTS ESTABLISHED IN C.S. 9107 AT (F), (H) AND (K) AS SHOWN IN THE ACCOMPANYING MONUMENT DESCRIPTIONS. I THEN SUBDIVIDED SECTIONS 18 & 19 ACCORDING TO THE 1973 BLM MANUAL OF SURVEYING INSTRUCTIONS. THE WEST 1/4 OF SECTION 18 WAS CALCULATED AT MIDPOINT BETWEEN (A) AND (H) AS PER C.S. 9107. I THEN CALCULATED THE CENTER 1/4 OF SECTION 18 BY PROPORTIONING AGAINST THE C.S. 14,217 RECORD ALONG THE N-S CENTERLINE. I THEN SUBDIVIDED THE SW 1/4 AS SHOWN.

THE EAST 1/4 OF SECTION 19 WAS CALCULATED USING A RECORD DISTANCE-DISTANCE INTERSECTION FROM CONTROL STATIONS 8932 (B) AND 9020 (C). THE WEST 1/4 CORNER WAS CALCULATED BY PROJECTING AN EQUIDISTANT LINE FROM (H) THRU (K). I THEN SUBDIVIDED SECTION 19 AS SHOWN AND AGREED CLOSELY WITH RECORD INFORMATION FROM C.S. 9905. THE C.S. 9912 MONUMENT (M) WAS HELD TO CONTROL THE ALIGNMENT OF THE E-W CENTERLINE OF THE NW 1/4 AS IT FIT VERY WELL WITH MY CALCULATED LINE. THE CORNERS OF THE SIMPSON TIMBER PARCEL WERE THEN MONUMENTED AS NOTED. (E) AND (L) WERE SET AS REFERENCE POINTS ON LINE AND ARE NOT ON THE COUNTY ROAD 521 RIGHT-OF-WAY WHICH WAS NOT DETERMINED IN THIS SURVEY. THE SIMPSON BOUNDARIES WERE MARKED WITH ORANGE PAINTED BLAZES AND "SIMPSON TIMBER COMPANY" TAGS. THIS SURVEY WAS PERFORMED WITH A WILD T1610 (1.5") THEODOLITE AND DI 1600 (2MM±3PPM) EDM.

MONUMENT DESCRIPTIONS

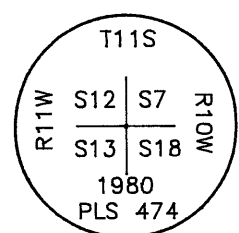

- (A) NORTHWEST CORNER SECTION 18
FOUND: A 2" BRASS CAP, MARKED AS SHOWN, 0.2' ABOVE GRADE (C.S. 9107)
- (B) GPS 8932
FOUND: A NAIL IN A 1" IRON PIPE, 0.7' BELOW GRADE IN A WATER VALVE BOX (LINCOLN COUNTY GEODETIC RECORDS)

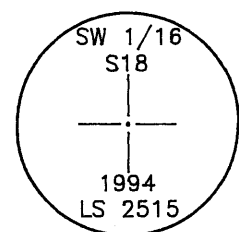

- (C) GPS 5161
FOUND: A RAILROAD SPIKE IN ASPHALT, FLUSH (LINCOLN COUNTY GEODETIC RECORDS)
- (D) SOUTHWEST 1/16 CORNER SECTION 18, T11S, R10W, W.M.
FOUND: 5/8" RE-BAR WITH A YELLOW PLASTIC CAP MARKED "LS 1908", 0.3' ABOVE GRADE, BEARS N39 1/2°W, 4.05' (C.S. 13,307)
SET: A 1 1/2" GALVANIZED IRON PIPE WITH A 2 1/2" BRASS CAP MARKED AS SHOWN, 0.3' ABOVE GRADE, FROM WHICH;
A 26" MAPLE WITH AN "X" CHOPPED ON THE BARK AND "BT" SCRIBED ON A LOW BLAZE, BEARS N2°W, 39.2'
- (E) WITNESS POINT ON THE EAST WEST CENTERLINE OF THE SW 1/4 OF SECTION 18
NEW: SET A 5/8" X 30" RE-BAR WITH A YELLOW PLASTIC CAP MARKED "NYHUS LS 2515", FROM WHICH;
A 4" ALDER, BARK SCRIBED "XBT", BEARS N12°E, 9.5'
A 2" FIR, SCRIBED "XBT" ON A DOUBLE BLAZE, BEARS S10 1/2°W, 31.9'

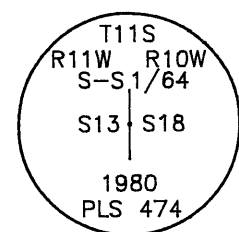

- (F) SOUTH-SOUTH 1/64 CORNER TO SECTION 18, T11S, R10W AND SECTION 13, T11S, R11W, W.M.
FOUND: A FIRMLY SET 2" GALVANIZED IRON PIPE, WITH A 2" BRASS CAP, MARKED AS SHOWN, (C.S. 9107) FROM WHICH;
A 26" MAPLE, WITH A HEALED DOUBLE BLAZE, BEARS N78°E, 14.8' (C.S. 9107)
NEW: A 25" DOUBLE ALDER, BARK SCRIBED "S-S 1/64 S18 BT", BEARS N23°E, 22.3'

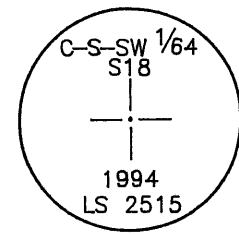

- (G) CENTER-SOUTH-SOUTHWEST 1/64 CORNER, SECTION 18
NEW: SET A 1 1/2" X 30" GALVANIZED IRON PIPE WITH A 2 1/2" BRASS CAP, MARKED AS SHOWN 0.4' ABOVE GRADE, FROM WHICH;
A 10" FIR, SCRIBED "C-S-SW 1/64 S18 BT" ON A DOUBLE BLAZE, BEARS N14°W, 27.9'
A 48" FIR, SCRIBED "C-S-SW 1/64 S18 BT" ON A DOUBLE BLAZE, BEARS N87°W, 173.6'

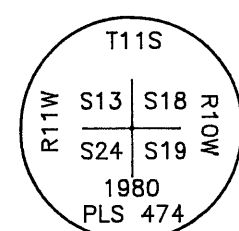

- (H) CORNER TO SECTIONS 18 AND 19, T11S, R10W AND SECTIONS 13 AND 24, T11S, R11W, W.M.
FOUND: A 2" GALVANIZED IRON PIPE, FIRMLY SET IN CONCRETE WITH A 2" BRASS CAP MARKED AS SHOWN, 0.4' ABOVE GRADE (C.S. 9107) FROM WHICH;
A LEANING 18" ALDER, WITH BARK SCRIBING "T11S R11W S24 BT" VISIBLE, BEARS S29°W, 19.1' (C.S. 9107)
A 48" FIR, WITH A HEALED DOUBLE BLAZE, BEARS S43°E, 24.1' (C.S. 9107)
A ROTHOLE WITH A 30" ALDER WINDFALL, WITH BARK SCRIBING "T11S R10W S18 BT" VISIBLE LAYING ALONGSIDE, BEARS N44°E, 12.8' (C.S. 9107)
A 30" ALDER STUMP, 1.5' HIGH, WITH NO MARKS VISIBLE, BEARS N29°W, 43.0' (C.S. 9107)
NEW: A LEANING 9" MAPLE, SCRIBED "T11S R11W S13 BT" ON A DOUBLE BLAZE, BEARS N10°W, 46.9'
A 26" ALDER, BARK SCRIBED "T11S R10W S18 BT", BEARS N38°E, 47.8'

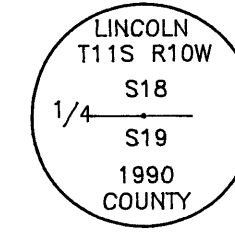

- (I) 1/4 CORNER TO SECTIONS 18 AND 19
FOUND: A 2" ALUMINUM CAP MARKED AS SHOWN, 0.2' ABOVE GRADE (AS PER C.S. 12,886)
- (J) GPS 9025
FOUND: A 1/2" RE-BAR WITH A YELLOW PLASTIC CAP MARKED "COUNTY GPS REF.", FLUSH (LINCOLN COUNTY GEODETIC RECORDS)

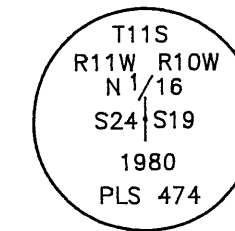

- (K) NORTH 1/16 CORNER TO SECTION 19, T11S, R10W, W.M. AND SECTION 24, T11S, R11W, W.M.
FOUND: A 2" GALVANIZED IRON PIPE WITH A 2" BRASS CAP MARKED AS SHOWN, 0.9' ABOVE GRADE (C.S. 9107), FROM WHICH;
A 26" HEMLOCK, WITH SCRIBING "N 1/16 S24 BT" VISIBLE ON A PARTIALLY HEALED DOUBLE BLAZE, BEARS N24 1/2°W, 38.4' (C.S. 9107)
A 24" ALDER SNAG, 50' TALL, WITH BARK SCRIBING "N1/16 S19 BT" VISIBLE, BEARS S74 1/2°E, 34.6' (C.S. 9107)
NEW: A 4" MAPLE, SCRIBED "XBT" ON A DOUBLE BLAZE, BEARS N36°E, 10.6'

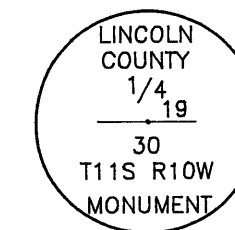

- (L) WITNESS POINT ON THE EAST-WEST CENTERLINE OF THE NW 1/4 OF SECTION 19
SET: A 5/8" X 30" RE-BAR WITH YELLOW PLASTIC CAP MARKED "NYHUS LS2515", 0.5' ABOVE GRADE, FROM WHICH;
A 32" SPRUCE, SCRIBED "XBT" ON A DOUBLE BLAZE, BEARS N57 1/2°E, 16.8'
AN 8" WILD CHERRY, BARK SCRIBED "XBT", BEARS S19°W, 12.7'

- (M) POINT ON THE EAST-WEST-CENTERLINE OF THE NW 1/4 OF SECTION 19
FOUND: A 1/2" RE-BAR WITH A YELLOW PLASTIC CAP MARKED "DENISON LS 574" 0.1' ABOVE GRADE (C.S. 9912)

- (N) 1/4 CORNER TO SECTIONS 19 AND 30
FOUND A 2" ALUMINUM CAP, MARKED AS SHOWN, 0.1' ABOVE GRADE (C.S. 9629)

- (O) GPS 9020
FOUND: A 1/2" RE-BAR WITH AN ILLEGIBLE PLASTIC CAP, 0.1' BELOW GRADE (LINCOLN COUNTY GEODETIC RECORDS)

REGISTERED
PROFESSIONAL
LAND SURVEYOR

Gary Keith Nyhus
OREGON
JULY 28, 1991
GARY KEITH NYHUS
2815

RENEWAL DATE:
12-31-94

NYHUS SURVEYING INC.

-GARY NYHUS-

740 E. THISSELL RD. TIDEWATER, ORE 97390

(503) 528-3234

CHECKED BY: GKN
DRAWN BY: GAM
DATE: 7/10/94
SCALE: 1"=500'
PROJECT: 94053

COMPUTER DRAFTING BY: GM MAPPING (503) 528-7062 TIDEWATER, ORE. 97390