

Soils Map

Boundary Lines Are Approximate

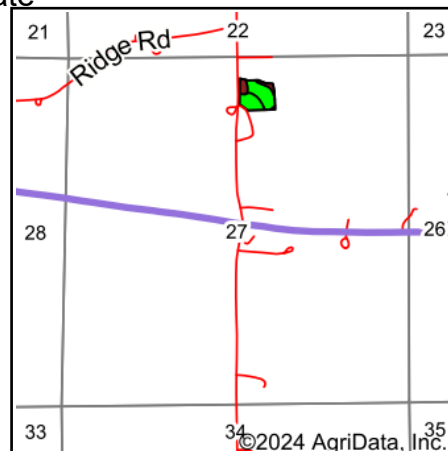

Soils data provided by USDA and NRCS.



State: **Iowa**
 County: **Wapello**
 Location: **27-72N-15W**
 Township: **Polk**
 Acres: **5.22**
 Date: **7/16/2024**

Hawkeye Farm Mgmt & Real Estate

22 N Main, Albion IA Phone: 641-932-7796
 Email: hawkeye@uciowa.com
 On the web: www.uciowa.com
www.iowawhitetailfarms.com

Maps Provided By:

surety
 CUSTOMIZED ONLINE MAPPING
 © AgriData, Inc. 2023 www.AgriDataInc.com



Area Symbol: IA179, Soil Area Version: 32

Code	Soil Description	Acres	Percent of field	CSR2 Legend	Non-Irr Class *c	CSR2**	CSR	*n NCCPI Corn	*n NCCPI Soybeans
131B	Pershing silt loam, 2 to 5 percent slopes	2.60	49.8%		IIIe	70	65	74	59
132B	Weller silt loam, 2 to 5 percent slopes	1.67	32.0%		IIIe	67	55	89	80
S732C2	Weller silty clay loam, 5 to 9 percent slopes, moderately eroded	0.95	18.2%		IIIe	59		81	67
Weighted Average					3.00	67	*-	*n 80.1	*n 67.2

**IA has updated the CSR values for each county to CSR2.

*- CSR weighted average cannot be calculated on the current soils data, use prior data version for csr values.

*n: The aggregation method is "Weighted Average using all components"

*c: Using Capabilities Class Dominant Condition Aggregation Method

Soils data provided by USDA and NRCS.