

Soils Map

Boundary Lines Are Approximate

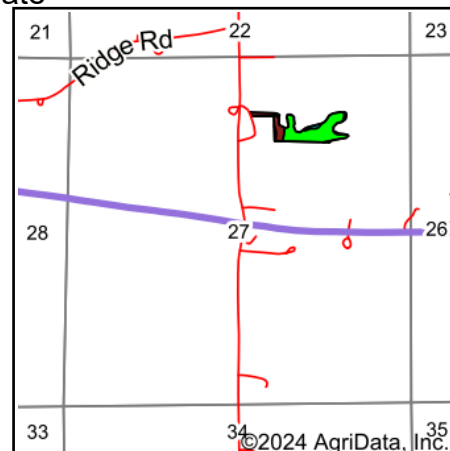
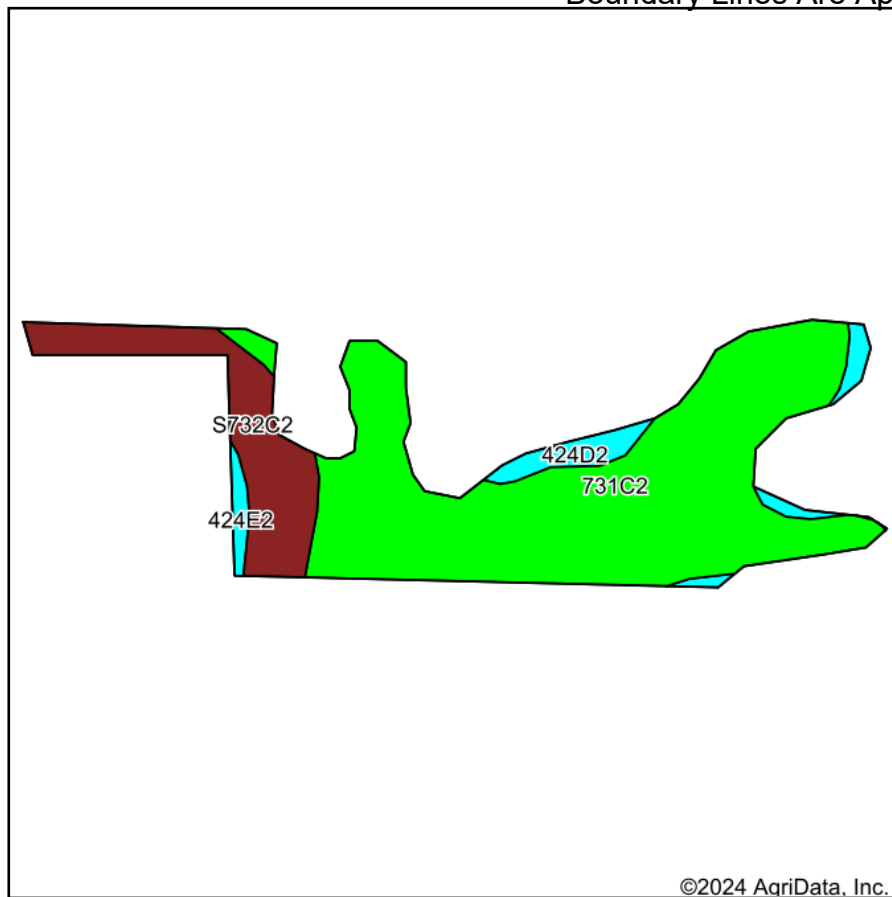

State: **Iowa**
 County: **Wapello**
 Location: **27-72N-15W**
 Township: **Polk**
 Acres: **7.27**
 Date: **7/16/2024**

Hawkeye Farm Mgmt & Real Estate



22 N Main, Albion IA Phone: 641-932-7796
 Email: hawkeye@uciowa.com
 On the web: www.uciowa.com;
 www.iowawhitetailfarms.com

Maps Provided By:



Soils data provided by USDA and NRCS.

Area Symbol: IA179, Soil Area Version: 32									
Code	Soil Description	Acres	Percent of field	CSR2 Legend	Non-Irr Class *c	CSR2**	CSR	*n NCCPI Corn	*n NCCPI Soybeans
731C2	Pershing silty clay loam, 5 to 9 percent slopes, moderately eroded	5.43	74.7%		IIIe	62	40	68	56
S732C2	Weller silty clay loam, 5 to 9 percent slopes, moderately eroded	1.29	17.7%		IIIe	59		81	67
424D2	Lindley-Keswick loams, 9 to 14 percent slopes, moderately eroded	0.44	6.1%		IVe	27	15	63	50
424E2	Lindley-Keswick loams, 14 to 18 percent slopes, moderately eroded	0.11	1.5%		VIe	24	5	59	46
Weighted Average					3.11	58.8	*-	*n 69.9	*n 57.4

**IA has updated the CSR values for each county to CSR2.

*- CSR weighted average cannot be calculated on the current soils data, use prior data version for csr values.

*n: The aggregation method is "Weighted Average using all components"

*c: Using Capabilities Class Dominant Condition Aggregation Method