

Tax Year: 2024

Scale: 1:1824.07 Basemap: Cadastral Application Base Map

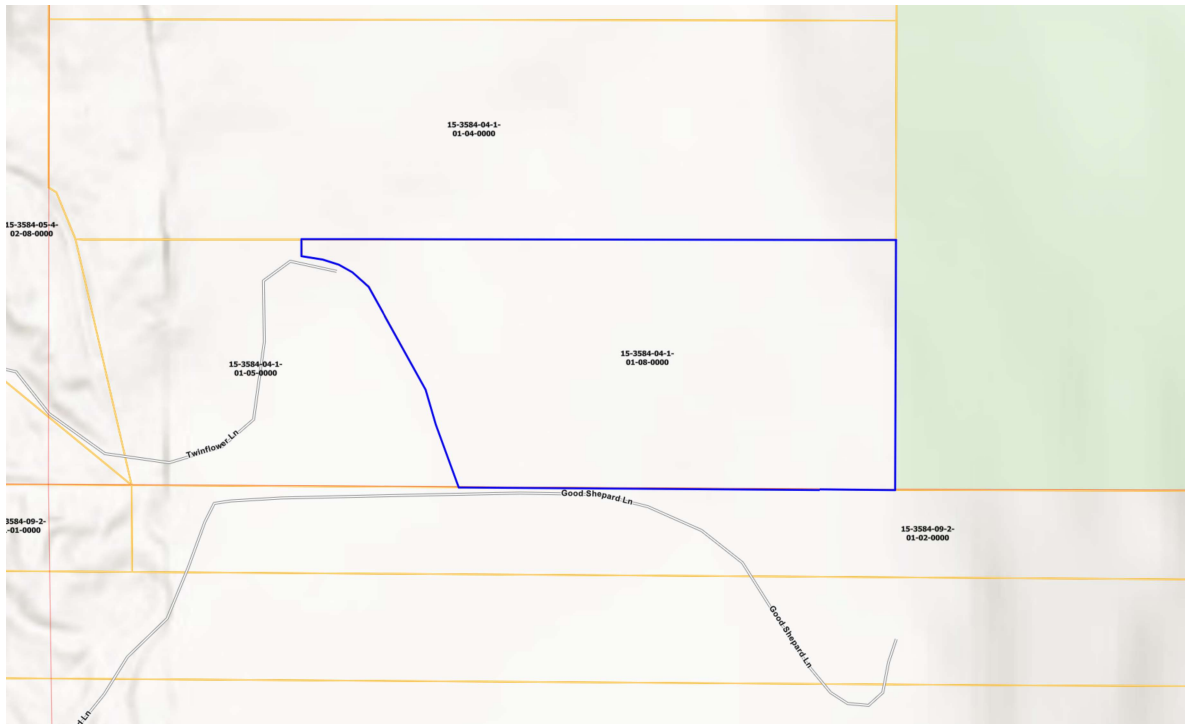

## Summary

## Primary Information

Property Category: RP

Subcategory: Residential Property

Geocode: 15-3584-04-1-01-08-0000

Assessment Code: 0000006151

Primary Owner:

**Primary Owner:**  
TAKEMOTO JOYCE KAY  
31714 TWINFLOWER LN  
BIGFORK, MT 59911-8210  
Note: See Owners section for all owners

## Property Address:

31714 TWINFLOWER LN  
BIGFORK, MT 59911

Certificate of Survey:

Legal Description: S04, T25 N, R19 W, ACRES 6.61, SP-73 TR 1, S2SWSW

Last Modified: 5/18/2024 16:27:53 PM

Tax Year: 2024

## General Property Information

Neighborhood: 215.300.7	Property Type: IMP_R - Improved Property - Rural
Living Units: 2	Levy District: 15-0330-38
Zoning:	Ownership: 100
LinkedProperty: No linked properties exist for this property	
Exemptions: No exemptions exist for this property	
Condo Ownership:	Limited: 0
General: 0	

## Property Factors

Topography: n/a	Fronting: n/a
Utilities: n/a	Parking Type: n/a
Access: n/a	Parking Quantity: n/a
Location: n/a	Parking Proximity: n/a

## Land Summary

Land Type:	Acres:	Value:
Grazing	0	0
Fallow	0	0
Irrigated	0	0
Continuous Crop		
Wild Hay	0	0
Farmsite	0	0
ROW	0	0
NonQual Land	0	0
Total Ag Land	0	0
Total Forest Land	0	0
Total Market Land	6.61	106248

## Deed Information

Deed Date	Book	Page	Recorded Date	Document Number	Document Type
6/23/2023			6/23/2023	605463	Termination of Joint Tenancy by Death
3/29/2000	407	056 G	N/A		
9/9/1999	402	543 O	N/A		
1/6/1999	395	948 G	N/A		
7/3/1995	367	058 W	N/A		

## Owners

Tax Year: 2024

## Party #1

Default Information:	TAKEMOTO JOYCE KAY 31714 TWINFLOWER LN BIGFORK, MT 59911-8210
Ownership %:	100
Primary Owner:	Yes
Interest Type:	Conversion
Last Modified:	9/22/2023 14:57:25 PM

## Appraisals

### Appraisal History

Tax Year	Land Value	Building Value	Total Value	Method
2024	106248	187540	293788	COST
2023	106248	187540	293788	COST
2022	85267	149890	235157	COST

## Market Land

### Market Land Item #1

Method: Acre	Type: Primary Site
Width: n/a	Depth: n/a
Square Feet: n/a	Acres: 6.61
Class Code: 2101	Value: 106248

## Dwellings

### Dwelling #1

#### Dwelling Information

Dwelling Type MH	Style DW	Year Built 1995
Residential Type: MH Year Built: 1995 Effective Year: n/a Story Height: 1.0 Grade: L Class Code: 3301 Year Remodeled: n/a	Style: DW Roof Material: 5 - Metal Roof Type: 3 Attic Type: 0 - None Exterior Walls: n/a Exterior Wall Finish: 6 - Wood Siding or Sheathing Degree Remodeled: n/a	

Tax Year: 2024

## Mobile Home Details

Manufacturer: n/a  
Width: n/a  
Model: n/a

Serial #: n/a  
Length: n/a

## Basement Information

Foundation: 2 - Concrete  
Daylight: n/a  
Quality: n/a

Finished Area: n/a  
Basement Type: 0 - None

## Heating/Cooling Information

Type: Central

System Type: 5 - Forced Air

Fuel Type: 4 - Electricity

Heated Area: n/a

## Living Accomodations

Bedrooms: 3

Family Rooms: n/a

Full Baths: 2

Half Baths: n/a

Addl Fixtures: 3

## Additional Information

Fire Places  
Stories: n/a  
Openings: n/a

Stacks: n/a  
Prefab/Stove: n/a

Garage Capacity: n/a

Cost & Design: n/a

Flat Add: n/a

% Complete: n/a

Description: n/a

## Dwelling Ammenities

View: n/a

Access: n/a

## Area Used in Cost

Basement: n/a

Addl Floors: n/a

First Floor: 1766

Second Floor: n/a

Half Story: n/a

Unfinished Area: n/a

Attic: n/a

SFLA: 1766

## Depreciation Information

CDU: n/a

Physical Condition: Fair (6)

Desirability  
Property: Average (7)

Location: Average (7)

## Depreciation Calculation

Age: 27

Pct Good: 0.38

RCNLD: 66380

## Additions / Other Features

# Cadastral Property Report

Tax Year: 2024

Lower Addtns	First	Second	Third	Area	Year	Cost
	11 - Porch, Frame, Open			312	0	17013
	33 - Deck, Wood			360	0	5857

No additional features exist for this property

## Dwelling #2

### Dwelling Information

Dwelling Type SFR	Style 14 - Other	Year Built 2008
Residential Type: SFR	Style: 14 - Other	Roof Material: 5 - Metal
Year Built: 2008	Roof Type: 3	Attic Type: 0 - None
Effective Year: n/a	Exterior Walls: 1 - Frame	Exterior Wall Finish: 6 - Wood Siding or Sheathing
Story Height: 1.0	Degree Remodeled: n/a	
Grade: 4		
Class Code: 3301		
Year Remodeled: n/a		

### Mobile Home Details

Manufacturer: n/a	Serial #: n/a
Width: n/a	Length: n/a
Model: n/a	

### Basement Information

Foundation: 3 - Slab	Finished Area: n/a
Daylight: n/a	Basement Type: 0 - None
Quality: n/a	

### Heating/Cooling Information

Type: Non-Central	System Type: 7 - Electric Baseboard/Electric Radiant
Fuel Type: 4 - Electricity	Heated Area: n/a

### Living Accomodations

Bedrooms: 1	Family Rooms: n/a
Full Baths: 1	Half Baths: n/a

Addl Fixtures: 2

### Additional Information

Fire Places	Stacks: n/a
Stories: n/a	Prefab/Stove: n/a
Openings: n/a	
Garage Capacity: n/a	Cost & Design: n/a
Flat Add: n/a	% Complete: n/a

Description: n/a

### Dwelling Ammenities

View: n/a	Access: n/a
-----------	-------------

### Area Used in Cost

Tax Year: 2024

Basement: n/a	Addl Floors: n/a					
First Floor: 480	Second Floor: n/a					
Half Story: n/a	Unfinished Area: n/a					
Attic: n/a	SFLA: 480					
Depreciation Information						
CDU: n/a	Physical Condition: Fair (6)					
Desirability Property: Fair (6)	Location: Average (7)					
Depreciation Calculation						
Age: 14	Pct Good: 0.76					
RCNLD: 119760						
Additions / Other Features						
Lower Addtns	First 19 - Garage, Frame, Finished	Second	Third	Area 896	Year 0	Cost 48188
No additional features exist for this property						

## Other Buildings

### Outbuilding/Yard Improvement #1

Type: Residential	Description: RRS1 - Shed, Frame
Quantity: 1	Year Built: 1996
Grade: A	Condition: Res Average
Functional: n/a	Class Code: 3301
Dimensions	
Width/Diameter: 12	Length: 16
Size/Area: 192	Height: n/a
Bushels: n/a	Circumference: n/a

## Commercial

No commercial buildings exist for this parcel

## Ag/Forest Land

Tax Year: 2024

No ag/forest land exists for this parcel

## Easements

No easements exist for this parcel

## Disclaimer

The Montana State Library (MSL) provides this product/service for informational purposes only. MSL did not produce it for, nor is it suitable for legal, engineering, or surveying purposes. Data from disparate sources may not be in vertical alignment. Consumers of this information should review or consult the primary data and information sources to ascertain the viability of the information for their purposes. The MSL provides these data in good faith and in no event, shall be liable for any incorrect results or analysis, any lost profits and special, indirect or consequential damages to any party, arising out of or in connection with the use or the inability to use the data or the services provided. The MSL makes these data and services available as a convenience to the public, and for no other purpose. The MSL reserves the right to change or revise published data and/or services at any time.