

**Baker Agri-Forest Properties, LLC - Butter Cemetery Road
+/- 2.1 acres being that portion of the SE/4 of the SW/4,
lying North of Butter Cemetery Road
all in Section 36, T1N, R2W, Rapides Parish, Louisiana**

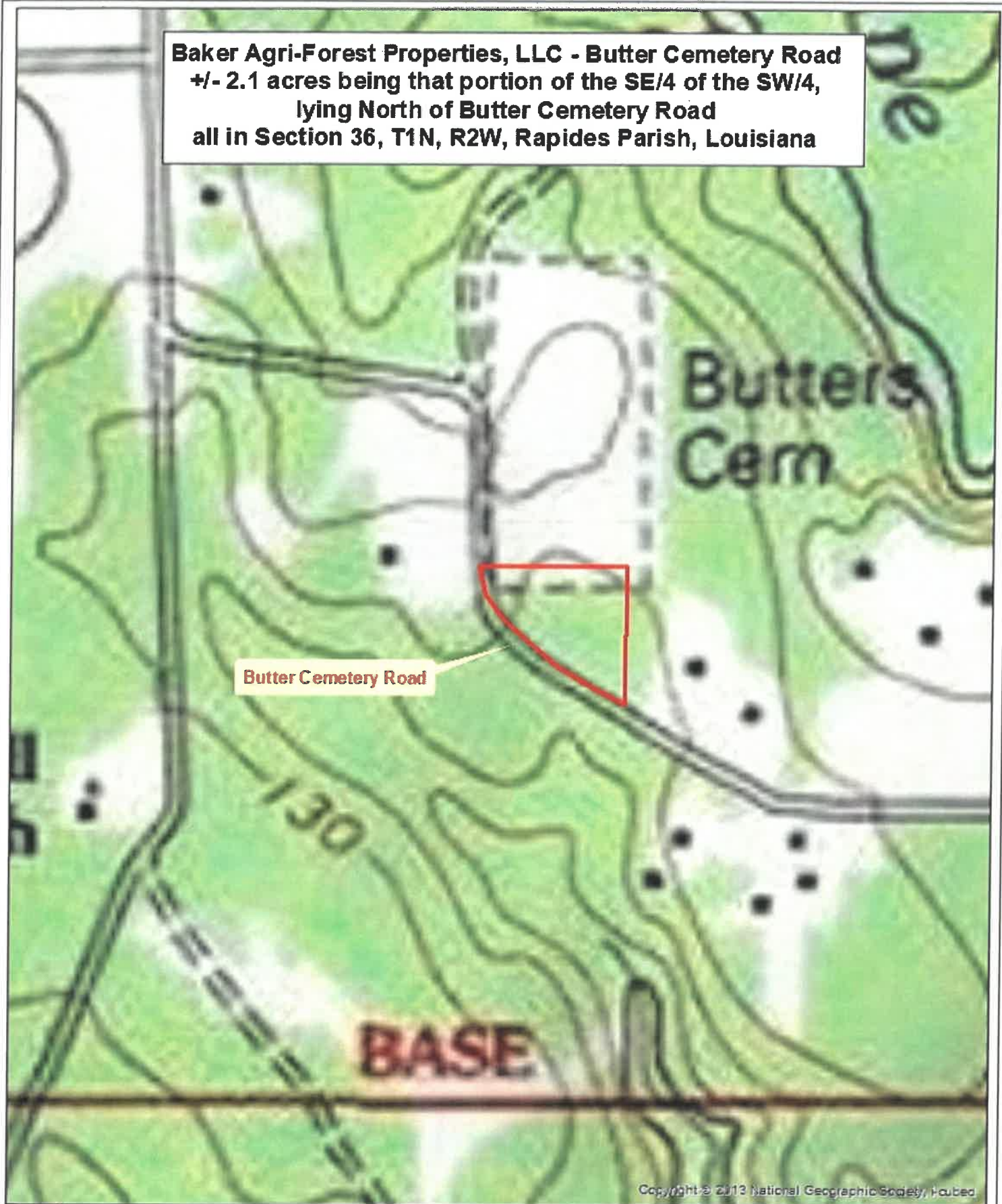

Copyright © 2013 National Geographic Society, Inc.

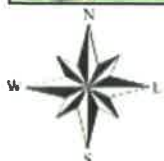

1 inch = 330 feet



**Baker Land & Timber
Management, Inc.
P.O. Box 5624
Alexandria, LA 71307
Date: 7/30/2024**