

Soils Map

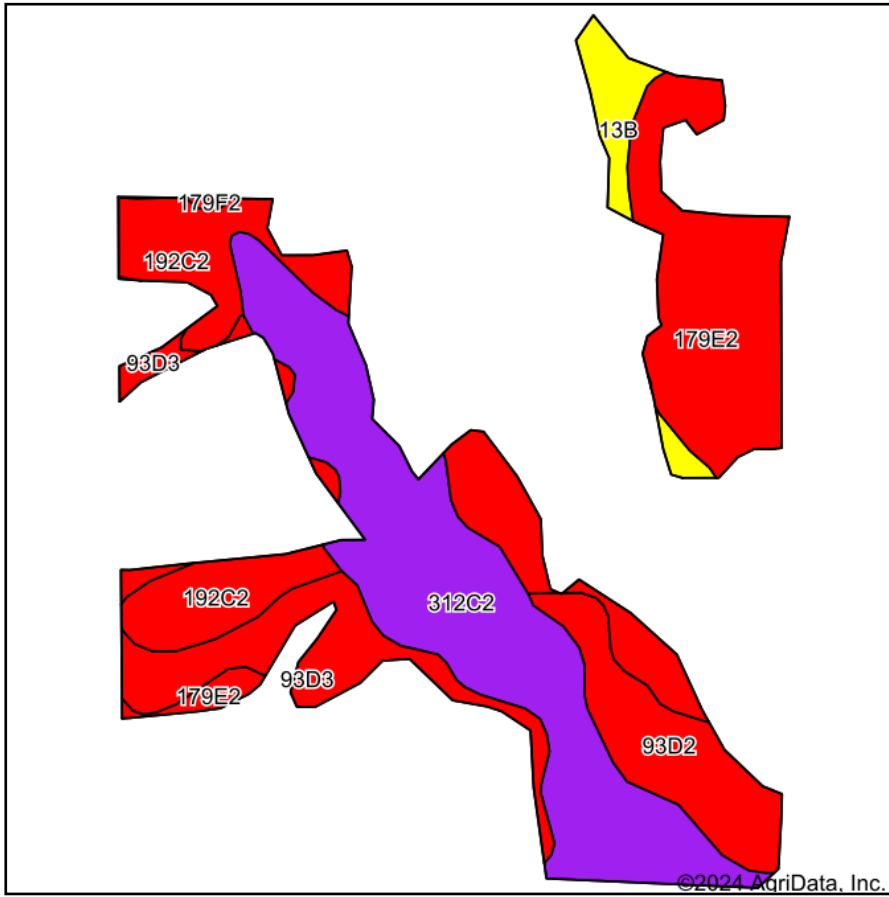

Soils data provided by USDA and NRCS.

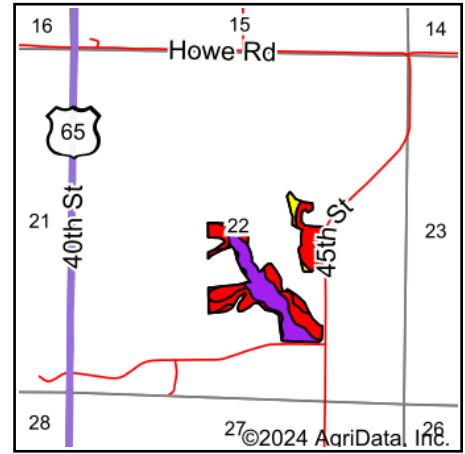

State: **Iowa**
 County: **Wayne**
 Location: **22-68N-23W**
 Township: **Jefferson**
 Acres: **33.41**
 Date: **2/5/2024**

Maps Provided By:

 CUSTOMIZED ONLINE MAPPING
 © AgriData, Inc. 2023 www.AgriDataInc.com



Area Symbol: IA185, Soil Area Version: 27

Code	Soil Description	Acres	Percent of field	CSR2 Legend	Non-Irr Class *c	CSR2**	Bromegrass alfalfa AUM	Bromegrass alfalfa hay Tons	Corn Bu	Kentucky bluegrass AUM	Oats Bu	Smooth bromegrass AUM	Soybeans Bu	*n NCCPI Overall	*n NCCPI Corn
312C2	Seymour silty clay loam, 5 to 9 percent slopes, moderately eroded	11.47	34.3%		IIIe	56								62	6
179E2	Gara loam, 14 to 18 percent slopes, moderately eroded	8.69	26.0%		VIe	24								62	6
192C2	Adair clay loam, heavy till, 5 to 9 percent slopes, moderately eroded	4.49	13.4%		IIIe	29								66	6
93D3	Shelby-Adair complex, 9 to 14 percent slopes, severely eroded	3.87	11.6%		IVe	33	3.6	2.7	124	1.6	41	2.6	36	66	6

Soils data provided by USDA and NRCS.

Code	Soil Description	Acres	Percent of field	CSR2 Legend	Non-Irr Class *c	CSR2**	Bromegrass alfalfa AUM	Bromegrass alfalfa hay Tons	Corn Bu	Kentucky bluegrass AUM	Oats Bu	Smooth bromegrass AUM	Soybeans Bu	*n NCCPI Overall	*n NCCPI Corn
93D2	Shelby-Adair complex, 9 to 14 percent slopes, moderately eroded	3.48	10.4%		IVe	32								69	6
13B	Zook-Olmitz-Vesser complex, 0 to 5 percent slopes	1.34	4.0%		IIw	68								77	7
179F2	Gara loam, 18 to 24 percent slopes, moderately eroded	0.07	0.2%		Vle	12								54	5
Weighted Average					3.97	39.3	0.4	0.3	14.4	0.2	4.7	0.3	4.2	*n 64.3	*n 6

**IA has updated the CSR values for each county to CSR2.

*n: The aggregation method is "Weighted Average using all components"

**IA has updated the CSR values for each county to CSR2.*c: Using Capabilities Class Dominant Condition Aggregation Method