

# Soils Map

Boundary Lines Are Approximate

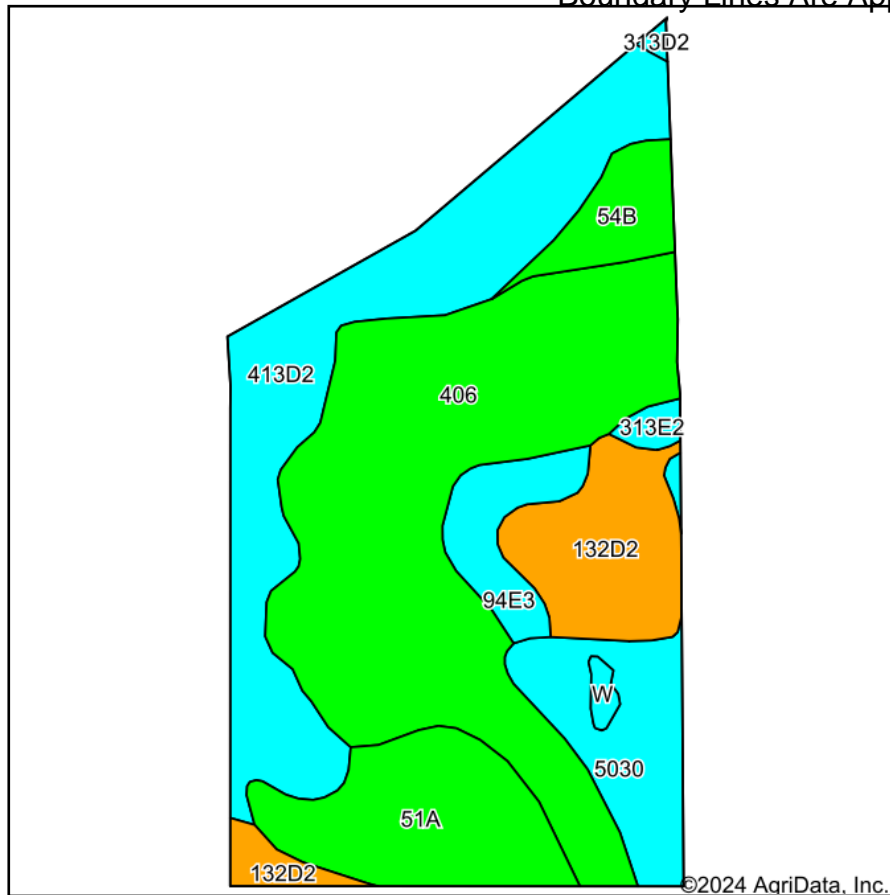

Soils data provided by USDA and NRCS.

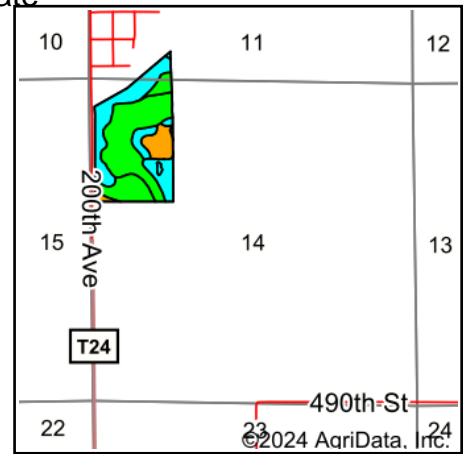

State: **Iowa**  
 County: **Appanoose**  
 Location: **14-69N-18W**  
 Township: **Walnut**  
 Acres: **58**  
 Date: **8/13/2024**

**Hawkeye Farm Mgmt & Real Estate**



22 N Main, Albion IA Phone: 641-932-7796  
 Email: hawkeye@uciowa.com  
 On the web: www.uciowa.com  
 www.iowawhitetailfarms.com

Maps Provided By:



Area Symbol: IA007, Soil Area Version: 30

Code	Soil Description	Acres	Percent of field	CSR2 Legend	Non-Irr Class *c	CSR2**	CSR	*n NCCPI Corn	*n NCCPI Soybeans
406	Kennebec-Amana silt loams complex	22.25	38.3%		Iw	88	90	91	84
413D2	Sogn-Gosport-Clanton complex, 9 to 18 percent slopes, moderately eroded	13.26	22.9%		VIe	9	5	35	23
51A	Vesser silt loam, 0 to 2 percent slopes, occasionally flooded	6.45	11.1%		IIw	75	70	75	94
132D2	Weller silt loam, 9 to 14 percent slopes, moderately eroded	5.74	9.9%		IVe	33	28	77	61
5030	Pits, limestone quarries	4.82	8.3%			0	0		
94E3	Mystic-Caleb complex, 14 to 18 percent slopes, severely eroded	2.47	4.3%		VIIe	13	5	65	45
54B	Zook silty clay loam, heavy till, 2 to 5 percent slopes, rarely flooded	2.16	3.7%		IIw	71	65	64	69
313E2	Gosport-Clanton silt loams, 14 to 18 percent slopes, moderately eroded complex	0.44	0.8%		VIIe	8	5	39	27
W	Water	0.28	0.5%			0	0		
313D2	Gosport-Clanton silt loams, 9 to 14 percent slopes, moderately eroded complex	0.13	0.2%		VIe	14	10	41	29
Weighted Average					*-	50.7	48.9	*n 64.4	*n 58.7

\*\*IA has updated the CSR values for each county to CSR2.

\*n: The aggregation method is "Weighted Average using all components"

\*c: Using Capabilities Class Dominant Condition Aggregation Method

\*- Non Irr Class weighted average cannot be calculated on the current soils data due to missing data.

Soils data provided by USDA and NRCS.