



Listing Summary

# Hartwell Crest

1817 Dobbins Road | Townville, SC 29689



## Property Summary

For generations, Hartwell Crest has served as prime agricultural and recreational land. Sitting just  $\pm 4.5$  miles off I-85, this tract grants a future owner easy access to modern day necessities without compromising a quiet setting outside the city. Each lot offers acres of premier pasture outlined by mature Hartwell forests. The property offers mostly level topography with some rolling areas and great road frontage across the board. With nearby access to a recently upgraded landing, these lots present a rare opportunity to own acreage at the water. Nestled in a timeless community, boasting the natural beauty of historic farmland, Hartwell Crest is truly a unique property. Come envision your dream home at Hartwell Crest Today.

## Property Details

- A portion of Anderson County TM #180008006
- Flat Topography with Excellent Visibility & Location with Pristine Farmland
- Lake Hartwell Access | Nearby Hattons Ford Boat Ramp Pastureland | Mature Hardwoods & Pines
- Zoned for Townville Elementary | Riverside Middle School | Pendleton High School
- Best Use: Residential Homesite
- Possible Utilities: Power, Septic, Well
- Phase II Lots have water and cable in ground
- *\*Acreage, Taxes & Utilities to be Verified by Buyer or Buyer's Agent*
- *\*Subject to Recorded Covenants and Restriction*
- *\*No tracts have lake frontage, no tracts are dockable*



**Sale Price:**  
Varies Per Lot



**Lot Size:**  
Varies Per Lot



$\pm 20$  minutes from  
Clemson, SC



$\pm 23$  minutes from  
Pendleton, SC



$\pm 25$  minutes from  
Anderson, SC



$\pm 43$  minutes from  
Greenville, SC

# Parcel Overview

Hartwell Crest | Phase I

*Contact Broker for Lot Availability*



<b>Tract 1</b>	±7.19 Acres
<b>Tract 2</b>	±7.20 Acres
<b>Tract 3</b>	±6.79 Acres
<b>Tract 4</b>	±6.17 Acres
<b>Tract 5</b>	±6.52 Acres
<b>Tract 6</b>	±6.71 Acres
<b>Tract 7</b>	±25 Acres
<b>Tract 8</b>	±25 Acres
<b>Tract 9</b>	±25 Acres

# Parcel Overview

Hartwell Crest | Phase II

REEDY

Contact Broker for Lot Availability

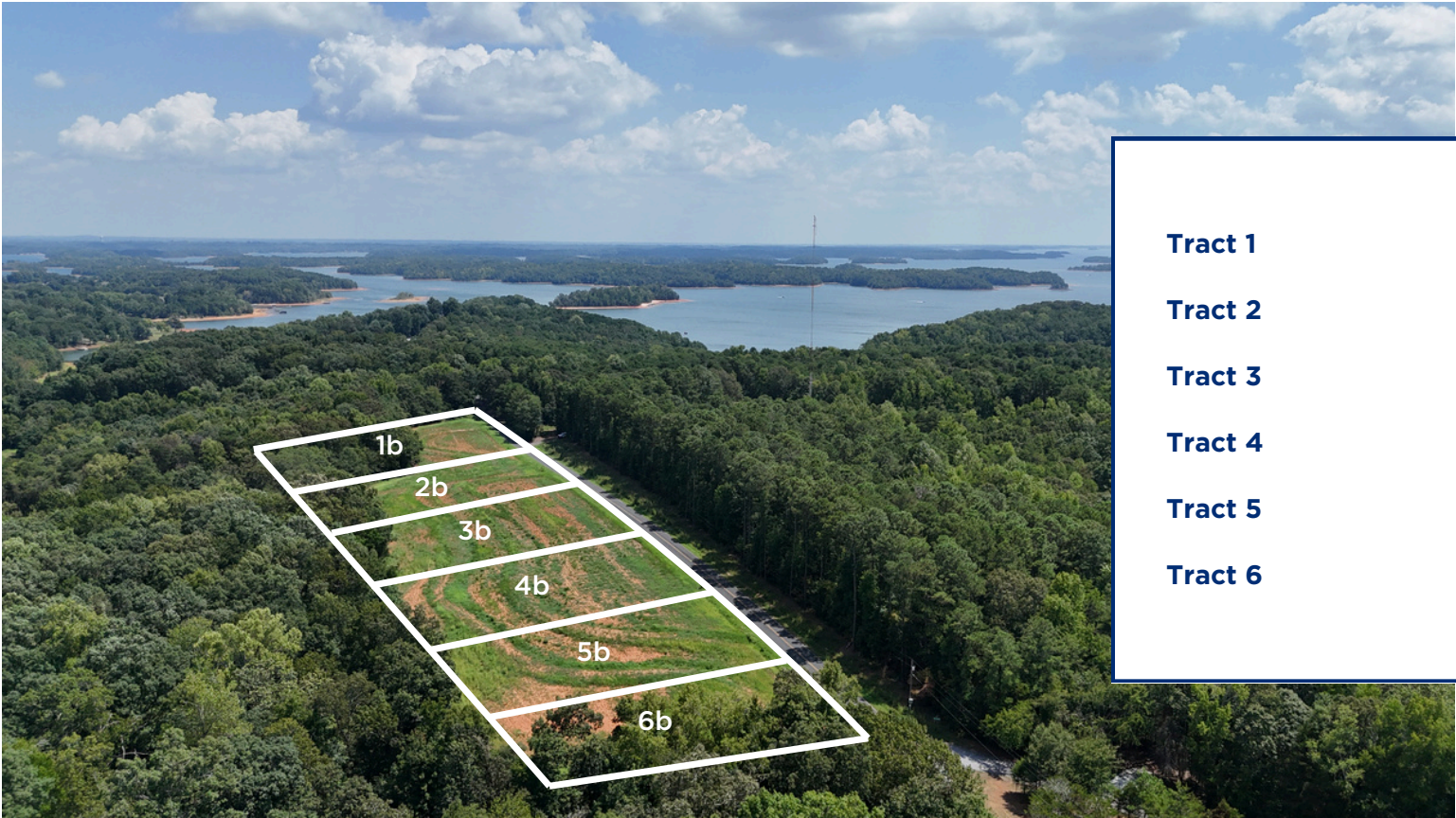

Tract 1	±2.48Acres
Tract 2	±2.42 Acres
Tract 3	±2.45 Acres
Tract 4	±2.56 Acres
Tract 5	±2.64 Acres
Tract 6	±2.81 Acres



# Phase I Property Photos

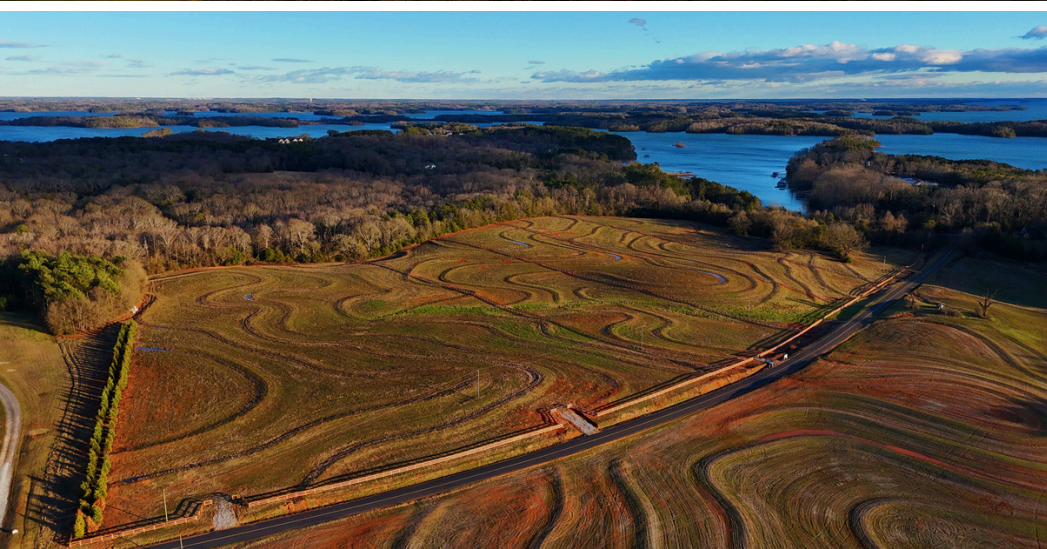
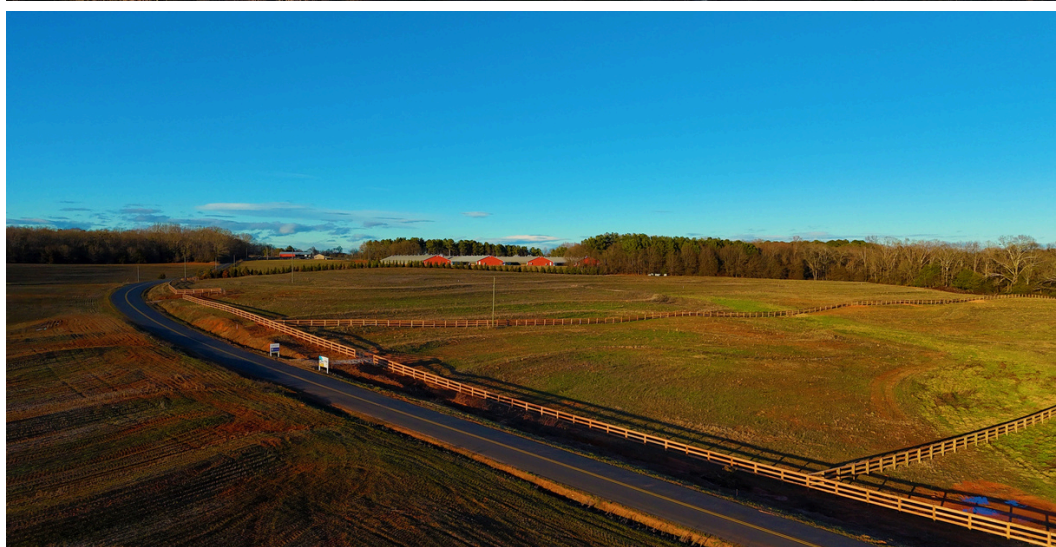







# Municipality Map

Upstate, SC

REEDY

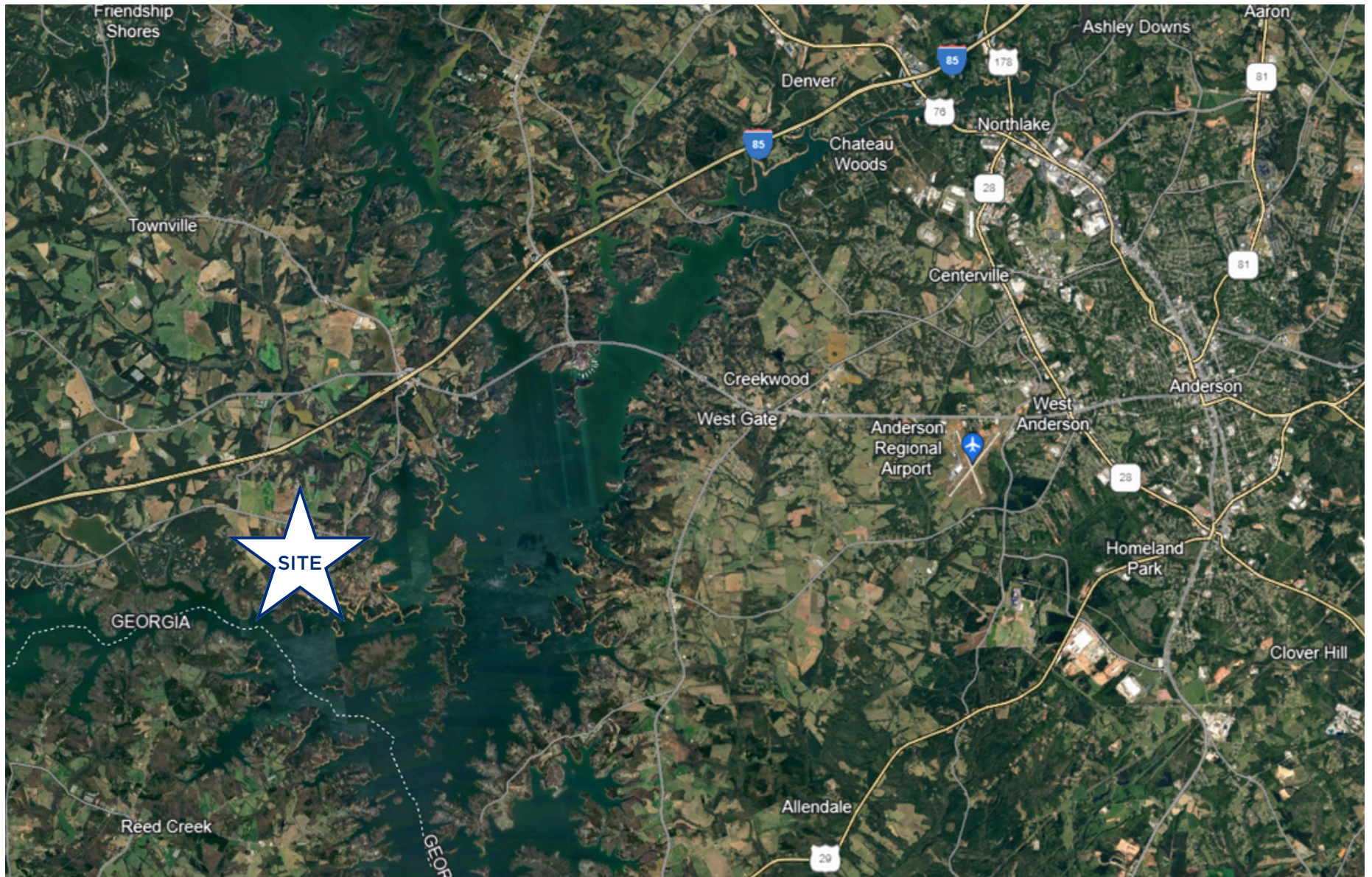



# Anderson District Four

Market Data | *Niche*

REEDY



**No. 15**

District with the Best Teachers in SC (out of 76)



**No. 16**

Best School District in South Carolina (out of 76)



**85%**

Average Graduation Rate



**\$64k+**

Average Teacher Salary



**\$62k+**

Median Household Income



**\$189k+**

Median Home Value



**No. 6**

Best Counties to Buy a House in South Carolina (out of 46)



**No. 8**

Best Counties for Outdoor Activities in South Carolina



**78k+**

Number of households



# Confidentiality & Disclaimer

REEDY

All materials and information received or derived from Reedy Property Group its directors, officers, agents, advisors, affiliates and/or any third party sources are provided without representation or warranty as to completeness, veracity, or accuracy, condition of the property, compliance or lack of compliance with applicable governmental requirements, developability or suitability, financial performance of the property, projected financial performance of the property for any party's intended use or any and all other matters.

Neither Reedy Property Group its directors, officers, agents, advisors, or affiliates makes any representation or warranty, express or implied, as to accuracy or completeness of the any materials or information provided, derived, or received. Materials and information from any source, whether written or verbal, that may be furnished for review are not a substitute for a party's active conduct of its own due diligence to determine these and other matters of significance to such party. Reedy Property Group will not investigate or verify any such matters or conduct due diligence for a party unless otherwise agreed in writing.

EACH PARTY SHALL CONDUCT ITS OWN INDEPENDENT INVESTIGATION AND DUE DILIGENCE.

Any party contemplating or under contract or in escrow for a transaction is urged to verify all information and to conduct their own inspections and investigations including through appropriate third party independent professionals selected by such party. All financial data should be verified by the party including by obtaining and reading applicable documents and reports and consulting appropriate independent professionals. Reedy Property Group makes no warranties and/or representations regarding the veracity, completeness, or relevance of any financial data or assumptions. Reedy Property Group does not serve as a financial advisor to any party regarding any proposed transaction. All data and assumptions regarding financial performance, including that used for financial modeling purposes, may differ from actual data or performance. Any estimates of market rents and/or projected rents that may be provided to a party do not necessarily mean that rents can be established at or increased to that level. Parties must evaluate any applicable contractual and governmental limitations as well as market conditions, vacancy factors and other issues in order to determine rents from or for the property.

Legal questions should be discussed by the party with an attorney. Tax questions should be discussed by the party with a certified public accountant or tax attorney. Title questions should be discussed by the party with a title officer or attorney. Questions regarding the condition of the property and whether the property complies with applicable governmental requirements should be discussed by the party with appropriate engineers, architects, contractors, other consultants and governmental agencies. All properties and services are marketed by Reedy Property Group in compliance with all applicable fair housing and equal opportunity laws.





# Who We Are

Reedy Land Co

## LAND IS MORE THAN DIRT. IT'S YOUR LEGACY.

Whether you're building on a dream or managing generational wealth, the land you choose to call home is deeply personal.

People. Loyalty. Trust. These are the foundations of our approach to real estate. We connect people to places. We guide development for future generations. And, we transform your vision of the "good life" into your everyday life.

---

**Knox Duncan**

864.608.0029

[kduncan@reedypg.com](mailto:kduncan@reedypg.com)

