

# Soils Map

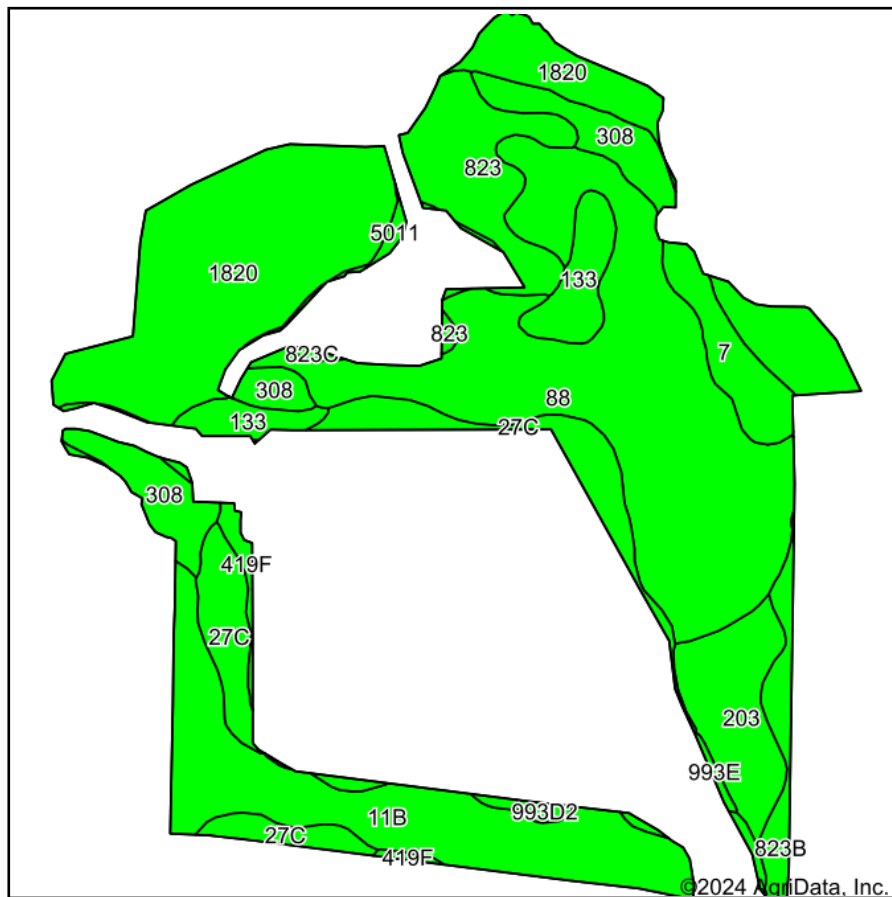

Soils data provided by USDA and NRCS.

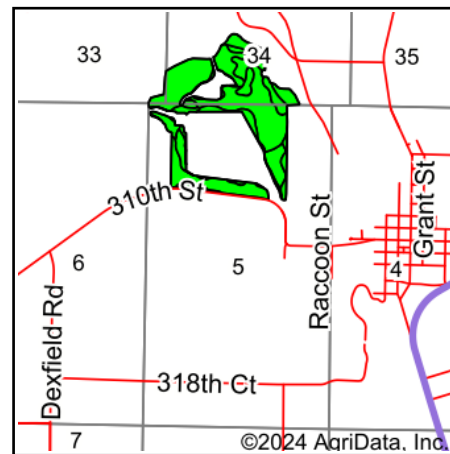

State: **Iowa**  
 County: **Dallas**  
 Location: **5-78N-29W**  
 Township: **Union**  
 Acres: **190.28**  
 Date: **9/30/2024**



Maps Provided By:



Area Symbol: IA049, Soil Area Version: 30

Code	Soil Description	Acres	Percent of field	CSR2 Legend	Non-Irr Class *c	*i Corn Bu	*i Soybeans Bu	CSR2**	CSR	*n NCCPI Overall
88	Nevin silty clay loam, 0 to 2 percent slopes, rarely flooded	52.25	27.6%		Iw	227.2	65.9	95	90	98
1820	Dockery-Quiver silt loams, 0 to 2 percent slopes, occasionally flooded	43.42	22.8%		IIw			87		93
11B	Colo, occasionally flooded-Ely silty clay loams, dissected till plain, 2 to 5 percent slopes	25.74	13.5%		IIw	204.8	59.4	80	68	87
27C	Terril loam, 5 to 9 percent slopes	13.97	7.3%		IIIe	208.0	60.3	85	67	91
823	Ridgeport sandy loam, 0 to 2 percent slopes	11.62	6.1%		IIIs	80.0	23.2	56	38	56
308	Wadena loam, 0 to 2 percent slopes	11.52	6.1%		IIIs	80.0	23.2	56	73	61
203	Cylinder loam, 0 to 2 percent slopes	9.91	5.2%		IIIs	80.0	23.2	58	80	72
133	Colo silty clay loam, deep loess, 0 to 2 percent slopes, occasionally flooded	7.10	3.7%		IIw	204.8	59.4	78	81	76
7	Wiota silt loam, 1 to 3 percent slopes	5.71	3.0%		I	233.6	67.7	95	90	97
823B	Ridgeport sandy loam, 2 to 5 percent slopes	4.11	2.2%		IIIe	80.0	23.2	51	35	55
419F	Vanmeter silt loam, 14 to 30 percent slopes	2.37	1.2%		VIIe	88.0	25.5	5	7	22
993D2	Gara-Armstrong complex, 9 to 14 percent slopes, moderately eroded	1.22	0.6%		IVe	123.2	35.7	23	20	67
5011	Anthropotic Udorthents, reclaimed sand and gravel pits, 0 to 9 percent slopes	0.74	0.4%		IIIs			5		85
993E	Gara-Armstrong complex, 14 to 18 percent slopes	0.36	0.2%		VIe	96.0	27.8	18	12	70

Soils data provided by USDA and NRCS.

Code	Soil Description	Acres	Percent of field	CSR2 Legend	Non-Irr Class *c	*i Corn Bu	*i Soybeans Bu	CSR2**	CSR	*n NCCPI Overall
823C	Ridgeport sandy loam, 5 to 9 percent slopes	0.24	0.1%		IIIe	80.0	23.2	46	15	55
Weighted Average					1.94	137.8	40	80	*-	*n 85.6

\*\*IA has updated the CSR values for each county to CSR2.

\*- CSR weighted average cannot be calculated on the current soils data, use prior data version for csr values.\*i Yield data provided by the ISPAID Database version 8.1.1 developed by IA State University.

\*n: The aggregation method is "Weighted Average using all components"

\*c: Using Capabilities Class Dominant Condition Aggregation Method