

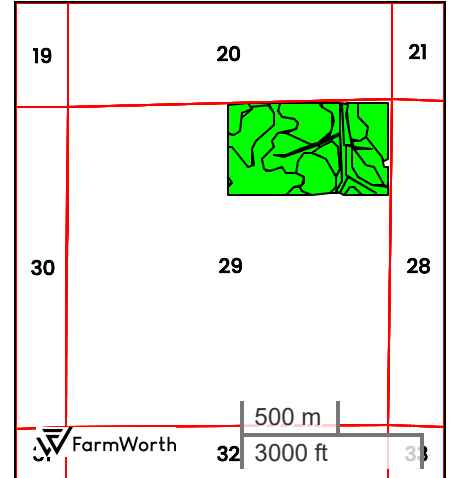

TRACT 3 (90.00 AC TOTAL, 89.61 AC TILLABLE)
TILLABLE SOILS

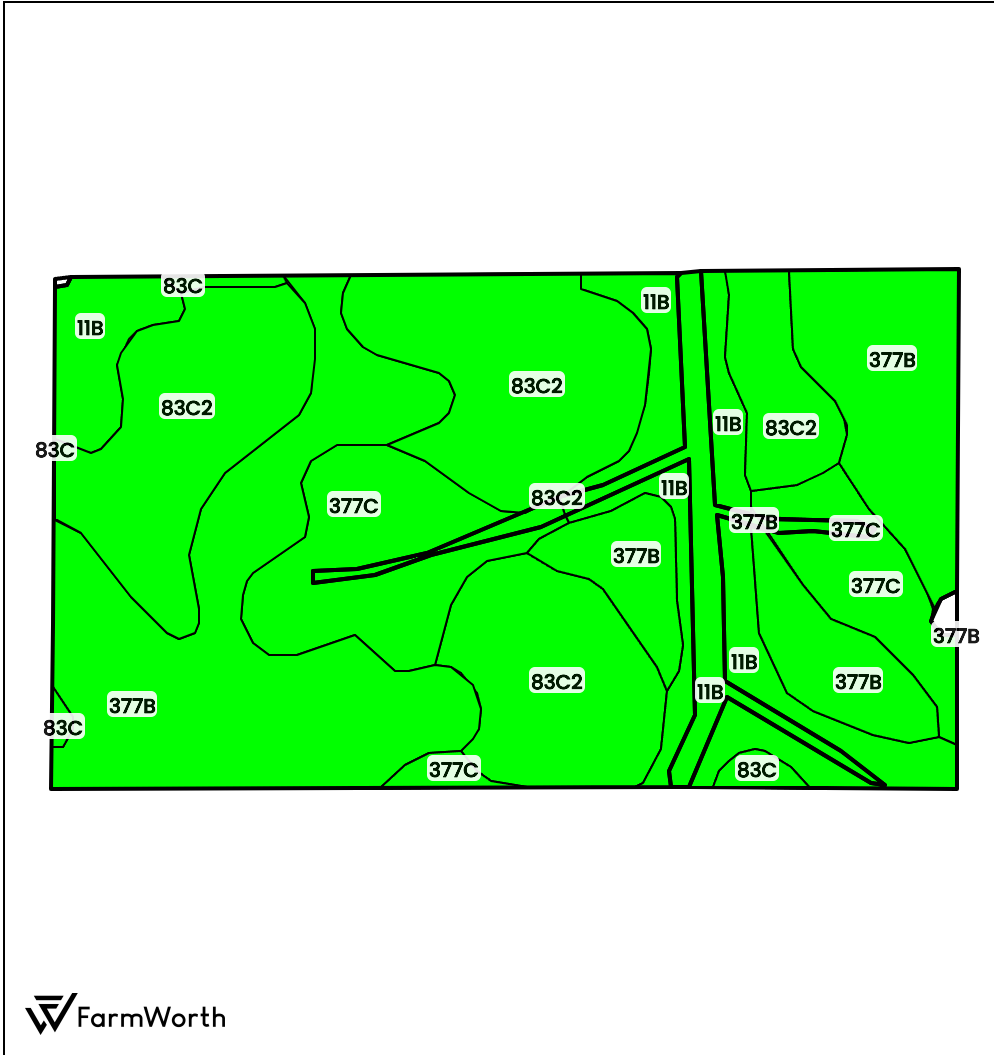

County: **Benton County, IA**
 Location: **29-86N-12W**
 Township: **Bruce**
 Acres: **89.61**
 Date: **09/04/2024**



Field borders obtained from Farm Service Agency as of 2008

FarmWorth, LLC makes no representations or warranties, express or implied, as to the accuracy of any information, data, numerical values, boundaries, or any other information generated through the use of FarmWorth.com. User is solely responsible for independently investigating and determining all information provided through FarmWorth.com prior to use and waives any and all claims against FarmWorth, LLC for any inaccuracies or inconsistencies in the information and/or data.



Code	Description	Acres	% of field	IA CSR2	Overall NCCPI	Soil Class (Non-Irr)	Drainage Class
377B	Dinsdale silty clay loam, 2 to 5 percent slopes	31.46	35.11 %	94	88	2	Moderately well drained
83C2	Kenyon loam, 5 to 9 percent slopes, eroded	29.93	33.40 %	84	82	3	Moderately well drained
11B	Colo-Ely complex, 0 to 5 percent slopes	14.68	16.38 %	86	91	2	Poorly drained
377C	Dinsdale silty clay loam, 5 to 9 percent slopes	12.63	14.09 %	90	86	3	Moderately well drained
83C	Kenyon loam, 5 to 9 percent slopes	0.92	1.03 %	85	88	3	Moderately well drained
Average:				88.7	86.2		

IA has updated the CSR values for each county to CSR2.
 Soils data provided by USDA and NRCS.