



317/321/325 Park Ave East  
Oneida County, Wisconsin

0 0.045 0.09 0.18 0.27 0.36  
mi

This map is courtesy of the Oneida County Land Information office and is a general sketch of areas in Oneida County. It should not be used to represent surveys of property. See original source documents for more information.





Big Cottage #9

Hilltop Cottage  
#10

Middle Cottage  
#8

Shed

First Cottage #7

Historic 2 Story  
House

Garage

Twin Home

Kitchenette  
Units 1-6

Parking

Permanent Piers

Permanent Piers

343' Frontage on Lake Minocqua





317/321/325 Park Ave East  
Oneida County, Wisconsin

0 0.005 0.01 0.02 0.03 0.04  
mi

This map is courtesy of the Oneida County Land Information office and is a general sketch of areas in Oneida County. It should not be used to represent surveys of property. See original source documents for more information.



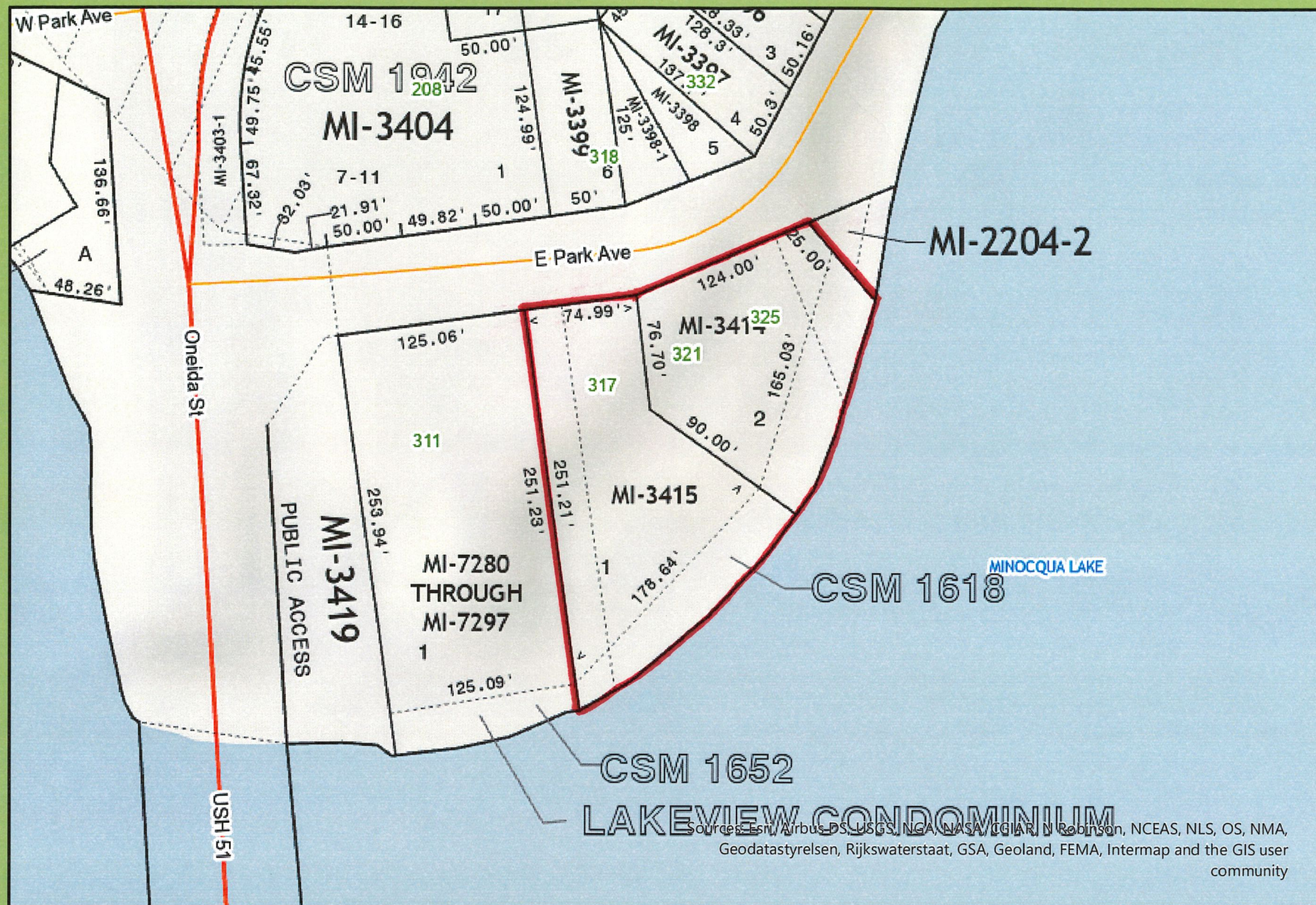

## 317/321/325 Park Ave East Oneida County, Wisconsin

0 0.005 0.01 0.02 0.03 0.04  
mi

This map is courtesy of the Oneida County Land Information office and is a general sketch of areas in Oneida County. It should not be used to represent surveys of property. See original source documents for more information.



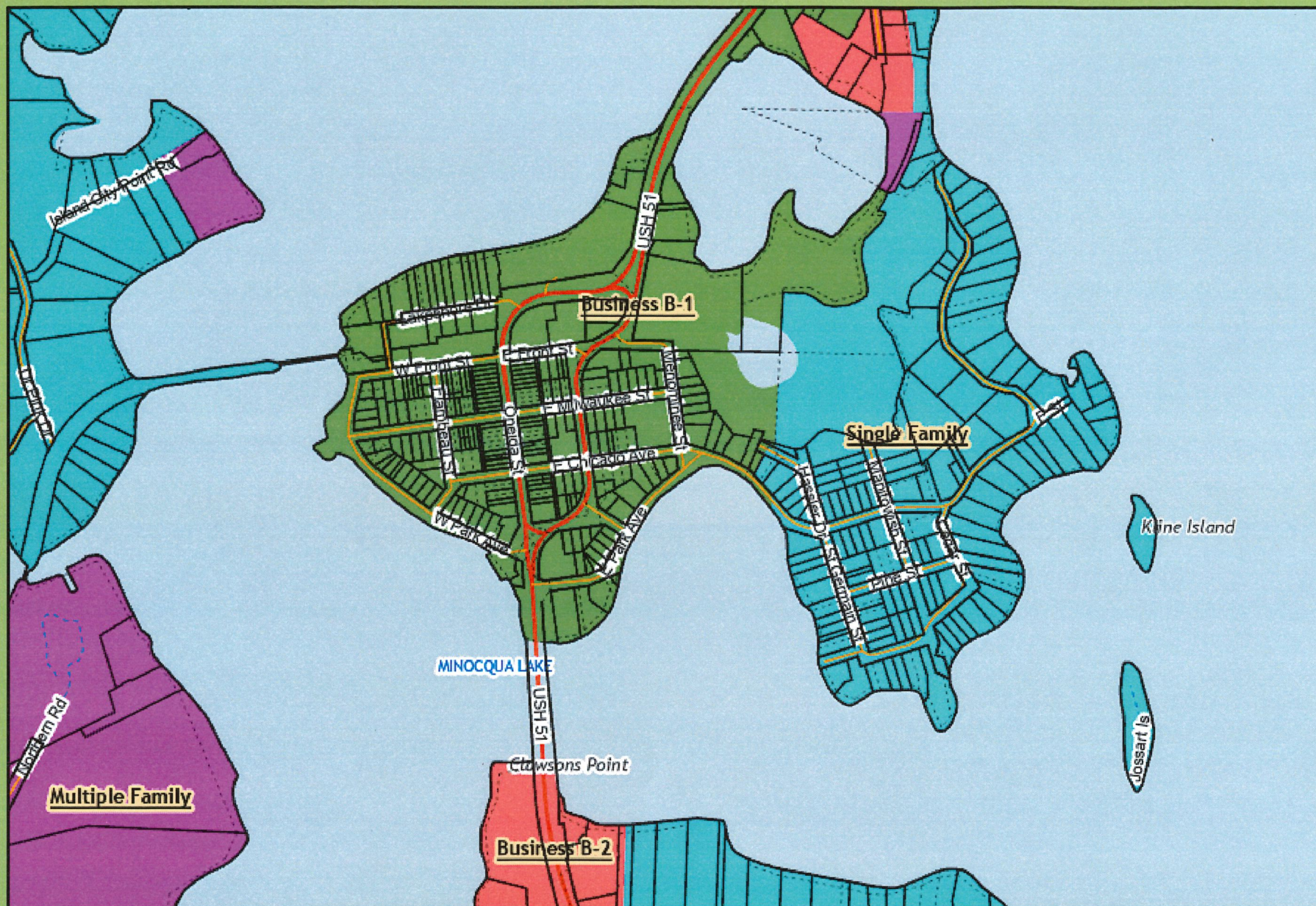

317/321/325 Park Ave East  
Oneida County, Wisconsin

0 0.045 0.09 0.18 0.27 0.36  
mi

This map is courtesy of the Oneida County Land Information office and is a general sketch of areas in Oneida County. It should not be used to represent surveys of property. See original source documents for more information.



## Minocqua Chain Map

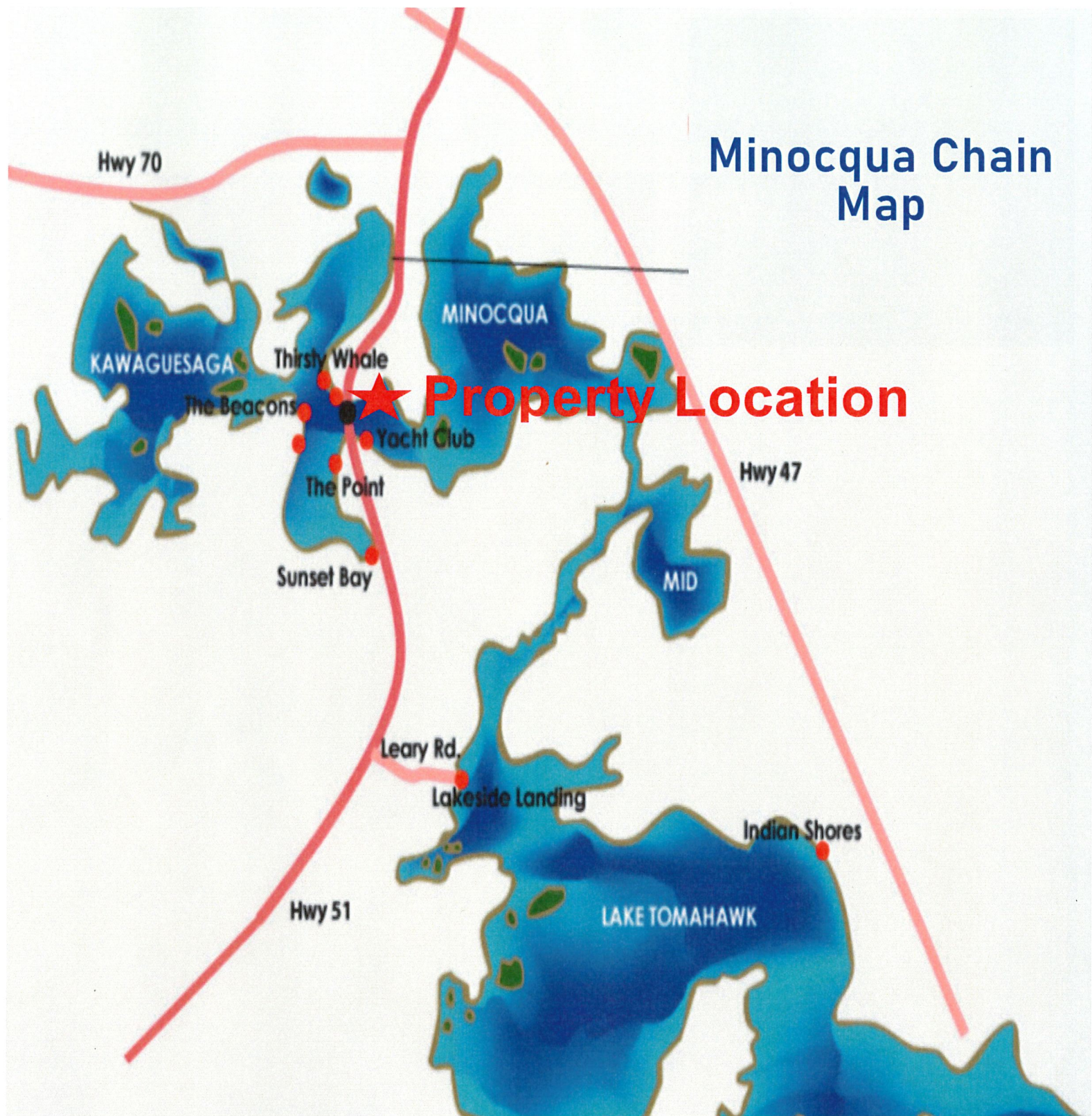



**CERTIFIED SURVEY MAP**

Ave.

Park

NE cor. of Lot 2, Blk. 13,  
Village of Minocqua

(N81°00'E, 75.0')  
N84°51'24"E  
74.99'

(N65°52'E, 124.0')  
N68°43'24"E  
124.00'

V.269 D. p.84  
V.269 D. p.92

All of  
LOTS 1 & 2  
and the East 1/2 of  
LOT 3  
BLOCK 13  
Village of Minocqua  
and other lands  
all in

**GOV'T. LOT 5  
SECTION 14  
T39N, R6E**  
Town of Minocqua  
Oneida County, Wisconsin

-1-  
23,100 s.f.

-2-  
17,300 s.f.

Easement Road

East Line of the  
East 1/2 of Lot 3

Minocqua Lake

Bearings Magnetic

Scale: 1" = 50'

0' 25' 50'

● = axle found  
⊙ = 1" iron pipe set over spike found  
— = 1" iron rod found  
○ = 1" iron pipe set weighing 1.13 lbs./lin. ft.  
( ) = previously recorded

WISCONSIN  
STUART L. FOLTZ  
PROFESSIONAL SURVEYOR NO. 1119  
JUL 19 2023

Inman, Foltz and Assoc., Inc.  
Minocqua, Wisconsin

A parcel of land in Government Lot 5, Section 14, Township 39 North, Range 6 East, Town of Minocqua, Oneida County, Wisconsin, being all of Lots 1 and 2 and the East  $\frac{1}{2}$  of Lot 3 of Block 13 of the recorded plat of the Village of Minocqua and other lands in Government Lot 5, more particularly described as follows:

Beginning at the northeast corner of Lot 2, Block 13 of the recorded plat of the Village of Minocqua; thence N69°43'24"E, 124.00 feet along the south right-of-way line of Park Avenue; thence leaving said right-of-way line S38°21'54"E, 25.00 feet; thence meandering along Minocqua Lake: S19°34'26"W, 165.03 feet; and S45°42'56"W, 178.64 feet; thence leaving the lake N5°19'57"W, 251.21 feet to the south right-of-way line of Park Avenue; thence N84°51'24"E, 74.99 feet along said right-of-way line to the place of beginning.

Including also all lands lying between the lakeshore meander lines and Minocqua Lake, and all riparian rights thereto.

### SURVEYOR'S CERTIFICATE

I, **Stuart L. Foitz, Registered Land Surveyor #S-1170**, hereby certify that we have surveyed the above-described property; that this plat is an accurate survey and a true representation thereof, and correctly shows the exterior boundary lines and the correct measurements thereof; that we have made such survey by the order of **Ardelle Schlecht**, and that we have complied with Chapter 236.34 of the Wisconsin Statutes.

**Oneida County Planning & Zoning Committee has no objection to this**

Certified Survey Date: 11-3-93  
Steven R Osterman  
12557 Administrator

C. Winkler