

Soils Map

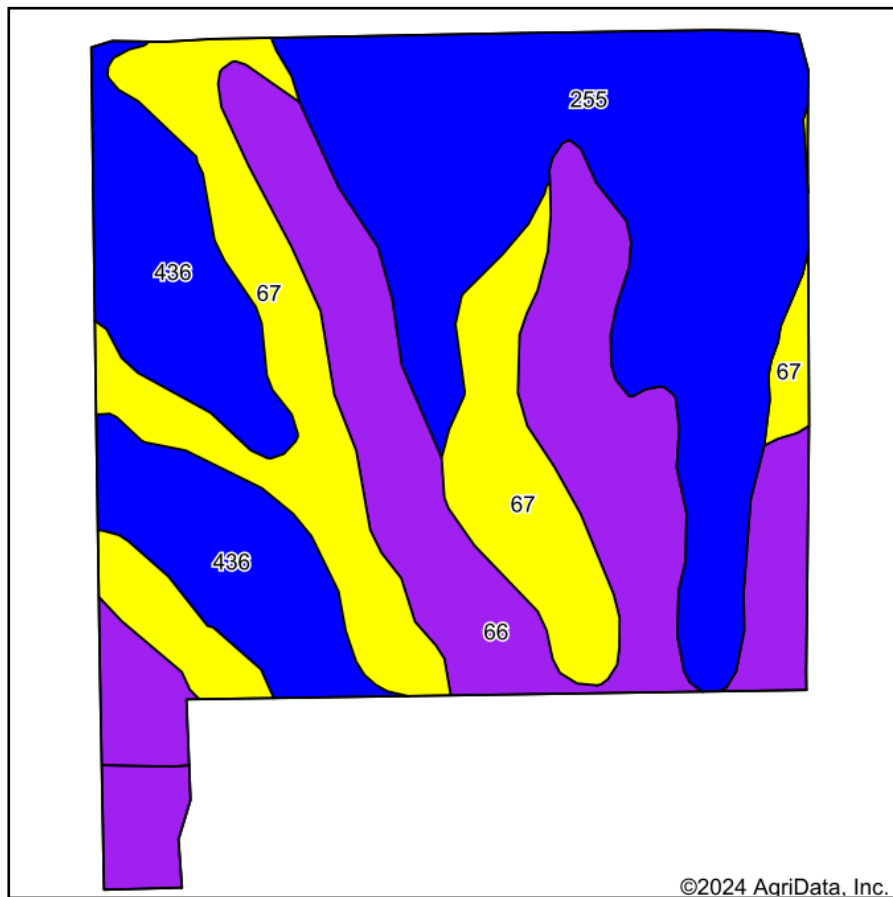

Soils data provided by USDA and NRCS.

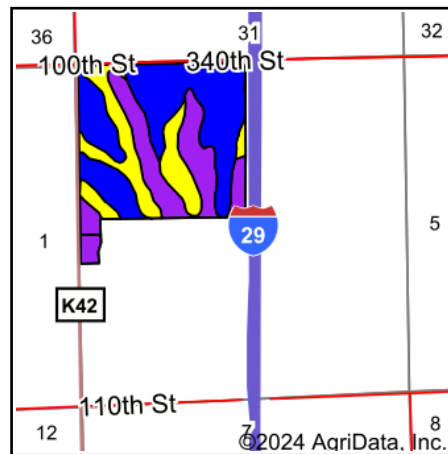

State: **Iowa**
 County: **Monona**
 Location: **6-85N-46W**
 Township: **Lake**
 Acres: **149.86**
 Date: **12/26/2024**



Maps Provided By:



© AgriData, Inc. 2023

www.AgriDataInc.com



Area Symbol: IA133, Soil Area Version: 36

Code	Soil Description	Acres	Percent of field	CSR2 Legend	Non-Irr Class *c	CSR2**	CSR	*n NCCPI Overall	*n NCCPI Corn	*n NCCPI Small Grains	*n NCCPI Soybeans
255	Cooper silty clay loam, 0 to 2 percent slopes, rarely flooded	47.55	31.7%		IIw	85	70	60	60	48	60
66	Luton silty clay, 0 to 2 percent slopes, rarely flooded	43.29	28.9%		IIIw	57	40	50	41	29	50
67	Woodbury silty clay, 0 to 2 percent slopes, rarely flooded	34.56	23.1%		IIIw	70	55	53	50	31	53
436	Lakeport silty clay loam, 0 to 2 percent slopes, rarely flooded	24.46	16.3%		I	88	80	70	67	51	70
Weighted Average					2.36	73.9	59.5	*n 57.1	*n 53.3	*n 39.1	*n 57.1

**IA has updated the CSR values for each county to CSR2.

*n: The aggregation method is "Weighted Average using all components"

*c: Using Capabilities Class Dominant Condition Aggregation Method