

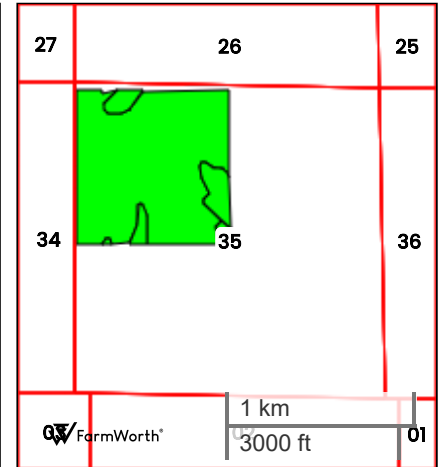

BRAUER/SKOGLUND FARM (160.00 AC TOTAL, 157.32 AC TILLABLE)

TILLABLE SOILS

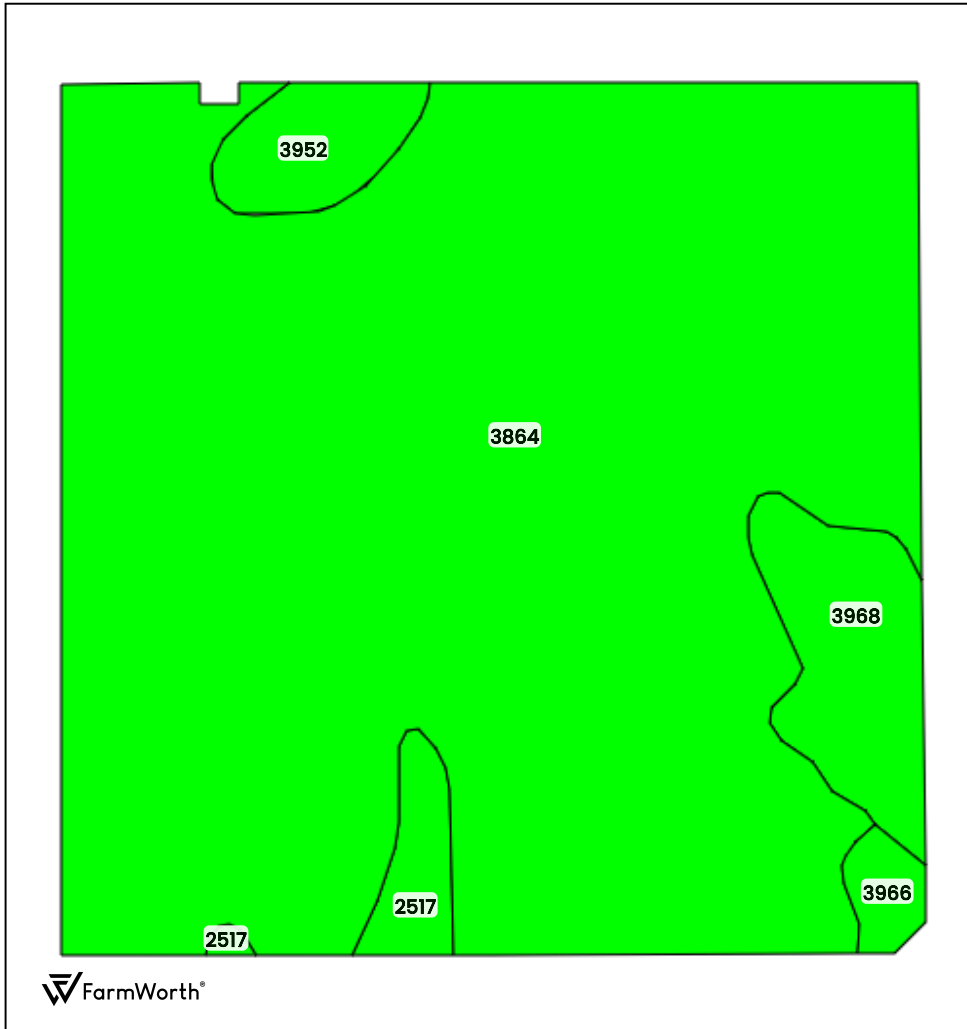

County: **Polk County, NE**
Location: **35-13N-4W**
Township: **West Pleasant Home precinct**
Acres: **157.32**
Date: **01/03/2025**



Field borders obtained from Farm Service Agency
as of 2008

FarmWorth, LLC makes no representations or warranties, express or implied, as to the accuracy of any information, data, numerical values, boundaries, or any other information generated through the use of FarmWorth.com. User is solely responsible for independently investigating and determining all information provided through FarmWorth.com prior to use and waives any and all claims against FarmWorth, LLC for any inaccuracies or inconsistencies in the information and/or data.

Code	Description	Acres	% of field	Overall NCCPI	Soil Class (Irr)	Soil Class (Non-Irr)	Drainage Class
3864	Hastings silt loam, 0 to 1 percent slopes	139.48	88.66 %	68	1	1	Well drained
3968	Hastings soils, 7 to 11 percent slopes, severely eroded	8.70	5.53 %	52	4	4	Well drained
3952	Fillmore silt loam, frequently ponded	4.37	2.78 %	44	4	3	Somewhat poorly drained
2517	Coly soils, 6 to 11 percent slopes, severely eroded	3.13	1.99 %	54	4	4	Well drained
3966	Hastings soils, 3 to 7 percent slopes, severely eroded	1.64	1.04 %	53	3	3	Well drained
Average:				66.0			

Soils data provided by USDA and NRCS.