

# Soils Map

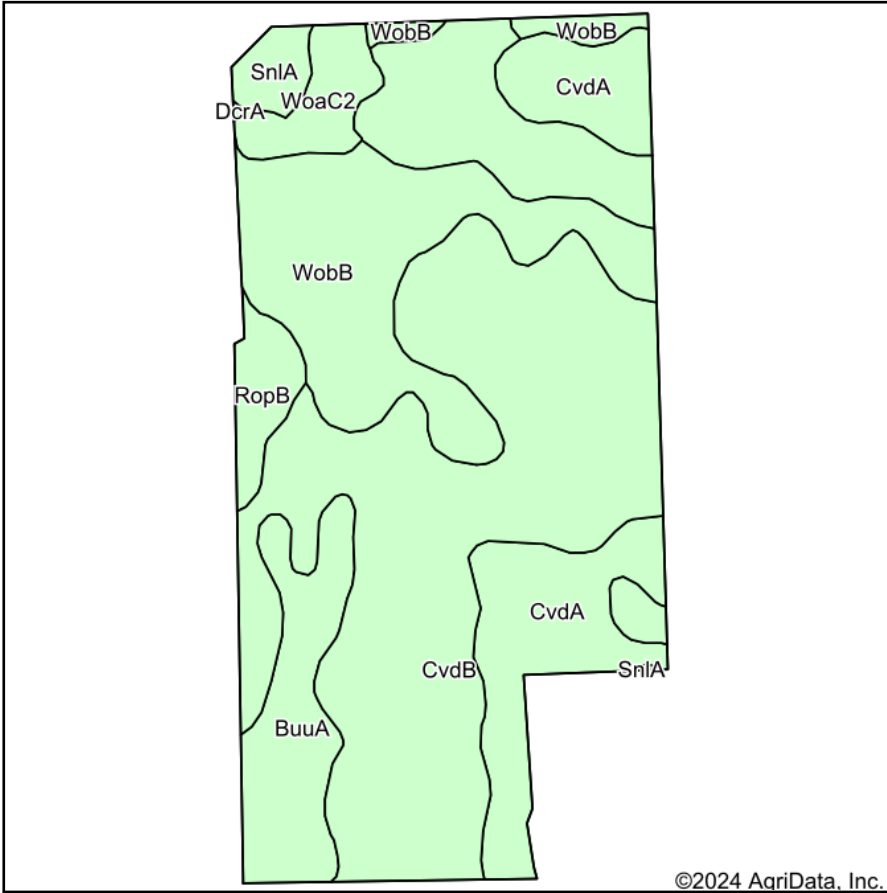

Soils data provided by USDA and NRCS.

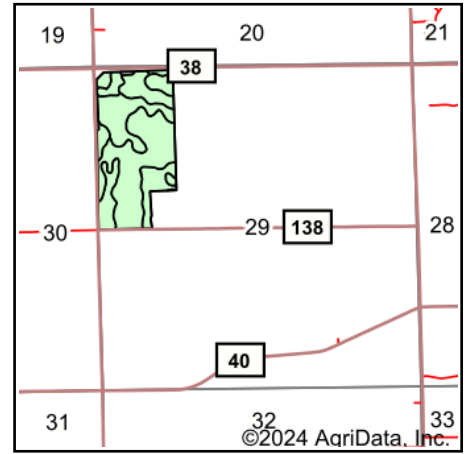

State: **Indiana**  
 County: **Elkhart**  
 Location: **29-36N-6E**  
 Township: **Elkhart**  
 Acres: **69.75**  
 Date: **12/26/2024**



Area Symbol: IN039, Soil Area Version: 27

Code	Soil Description	Acres	Percent of field	Non-Irr Class *c	Corn Bu	Grass legume hay Tons	Pasture AUM	Soybeans Bu	Winter wheat Bu	*n NCCPI Soybeans
CvdB	Crosier loam, 1 to 4 percent slopes	36.14	52.0%	Ile	155	5	10	50	69	57
WobB	Williamstown-Crosier complex, 1 to 5 percent slopes	13.00	18.6%	Ile	147	5	10	50	66	55
CvdA	Crosier loam, 0 to 1 percent slopes	9.59	13.7%	Ilw	154	5	10	50	69	56
BuuA	Brookston loam, 0 to 1 percent slopes	5.73	8.2%	Ilw	172	6	12	49	70	74
WoaC2	Williamstown loam, 5 to 10 percent slopes, eroded	2.26	3.2%	Ille	133	4	9	47	60	49
RopB	Riddles-Oshemo fine sandy loams, 1 to 5 percent slopes	1.84	2.6%	Ile	125	4	8	44	62	55
SnIA	Southwest silt loam, 0 to 1 percent slopes	1.19	1.7%	Ilw	165	5	11	49	66	88
<b>Weighted Average</b>				<b>2.03</b>	<b>153.4</b>	<b>5</b>	<b>10.1</b>	<b>49.6</b>	<b>68</b>	<b>*n 58.1</b>

\*n: The aggregation method is "Weighted Average using all components"

\*c: Using Capabilities Class Dominant Condition Aggregation Method

Soils data provided by USDA and NRCS.