

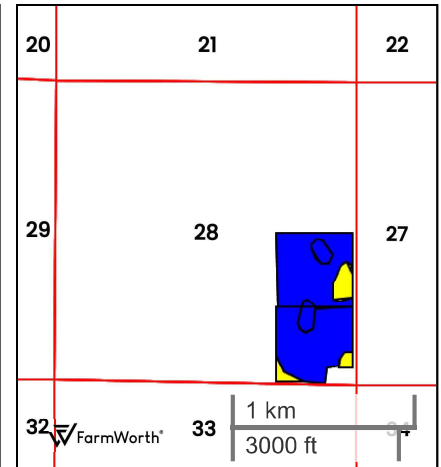

CHARLES MARCUS RICE II REVOCABLE TRUST (77.89 AC TOTAL, 77.36 AC TILLABLE)

## TILLABLE SOILS

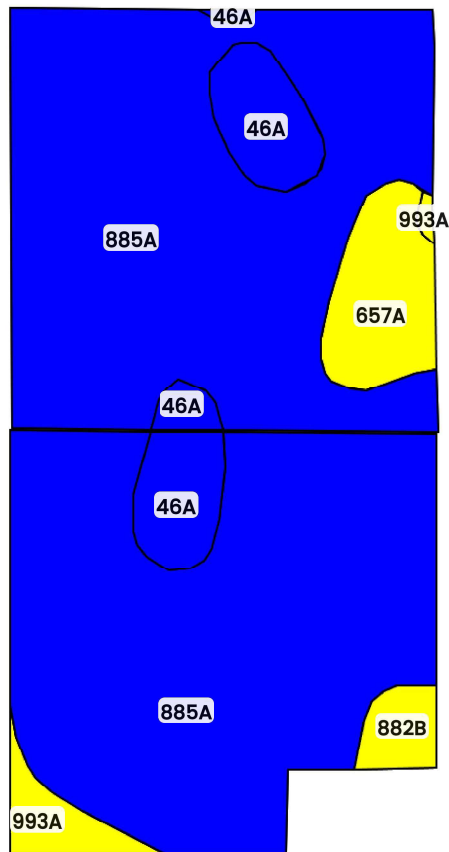

County: **Madison County, IL**

Location: **28-5N-6W**

Township: **Alhambra**

Acres: **77.36**

Date: **12/19/2024**



Field borders obtained from Farm Service Agency  
as of 2008

FarmWorth, LLC makes no representations or warranties, express or implied, as to the accuracy of any information, data, numerical values, boundaries, or any other information generated through the use of FarmWorth.com. User is solely responsible for independently investigating and determining all information provided through FarmWorth.com prior to use and waives any and all claims against FarmWorth, LLC for any inaccuracies or inconsistencies in the information and/or data.

Code	Description	Acres	% of field	IL PI	Overall NCCPI	Soil Class (Irr)	Soil Class (Non-Irr)	Drainage Class
885A	Virden-Fosterburg silt loams, 0 to 2 percent slopes	128.94	166.68 %	135	75	-	2	Poorly drained
46A	Herrick silt loam, 0 to 2 percent slopes	5.79	7.48 %	133	85	-	2	Somewhat poorly drained
657A	Burksville silt loam, 0 to 2 percent slopes	4.08	5.27 %	108	61	-	3	Poorly drained
882B	Oconee-Darmstadt-Coulterville silt loams, 2 to 5 percent slopes	3.90	5.04 %	106	71	-	2	Somewhat poorly drained
993A	Cowden-Piasa silt loams, 0 to 2 percent slopes	3.46	4.47 %	111	73	-	3	Poorly drained
Average:				132.8	74.9			

IL Productivity Index calculations are based on Bulletin 811 and obtained from the [NRCS Field Office Technical Guide](#)  
Soils data provided by USDA and NRCS.